



"Education is the most powerful weapon which you can use to change the world."

-Nelson Mandela

2020-2021

Student Handbook

Most information provided in this planner is when Brixner Junior High students are present on campus. Brixner students will be provide additional material during Comprehensive Distance Learning



Brixner Junior High School 2020-2021

4727 Homedale Road
Klamath Falls, Oregon 97603
Phone: 541-883-5025

Website:

<http://www.kcsd.k12.or.us/SectionIndex.asp?SectionID=12>

Principal - Leslie Garrett
Vice Principal - Tom Loney
Counselor - Charlene Himelwright

Brixner Junior High School Schedules

Comprehensive Distance Learning Schedule (during Hybrid)

Monday & Wednesday

Advisory will start at 8:45am

Advisory	8:45-9:00	15 minutes
Break	9:00-9:15	15 minutes
1st Period	9:20-10:10	50 minutes
Break	10:10-10:25	15 minutes
2nd Period	10:30-11:20	50 minutes
Lunch	11:20-11:55	35 minutes
3rd Period	12:00-12:50	50 minutes
Break	12:50-1:05	15 minutes
4th Period	1:10-2:00	50 minutes
Tutorials/Office Hours	2:10-3:45	1 hour 35 minutes

Brixner Junior High School Schedules

Comprehensive Distance Learning Schedule (during Hybrid)

Tuesday & Thursday

Advisory will start at 8:45am

Advisory	8:45-9:00	15 minutes
Break	9:00-9:15	15 minutes
5th Period	9:20-10:10	50 minutes
Break	10:10-10:25	15 minutes
6th Period	10:30-11:20	50 minutes
Lunch	11:20-11:55	35 minutes
7th Period	12:00-12:50	50 minutes
Break	12:50-1:05	15 minutes
Tutorials/Office Hours	1:10-3:45	2 hour 35 minutes

Brixner Junior High School

Hybrid Bell Schedule

(Monday - Thursday)

Regular Bell Schedule
First Bell 8:25
Tardy Bell 8:30

Advisory	8:30-8:45	15 minutes
1st Period	8:49-9:32	43 minutes
2nd Period	9:36-10:19	43 minutes
3rd Period	10:23-11:06	43 minutes
4th Period	11:10-11:53	43 minutes
Lunch A	11:53-12:23	30 minutes
5th Period A	11:57-12:40	43 minutes
5th Period B	12:27-1:10	43 minutes
Lunch B	12:40-1:10	30 minutes
6th Period	1:14-1:57	43 minutes
7th Period	2:01-2:44	43 minutes
Exploratory/8th Period	2:48-3:20	32 minutes

Dismissal Bell 3:20

No Late Start Bell Schedule for the 2020-21 School Year

Late Start Bell Schedule
First Bell 9:10
Tardy Bell 9:15

Advisory	9:15-9:42	27 minutes
1st Period	9:46-10:26	40 minutes
2nd Period	10:30-11:10	40 minutes
3rd Period	11:14-11:54	40 minutes
4th Period	11:58-12:38	40 minutes
Lunch A	12:38-1:08	30 minutes
5th Period A	12:42-1:22	40 minutes
5th Period B	1:12-1:52	40 minutes
Lunch B	1:22-1:52	30 minutes
6th Period	1:56-2:36	40 minutes
7th Period	2:40-3:20	40 minutes

Dismissal Bell 3:20

BRIXNER JR. HIGH SCHOOL
EMERGENCY EVACUATION MAP

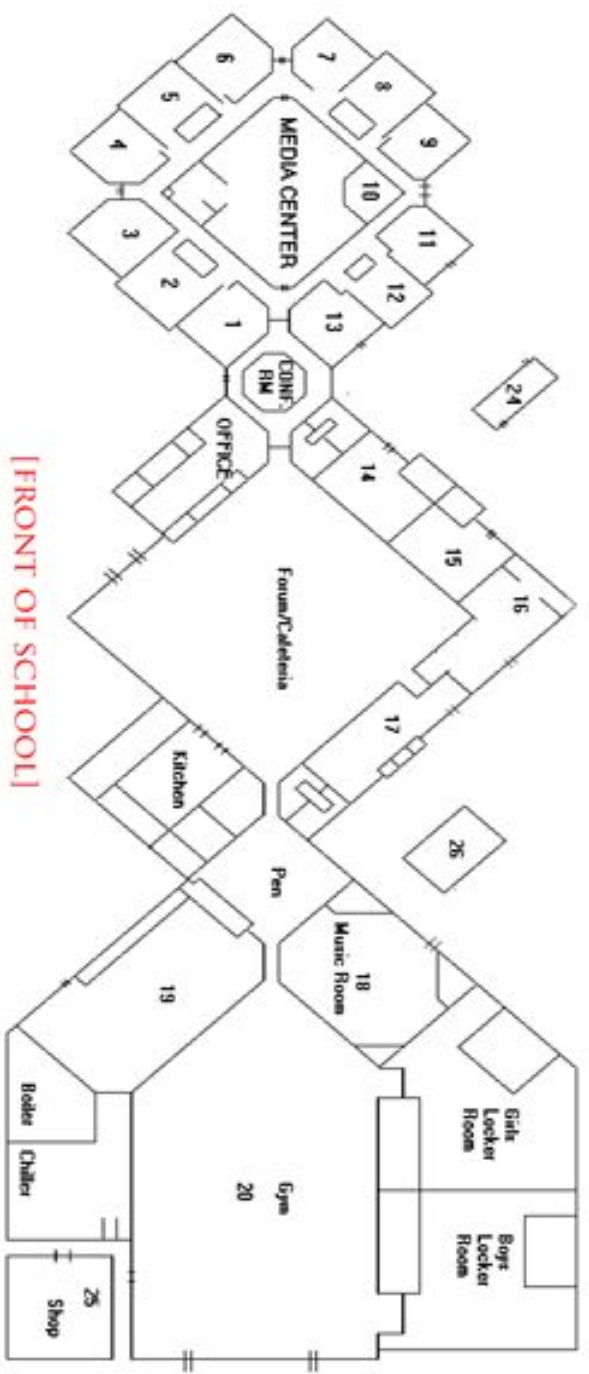

[FRONT OF SCHOOL]

BRIXNER JUNIOR HIGH SCHOOL

“A GREAT PLACE TO GROW”

The staff and administration at Brixner Junior High School, welcome you to our school.

You are fortunate to attend a school with such a professional and dedicated staff. Junior high is a transition time for your physical and emotional growth and a stepping point between elementary school and high school. Our staff is here to assist you during this transition. Please take advantage of their expertise.

Success here depends upon you. In all things, consider yourself a student first. Set goals and work hard. Be to class on time with the materials necessary for learning. Complete assignments at home when needed and learn to organize your time around school.

We hope you make some self discoveries while you are here and enjoy this time in your life. We wish you much success and happiness.

The purpose of the Brixner Student Handbook is to bring together, in one place for reference, the policies and procedures of the school and KCSD. Students and parents are encouraged to study the contents in order to become familiar with all aspects of our school. Knowing the contents of the handbook should enable everyone to follow Brixner’s policies. In the event procedures, rules, or events change, updated information will be included in the principal’s monthly newsletter.

It is the policy of Brixner Jr. High School, Klamath County School District and the State Board of Education that there will be no discrimination or harassment on Klamath County School District grounds on the basis of race, color, sex, marital status, religion, national origin, age or handicap in any education programs, activity, or employment. Refer to the Klamath County School District “*Student Rights and Responsibilities*” handbook for the complete policy statement.

About Brixner Jr. High

Part of the Klamath County School District, 2845 Greensprings Drive, Klamath Falls, Oregon 97601, Brixner Jr. High is located at 4727 Homedale Road, Klamath Falls, Oregon 97603. Brixner opened its doors in 1973. Brixner’s feeder schools include Ferguson, Peterson, Shasta and Stearns elementary.

Education/Curriculum

Brixner Jr. High coordinates with the Klamath County School district curriculum department to insure Brixner implements state requirements. The state mandates the standards and provides guidelines for content instruction. This allows the district and Brixner Jr. High to stay at the forefront of curriculum and instructional development. Brixner's instructional strategies are constantly being updated through staff development training and in-service.

At Brixner Junior High School your student will have every opportunity to succeed academically and also grow in character. All students at Brixner take the Smarter Balanced State Test in English Language Arts, Science and Math. Our students' test scores in science, math, and reading are among the highest in the Klamath Falls area and consistently score above the state average on statewide assessments. Our student attendance rate is above 92% indicating our students come to school regularly which increases their success rate in classes. We have three computer labs and four computer carts with 35 Chrome notebooks on each cart. Educational instruction at Brixner includes the use of technology on a regular basis. Brixner offers a well-rounded education to our students through our exploratory program. Teachers develop courses and curricula showcasing their own talents, skills, and interests offering courses in archery, communications, outdoor skills, horticulture, Spanish (and other languages), volleyball, basketball, robotics and more.

Our school is committed to the principles of Positive Behavior Intervention Support. We promote RESPECT, RESPONSIBILITY, SAFETY and TOLERANCE in all areas of the school. These are the character traits that make our students great people and our school a safe and fun learning environment. Brixner students are rewarded throughout the year for demonstrating these character traits.

Brixner staff is committed to preparing our students for high school through academics and personal responsibility.

Typical Student Schedule

Advisory

Pre-Algebra

English

Science

Social Studies

P.E. (Full year)

Keyboarding/Health

Choir/Band/Strings/Athletic Skills/Robotics (elective), Project Lead the Way

Exploratory

Adult supervision will occur between the hours of 7:45 a.m. to 3:45 p.m. and at school sponsored events. Parents will assume supervision responsibilities at all other times.

Administrative Staff

Principal: Leslie Garrett

Vice Principal: Tom Loney

Counselor:

Ms. Charlene Himelwright

Secretaries: Mrs. Jennifer Haney

Mrs. Carla Thompson

Teaching Staff

Mr. Baeth - Special Education

Mr. Barleen – Health/Athletic Skill

Mr. Conner - P.E./Health

Mrs. Contreras - Science

Ms. Daly – ELL

Mrs. Eddy – GOALS

Mr. Eubanks – Science

Mr. Hankanson - Orchestra

Ms. Hill - Math

Mr. Izzett – Band

Mrs. Masters – English Language Arts

Mrs. Mathis – Social Studies

Mrs. McPherson - Science

Mrs. Morgan – English Language Art

Mr. Pasche – Health

Mrs. Roberts – English Language Arts

Mrs. Robertson - Choir
Mr. Rogers – Computers
Mrs. Spencer - Social Studies
Ms. Thede - Special Education
Mr. Trumbull - Math
Mr. Von Tersch – Social Studies

Paraprofessionals

Mrs. Bobo
Mrs. McCambridge
Mrs. Newnham
Mrs. Miller
Ms. Perez
Mrs. Stickel

Custodians Mr. Pine - Head Custodian Mrs. Gillette Mrs. Cerillo-Gomez

Cafeteria Kim Scott – Head Cook Mrs. Frey Mrs. Morrow

School Colors: Black & Red **School Mascot:** Grizzly Bear

Student Body Officers: President – TBA Vice President – TBA

School Website: <http://www.kcsd.k12.or.us/SectionIndex.asp?SectionID=12>

SCHOOL PROCEDURES AND ROUTINES

Beginning Class: The students are expected to:

- Be in the room when the tardy bell rings
- Write assignments in student planner
- Follow classroom routines and behavior expectations

Tardy to Class: The students are expected to:

- Get a pass from the library
- Enter the room quietly and sit down

Absent from Class: The students are expected to:

- Check Schoology for assignments missed
- Write missed assignments in student planner
- Ask for the teacher's explanation of assignment if necessary
- Turn make-up work in on time (one day extra for each day missed)

Ending Class: The students are expected to:

- Remain seated, quiet and orderly at the conclusion of the class period
- Students are dismissed by the teacher
- Refrain from gathering near the doorways

Hallway Passing: The students are expected to:

- Walk at all times - to classes, cafeteria, and buses
- Keep to the right in halls and doorways
- Refrain from loitering in the halls and restrooms
- Use inside voices at all times

Respect Others: The students are expected to:

- Keep hands and feet to themselves
- Speak positively about others
- Stay in groups of five or less
- Report peer conflicts to the office staff

Evacuation Drills: The students are expected to:

- Follow their teachers' instructions
- Move safely and quietly to exits
- Form single file lines when reaching safety zone
- Walk back to building when cleared

Registration

Parents or guardians are to register their students or update previous year's registration on-line or in person by coming to the school office. Student Body Fees should be paid at this time.

Personally Identifiable Information

Please see the Klamath County School District's "Student Rights and Responsibilities" handbook for the complete policy statement.

Directory Information

Please see the Klamath County School District's "Student Rights and Responsibilities" handbook for the complete policy statement.

Fees

Required student body fees of \$25.00 must be paid by all students. This fee includes locker use, P.E. locks, activities, assemblies and student body fees. A Student Body Card will be issued when the fees are paid. This fee does not include the yearbook or P.E uniform. The yearbook fee is \$25.00. P.E. uniform is \$20.00. Students must have all fees paid in order to attend school activities (dances, celebrations, etc.) and participate in athletics.

Closed Campus

Upon arrival to school in the morning all students shall enter the building and remain at the school from their arrival time in the morning until dismissal at the end of the day. Students must be signed out by their parents/guardians when leaving the school. Leaving the school grounds without permission will result in disciplinary action.

Attendance: Philosophy, Absences, Make Up Work, Truancy and Tardies**Attendance Philosophy**

In all Klamath County Schools, regular attendance in all classes (including Advisory) is expected. Irregular attendance by students will cause the student to miss valuable class discussions, lectures, demonstrations, etc. This will ultimately cause the learning process to

suffer. Lack of attendance will affect grades. Make-up work cannot be a proper substitute for actual classroom discussion and instruction.

School attendance is the responsibility of the students, parents, and the school. The responsibility of the student is to inform their parents they are sick, get all classwork they miss from Schoology, complete all assignments on time and turn assignments in to their teachers. The responsibility of the parent is to follow KCSD policies when keeping their child home, inform the school by 10:00 a.m. that their child is staying home, provide a reason for the absence, and make sure their child completes all assignments they miss while absent. The responsibility of the school is to provide assignment information in Schoology, and to inform parents of the absences. Attendance letters listing totals for five or nine-day absences will routinely be mailed to parents. Excessive absences may result in disciplinary action and a possible citation to the student and/or parent.

Absences

School Administration will determine if an absence is excused or unexcused based on KCSD policy. When sickness or emergencies require an absence, the absence must be phoned in to the school by a parent/guardian no later than 10:00 a.m. After 3 consecutive days or frequent absences a Dr.'s note may be required. Please see the Klamath County School District "Student Rights and Responsibilities" handbook for the complete policy statement

Make-Up Work

Make-up work will be allowed and is required for any absence - illness, family emergency, trip out of town.... It is the student's responsibility to get missed assignments and turn in make-up work on time. Advanced make-up work may be requested in advance for extended absences. Class work can be requested on the second day of an absence by calling the office. Work or tests assigned prior to the absence are due when the student returns to school.

Suspension/Make-up Work

Students will be allowed to make up and will receive credit for daily assignments, laboratory experiments, class discussions or presentations, quizzes, unit examinations, mid-term and final examinations without an academic penalty.

Assignments provided for the student before or during the suspension period shall be due on the date that the student returns to school from the suspension.

Students will be granted the number of days equal to the suspension period to have completed and submitted all other make-up work to the appropriate teachers for grading.

Truancy

A student who is absent from school or from any class without permission will be considered truant and will be subject to disciplinary action including detention, suspension, and/or expulsion. Please see the Klamath County School District's "Student Rights and Responsibilities" handbook for the complete policy statement.

Unexcused Tardies

1. Students are assigned lunch detentions for the first three unexcused tardies.
2. The fourth and fifth tardies will result in the student being assigned to serve a 30 minute supervised detention after school. Parents/guardians will be notified by mail/phone.
3. The sixth unexcused tardy results in a referral and a Wednesday school will be assigned. Parents can excuse up to three tardies to school per semester. After three tardies to school, the above consequences will take effect. Chronic tardiness will result in increased disciplinary consequences set by the school administration.

Checkout Procedures

Parents/Guardians must come to the office to pick up students and sign them out. Also, if a student is to go home by a means other than what is ordinary for that student, a note with instructions must be taken to the office and be initialed by the principal or assistant principal.

Books, Equipment and Computers

Textbooks and library books are checked out of the Library at the beginning of the school year and throughout the year. Students will be charged for lost or damaged books or equipment. The use of computers is a privilege, not a right. Any attempt to tamper with the computers, programs, settings, networks, printers, or any other associated equipment will result in the loss of privileges and/or discipline.

Visitors

The Principal will approve requests to visit as appropriate. Parents are welcome and are encouraged to visit school. Student visitors are not allowed during school hours. For security reasons, all visitors are required to check in at the office when entering the building to pick up a visitor's badge which they must wear while in the building.

Lockers

Each student will be issued a locker. It is very important that each student keeps the combination of his/her locker confidential for personal security. Students are to keep the locker issued to

them at the beginning of the year. **Sharing lockers is not allowed.** Students who violate locker rules may lose their lockers. All personal items should be marked for identification. The school will not accept responsibility for items that are damaged or taken from lockers. Lockers will be inspected from time to time and are to be kept neat, clean and in good working order. A \$5.00 fee will be charged to change a locker combination.

Counseling

Brixner Junior High School's counselor implements the Klamath County School District's guidance and counseling program by promoting student achievement, helping students to understand themselves and their relationships with others, and helping students acquire the ability to make decisions that contribute to productive and enriched living.

At Brixner, the counselor serves as a link between students, staff, parents/guardians, and other community agencies and is available to consult with students, parents, and staff throughout the school year. The counselor can be contacted during school hours.

Adding/Dropping Courses

It is the building principal's decision as when to allow students to change classes. Parents will be notified of all drops and additions.

Excuse from a Particular Curriculum or Program

It is the right of parents/guardians to excuse their children from any curriculum, state required program, or learning activity they find to be objectionable for religious or moral reasons. Students may also be excused because of handicapping conditions. The building principal will authorize this exclusion upon written request of the parents. Students will not be responsible for any of the material taught during the unit from which they are excused. The teacher may choose to assign the student work on a different topic in lieu of the one being taught in class. Such an alternative assignment shall not exceed the regular class work in difficulty or time required to complete it.

Academic Progress

Parents will be notified of student progress with a progress report every six weeks and/or by e-school. Following a six weeks grading period in October and March, conferences will be scheduled to discuss individual progress. These dates and times will be published in the school newsletter and notices will be mailed.

Grading

Punctual and regular attendance is essential to the academic success of students. At the beginning of each school year or course, teachers will inform students and parents/guardians how attendance and class participation are related to the instructional goals of the subject or course.

Promotion, Retention and Placement of Students

A student shall be promoted from one grade to the next on the basis of academic, social, physical, and emotional development. Exceptions may be made when, in the judgment of the professional staff and the students parents/guardians, such exceptions are in the best educational interest of the student involved.

Effective Behavior and Instructional Support Team

Brixner Junior High School has an EBIS Team. The purpose of the EBIS team is to:

1. Function as a pre-referral team for education and behavior concerns and to identify and help at-risk students.
2. Assist teachers in designing interventions for at-risk students.
3. Be a resource center for drug and behavioral counseling interventions.
4. Facilitate the 504 modifications and classroom adjustments as required by law.
5. Help students and teachers with school and social problems that have not been resolved.
6. Identify talented and gifted (T.A.G.) students.
7. Develop FAIR plans as needed for interventions.
8. Identify students for referral to Special Education.

Cafeteria

School breakfasts and lunches are served in our cafeteria at no cost. Past-due lunch accounts are handled in the school office. Students are to act in an appropriate manner during lunch and to clean up after themselves when finished eating. To show respect for others, please walk, line up in a single file, do not push, take “cuts”, or save places. Use the red marks as a guide for each line. Students are to go outside after eating. While students are outside they must stay in designated areas. No food or drinks are allowed outside. Unhealthy drinks (Monster drinks, soda-pop, coffee/lattes/frappacinos...) are not allowed. All drinks must have a screw-on lid to be stored in lockers and students cannot bring drinks to school for other students.

The Pen area restrooms are open during lunchtime.

Lunch/Breakfast Program

The school participates in the National School Lunch and School Breakfast and Federal Commodity Programs and offers free meals to all students. Additional information can be obtained in the school office.

School Pictures

Picture payment is to be made at the time the photographs are taken. All pictures taken carry a guarantee, from the picture company if they are not to your satisfaction. Do not send any money until the day pictures are taken.

Assemblies

Students are to follow school wide behavior expectations - go directly to the gym and sit with their Advisory teacher. Students who do not act properly will not be allowed to attend future assemblies.

Discipline

Disciplinary consequences are determined by the nature of the discipline referral and the student's disciplinary record.

Detention

Detention is assigned as a disciplinary consequence for a student's violation of the Student Code of Conduct expectations and is from 3:20-3:45. Students may also attend during this teacher supervised time to receive homework help or to complete classwork. The detention shall not begin, however, until the student's parents have been notified of the reason for the detention and can make arrangements for the student's transportation on the day(s) of the detention.

Suspension

A student may be suspended from school for up to and including ten (10) calendar days for willful violations of the Student Code of Conduct.

An opportunity for the student to present his/her view of the alleged misconduct will be given. Each suspension will include a specification of the reasons for the suspension, the length of the suspension, a plan for readmission and an opportunity to appeal the decision. A suspension may not exceed ten (10) calendar days. Every reasonable effort will be made to notify the parents of a suspended student. While under suspension, a student may not attend after school activities and athletic events, be present on district property nor participate in activities directed or sponsored by the district.

Whether a school suspension is in-school or out-of-school, it is a severe disciplinary consequence used in cases of extreme misbehavior or repeated violation of school rules or policies. Several suspensions may lead to a recommendation for expulsion. Please see the Klamath County School District's "Student Rights and Responsibilities" handbook for the complete policy statement.

Wednesday School

Wednesday School runs from 3:20 p.m. to 5:00 p.m. and is designed as an alternative to suspension from school. Students are required to bring enough schoolwork and reading materials to last for the whole duration of structured study time. Failure to report on time, attend the entire time, and follow detention rules may result in suspension. Students may also attend Wednesday school for academic help from the supervising teacher.

Expulsion

Expulsion is defined as release of a student from school attendance for no longer than one (1) calendar year. Please see the Klamath County School District's "Student Rights and Responsibilities" handbook for the complete policy statement.

Student Conduct

Educating socially acceptable and responsible citizens is very important to the administration and staff at Brixner Jr. High School. Students are responsible for conducting themselves in a respectful, responsible, safe and tolerant manner. Harassment of any type, including electronic, will result in disciplinary actions. Obscenity or profanity, (written, verbal, or gestures) is not allowed. Students should show respect for themselves and others by using language appropriate to a polite and civil society.

Drugs and Alcohol

Drugs

A student shall not possess, use, transmit, or be under the influence of any illegal drug. Nor shall the student have in his or her possession any device, container, or apparatus associated with the use of the above items on the school grounds or at any school sponsored activity. Violation of this policy will result in suspension, law enforcement informed (possible citation), and may result in expulsion. Please see the Klamath County School District's "Student Rights and Responsibilities" handbook for the complete policy statement.

Alcohol

A student shall not possess, use, transmit, or be under the influence of any alcoholic beverage or intoxicant of any kind. Nor shall the student have in his or her possession any device, container, or apparatus associated with the use of the above items on the school grounds or at any school sponsored activity. Violation of the alcohol policy will result in immediate suspension, law enforcement informed (possible citation), and may result in expulsion. Please see the Klamath County School District's "Student Rights and Responsibilities" handbook for the complete policy statement.

Tobacco Free Environment

Tobacco use on school district property is prohibited.

Possession and/or use of tobacco, tobacco products, tobacco look-alike products and/or nicotine products at school by students are prohibited by state law. Possession of tobacco will result in suspension, law enforcement informed (possible citation) and a parent conference. Further tobacco violations will result in additional citations, referral to counseling, suspension, and/or expulsion. Please see the Klamath County School District's "Student Rights and Responsibilities" handbook for the complete policy statement.

Harassment

All students have the right to learn in an environment that is free from harassment, including sexual harassment, intimidation and bullying.

Harassment, intimidation or bullying means:

- Any intentionally written message or image (including those that are electronically transmitted) or verbal or physical act, including but not limited to one shown to be motivated by race, color, religion, creed, ancestry, national origin, sex, gender, sexual orientation, including gender expression or identity, marital status, age, mental or physical disability or other distinguishing characteristics.
- When an act physically harms a student or damages the student's property,
- Has the effect of substantially interfering with a student's education,
- Is so severe, persistent or pervasive that it creates an intimidating or threatening educational environment,
- And / or has the effect of substantially disrupting the orderly operation of the school.

The following consequences will be given, but may be modified as necessary:

First violation: written and verbal warning. The student will sign a report and parents will be contacted (other consequences possible).

Second violation: assigned Wednesday School and parent contacted. Law enforcement notified.

Third violation: assigned In-school Suspension with a parent conference and issued a Cease and Desist Order. Law enforcement notified.

Fourth violation: assigned Out-of School Suspension with parent conference, law enforcement notified and further consequences defined.

Further violations: implement further consequences including expulsion from school.

Physical Contact

Public displays of affection may be disruptive to the learning process. Students are to keep their hands, feet and all objects to themselves. People have their own private space and others should respect that area. This means kissing, inappropriate hugging, holding hands, walking arm in arm or arm around the waist or touching in inappropriate places (any area that would be covered by a traditional swimsuit) will not be allowed. Other actions prohibited, but not limited to, include pushing, kicking, biting, shoving, spitting and pinching.

Fighting

There is zero tolerance for fighting. Any form of fighting can result in expulsion from school and law enforcement notified. The consequences for inciting, promotion, or taking pictures of a fight could be suspension or expulsion and citation from law enforcement. Students and parents are expected to seek help and advice from school personnel to resolve peer conflicts. Please see the Klamath County School District's "Student Rights and Responsibilities" handbook for the complete policy statement.

Weapons

Students and parents/guardians are to report to school staff any threats of violence, possession or use of weapons, or activity which may harm or be unsafe to anyone.

Students shall not bring, possess, conceal, or use a weapon or replica of a weapon (including a pocket-knife) or other possessions reasonably determined by the school to be a threat to the safety or security of those on school property or at an activity sponsored by the school or by a voluntary organization approved by the State Board of Education.

Any student who knows of other student(s) who bring, possess, conceal, or use a weapon or other possession determined to be a threat to school safety may be subject to disciplinary action. Weapons, including replicas of weapons and pocket-knives are subject to seizure or forfeiture. Any student who violates these regulations will be subject to expulsion and referral to law enforcement officials. Please see the Klamath County School District's "Student Rights and Responsibilities" handbook for the complete policy statement.

Bicycles/Skateboards/Scooters

State law requires students under the age of 16 to wear approved helmets. Students are encouraged to lock bikes and skateboards in the rack upon arrival to school. Bikes/Skateboards are not to be ridden on school grounds and students are not to go into the rack area during the school day. Bikes/Skateboards may not be ridden again until time to go home.

Telephone Use

The office phones may be used with staff permission. Students are to make arrangements with parents in advance for any activity that requires parent permission or a change in transportation.

Cellular phones

Student cell phones that are brought to school must be turned off and put in lockers during the school day. They may only be used after school or in the office with permission from administration.

Violations of this rule will result in:

- First offense: phone confiscated and given to administration. Phone may be picked up at the end of the day by student.
- Second offense: phone confiscated and given to administration. Parents/guardians will be notified by phone and student can pick up phone at the end of the day.
- Third offense: phone confiscated and given to administration. Formal referral and consequences assigned. Parent/guardian required to pick up cell phone in the office and conference with administration.
- Continued violations will result in more severe consequences.

Nuisance Items

Electronic devices, squirting devices, laser pens or devices, pagers, toys, spinners, speakers, etc. are not to be brought to school. Students bringing the above mentioned items to school will have them confiscated and will be subject to disciplinary action.

Prohibited Use

Irresponsible skateboarding, roller blading and bike riding have caused serious and expensive damage to school property. Due to the possibility of injury and cost of repairs, roller blades, and roller shoes, are NOT to be brought onto Brixner grounds. Bikes/Skateboards/Scooters ridden to school are to be put into the racks and left there all day. They are not to be used except to and from school.

Food

Water bottles are the **ONLY DRINK** allowed in classroom areas with teacher permission. Food is not allowed in the classroom unless approved by the teacher/administration. Students are not allowed to bring outside food or drinks besides their school lunch and/or a water bottle to school for any reason.

Chewing Gum

Due to damage and expensive repairs caused by students who have been irresponsible with gum in the past, it is left up to individual teachers to decide if students may chew gum in their classrooms. Gum may be chewed before and after school and during lunch.

Physical Education

Physical Education Uniform

Brixner students are required to wear the Brixner P.E. uniform. The uniforms are purchased in the office. Failure to dress down in P.E. will result in loss of daily points and possible disciplinary action.

Physical Education Excuses

A student who cannot participate in physical activities due to health problems must have a written note from home. This note will be good only for the day written. Excuses for illness requiring the student to miss three or more days in a semester must come from a doctor or Brixner's school nurse. When a student returns from major surgery, illness or injury, there must be a physician's release prior to participation.

Safety

P.E. instructors may ask that jewelry or piercings be removed or taped over. Refusal to remove jewelry or piercings may result in disciplinary action and/or reduction in grade.

Transportation of Students

A student being transported by district provided transportation is required to comply with the Student Code of Conduct. Any student who fails to comply may be denied transportation services and shall be subject to disciplinary action. Please see the Klamath County School District's "Student Rights and Responsibilities" handbook for the complete policy statement.

To and From School

Students who are not involved in after school activities are to leave the school grounds immediately after school and go directly home. While legally the school has jurisdiction, it is a difficult situation to supervise. Only close cooperation and clear understanding between home and school can help minimize the problems that can happen between students before and after school.

Dress and Grooming

The responsibility for the dress of students rests with the parent, the student, and the school. Any student who wears clothes at school that could cause a safety hazard, be a disruption to the learning environment, or violates Brixner's dress code, will be asked to change clothes. Drawing or painting on face, hands, arms, clothes, etc. is a disruption and will not be permitted.

Lewd and suggestive statements on clothing, metal spikes, metal chains, tank tops, bare midriffs, and clothing that allows undergarments to be seen is not permitted. The length of skirts, shorts and holes in pants must extend beyond the fingertips of the relaxed arms extended at the student's side. Sleeveless shirts must be at least four inches in width. Any items with logos advertising tobacco, drugs, alcohol, gang affiliations, or subjects deemed inappropriate are prohibited. Student dress should be appropriate for the weather. Hats and other head wear, heavy coats and bags are to be kept in the students' lockers during school, though light jackets will be allowed. Bandanas are not allowed at school at any time. Please see the Klamath County School District's "Student Rights and Responsibilities" handbook for the complete policy statement.

Health Service

School health services are provided by registered nurses in Klamath County School District to support students with complex, chronic health needs; to support health education for students and staff; and to provide school health services that comply with national, state and local mandates. The KCSD nurses believe that each student's health has a direct effect on his/her educational achievement and that healthy students are better learners.

If your student has health needs which may require nursing services, please contact your school principal, or the KCSD Health Services at 541-851-8740.

Insurance

At the beginning of the school year each school will send a flyer home with students, that is a low cost, private, student accident insurance program for grades K-12. Parents are responsible for paying premiums if coverage is desired. The district shall not be responsible for costs of treating injuries or assume liability for any other costs associated with an injury. Before

participating in a school sponsored trip outside the district or in school sponsored athletics, students and parents must show evidence that the student is covered by some form of accident insurance.

This insurance does not apply to out-of-school activities unless insurance is purchased as a full-time plan.

Emergency Drills Fire and Earthquake

Brixner Junior High School conducts monthly emergency practice drills for fire, earthquake, lock-downs, lock outs and building evacuations. These procedures will be explained to all students. A map/diagram of the escape route to be followed is posted near all classroom doorways and reviewed with students. When a drill is enacted, students must follow the direction of staff quickly, quietly and in an orderly fashion moving to a safe area as directed by staff and administration.

Illness or Injury Occurring at School

At times a student may have signs or symptoms of illness and need to be excluded from school until diagnosed and treated by a licensed health care provider or until recovered.

Conditions that may require exclusion until either diagnosed or recovered include:

- Fever greater than 100.5

- Vomiting

- Rash with or without fever - new or sudden onset

- Diarrhea (3 watery or loose stools in one day) with or without fever

- Weepy (fluid or pus-filled) skin lesions

- Deep, barking cough and/or production of colored mucus

- Irritated eyes that are tearing, sensitive to light, with puffy lids and colored drainage

- Symptoms or complaints that prevent the student from participating in his/her usual school activities, such as persistent cough, with or without presence of fever

- Student requires more care that the school staff can safely provide.

Only a licensed health care provider can determine a diagnosis and/or prescribe treatment and provide instructions regarding the student's return to school.

If the student becomes too ill to remain at school, or has an injury requiring medical evaluation the student will be released to the student's parents/guardians or to another person as directed by parents/guardians on the student's emergency form. School staff will administer emergency or minor first aid as necessary. The school will contact emergency medical personnel, if needed,

and will attempt to notify the student's parents whenever a student has been transported for treatment.

Emergency School Closures

In the event that bad weather or some other unforeseen circumstance causes school closure or a delayed opening, the radio stations listed will begin announcing this information at approximately 6:00 a.m. or as soon as a decision is reached. Klamath County School District and Brixner will also notify families using One Call Now phone calls and/or text messages. Schools will be open unless closure or a delayed opening is announced by the district. Please do not call your school, the Klamath County School District office, or the district bus shop. Those lines must remain clear for other calls related to the closure or delayed opening.

The following radio and television stations will carry the information:

Radio:	KAGO	KFLS/KKRB	KLAD
AM Radio	1150	1450	960
FM Radio	99.5	106.9	92.5
Television:	KOTI	KDKF	KTVL
Antenna	Channel 2	Channel 31	Channel 10
Cable	Channel 2	Channel 13	Channel 4

PLEASE DO NOT TELEPHONE THE STATIONS.

Frequent announcements will be made. School closure results in automatic cancellation of the school activities program unless information to the contrary is specifically released. Be sure your child knows where to go if an emergency is declared and schools are closed early. Most parents have made arrangements with a friend or neighbor who lives within walking distance of their home to take care of their children in the event school must be closed early.

Awards and Honors

The Brixner staff recognizes exceptional student achievement through subject area awards, a six week Honor Roll, and through scheduling earned activity events. Note: If a student or parent chooses not to have the student publicly recognized, they may note that on the admissions form at registration.

Honor Roll

Students with grade point averages at or above a 3.00 are eligible for honor roll recognition as follows:

Grade point average of 4.00 - Principal's Honor Roll

Grade point average of 3.50 - 3.99 - Grand Honor Roll

Grade point average of 3.00 - 3.49 - Honor Roll

Student Government

Brixner Student Council is a program developed to teach and display leadership. It is made up of elected officers and class representatives. Under the supervision of their advisor, the Student Council members plan activities to be added to the social/activity calendar for the student body of Brixner.

The goal of student government is to encourage leadership and participation in school activities and to encourage other students to participate too. Good attendance is required of all student council members. Student body officers are required to maintain a 3.0 G.P.A. and cannot have more than one "N" in citizenship. Representatives must maintain a 2.75 G.P.A. and cannot have more than one "N" in citizenship. If a Student Council member receives a "U" in citizenship, he/she will be automatically removed from student council.

After School Homework Help

Homework help is provided after school on Tuesdays and Thursdays from 3:20 - 3:45 p.m. and on Wednesdays from 3:20 to 5:00 p.m. Please contact the front office if you would like to schedule your child to participate in the homework help.

Extra-Curricular Activities

Athletics

Volleyball will be offered in the Fall, basketball in the Winter and track and field will be offered in the Spring. All school fees must be paid in order to participate in athletics. Contact Brixner's Vice-Principal Tom Loney for more information.

Dances and Celebrations

Periodically, dances and celebrations will be held at the school. Any student with discipline referrals and/or outstanding fees may not be allowed to attend.

Attendance

Participation in after school activities requires the student be in school during the day of the activity. Exceptions may be allowed if the parents receive prior approval for the absence from the administration. Unexcused absences may also make a student ineligible to attend and participate in after school activities.

Students attending school activities are to remain on school grounds at the activity until the event is over or when signed out to leave with a parent/guardian

Field Trips

Field trips may be scheduled for educational, cultural, or other extracurricular purposes. All students are considered to be “in school” while participating in district sponsored field trips. This means students are subject to the school’s student conduct rules, district board policies and other rules deemed appropriate by the field trip supervisor. Parental consent forms are required for most trips.

Lost and Found

The school maintains a Lost and Found which accumulates many items throughout the year. If students have lost items, parents and students may check the Lost and Found to recover their property. Names should be marked plainly on all belongings so they may be returned to the student rather than be placed in the Lost and Found. At the end of the year, items that have not been claimed will be given to charity.

Fund Raising

Student organizations, clubs, and classes, may occasionally be permitted to conduct fundraising drives. An application for permission must be made to the principal at least ten days before the event. All funds raised or collected by or for school approved student groups will be receipted, deposited and accounted for in accordance with Oregon law and applicable district policy and procedures.

Withdrawal from Brixner

When students are withdrawing from Brixner, notification from parents in advance of the date of withdrawal is appreciated and encouraged. Advance notice will provide the school with ample preparation time to prepare grades, collect school property, and prepare school records.

Brixner Grizzlies School-Wide Behavior Expectations

	Respect	Responsibility	Safety	Tolerance
General	*Use good manners *Use kind words *Take care of property: yours, others and school. *Follow staff directions.	*Come to school prepared for all classes and activities. *Be on time *Follow all school rules and expectations.	*Keep hands, feet and objects to yourself. *Stay on school campus. *Report dangerous or unsafe situations immediately to staff.	*Accept others’ differences. *Treat others as you want to be treated.

Hallway	*Use only inside voices. Respect classes in progress.	*Use trash cans for litter. *Use drinking fountains appropriately. *Use hall passes.	*Walk at all times *Stay to the right. *Keep moving through halls and doorways.	*Have positive, friendly interactions with others.
Forum - Morning and Lunch	*Wait your turn in food line. *Use only inside voices. *Respect cafeteria workers.	*Use trash cans for litter. *Stack trays neatly and put silverware in tubs. *Eat only your food. *Clean up your area.	*Walk at all times. *Hang out in groups of 5 or less. *No throwing food.	*Have positive, friendly interactions with others.
Lunch Recess - Outside	*Play nicely and fairly. *Take turns.	*Use equipment appropriately. *Return sports equipment to office. *Use trash cans for litter. *Be prepared for after lunch classes.	*No throwing snow, rocks, etc. *Stay within play area boundaries. *Enter and leave in an orderly manner.	*Include others in games.
Restrooms	*Keep restrooms clean. *Respect others' privacy.	*Flush toilets. *Use trash cans. *Use facilities properly. *Report problems to staff immediately.	*Wash hands. *Enter and exit in an orderly manner. *No loitering.	

Brixner Grizzlies School-Wide Behavior Expectations

	Respect	Responsibility	Safety	Tolerance
Lockers	*Respect others' space, privacy, and property. *Open and shut only your locker.	*Use only your locker. *Keep locker clean and organized. *Use removable decorations only.	*Keep locker combination to yourself. *Open and close lockers quietly and carefully.	*Be patient and polite waiting to use your locker.

Gym	<ul style="list-style-type: none"> *Show good sportsmanship. 	<ul style="list-style-type: none"> *Use equipment appropriately. *Return equipment to storage area. 	<ul style="list-style-type: none"> *Follow game rules. *Stay within game area. *Hang out in groups of 5 or less. 	<ul style="list-style-type: none"> *Encourage others and include everyone. *Be accepting of others' athletic ability.
Office	<ul style="list-style-type: none"> *Wait patiently at the office window. *State your purpose politely. *Use appropriate names and titles. 	<ul style="list-style-type: none"> *Ask permission to use phone or office supplies. *If sent to the office for discipline, sign in. *Sit quietly. 	<ul style="list-style-type: none"> *All visitors must check in the office when entering the building. *Report to the office when feeling ill. 	<ul style="list-style-type: none"> *Respect office staff and visitors.
Library	<ul style="list-style-type: none"> *Treat books, computers, and other property with care. *Use quiet voices. *Respect library staff. 	<ul style="list-style-type: none"> *Return books and materials on time and to designated place. 	<ul style="list-style-type: none"> *Enter and exit in an orderly manner. 	<ul style="list-style-type: none"> *Be respectful of working students.
Assemblies	<ul style="list-style-type: none"> *Listen respectfully. *Applaud appropriately. 	<ul style="list-style-type: none"> *Sit with advisory group. *Choose wisely who you sit by. 	<ul style="list-style-type: none"> *Keep stairways in bleachers clear. *Wait for dismissal instructions. *Walk carefully when going up and down the bleachers. 	<ul style="list-style-type: none"> *Value yourself and others.
Bus Area	<ul style="list-style-type: none"> *Wait your turn *Respect the bus driver. 	<ul style="list-style-type: none"> *Follow all bus rules. *Be to the bus on time. *Use trash cans. 	<ul style="list-style-type: none"> *Walkers - no loitering. *Stay clear of traffic areas. 	<ul style="list-style-type: none"> *Be willing to share your seat.

August/September 2020

Sunday	Monday	Tuesday	Wednesday	Thursday	Friday	Saturday
30	31 Softstart - 1st week begins with student and parent orientation	1 Softstart - 1st week begins with student and parent orientation	2 Softstart - 1st week begins with student and parent orientation	3 Softstart - 1st week begins with student and parent orientation	4 Softstart - 1st week begins with student and parent orientation	5
6	7 Labor Day	8 First day of academics/ CDL Advisory and periods 5-7	9 Advisory and periods 1-4	10 Advisory and periods 5-7	11 7:45-8:45 Profess.Dev. 8:45 - 12:00 Office hours and tutorial 12:30-3:45 Teacher Prep	12
13	14 Advisory and periods 1-4	15 Advisory and periods 5-7	16 Advisory and periods 1-4	17 Advisory and periods 5-7	18 7:45-8:45 Profess.Dev. 8:45 - 12:00 Office hours and tutorial 12:30-3:45 Teacher Prep	19
20	21 Advisory and periods 1-4	22 Advisory and periods 5-7	23 Advisory and periods 1-4	24 Advisory and periods 5-7	25 7:45-8:45 Profess.Dev. 8:45 - 12:00 Office hours and tutorial 12:30-3:45 Teacher Prep	26
27	28 Advisory and periods 1-4	29 Advisory and periods 5-7	30 Advisory and periods 1-4			

October 2020

Sunday	Monday	Tuesday	Wednesday	Thursday	Friday	Saturday
				1 Advisory and periods 5-7	2 7:45-8:45 Profess.Dev. 8:45 - 12:00 Office hours and tutorial 12:30-3:45 Teacher Prep	3
4	5 Advisory and periods 1-4	6 Advisory and periods 5-7	7 Advisory and periods 1-4	8 End of 1st grading period Advisory and periods 5-7	9 No School	10
11	12 Start of Hybrid or continue CDL	13	14 Conferences	15 No School- Conferences	16 No School	17
18	19	20	21	22	23	24
25	26	27	28	29	30	31

November 2020

Sunday	Monday	Tuesday	Wednesday	Thursday	Friday	Saturday
1	2	3	4	5	6	7
8	9	10	11 Veterans Day-No School	12	13	14
15	16	17	18	19 End of 2nd grading period	20 No School	21
22	23 No School	24 No School	25 No School	26 Thanksgiving No School	27 No School	28
29	30					

December 2020

Sunday	Monday	Tuesday	Wednesday	Thursday	Friday	Saturday
		1	2	3	4	5
6	7	8	9	10	11	12
13	14	15	16	17	18	19
20	21 No School	22 No School	23 No School	24 No School	25 Christmas No School	26
27	28 No School	29 No School	30 No School	31 No School		

January 2021

Sunday	Monday	Tuesday	Wednesday	Thursday	Friday	Saturday
					1 New Years No School	2
3	4	5	6	7	8	9
10	11	12	13	14	15	16
17	18 MLK Day-No School	19	20	21 End of Semester	22 No School	23
24 31	25	26	27	28	29	30

February 2021

Sunday	Monday	Tuesday	Wednesday	Thursday	Friday	Saturday
	1	2	3	4	5	6
7	8	9	10	11	12	13
14	15 Presidents Day-No School	16	17	18	19	20
21	22	23	24	25	26	27
28						

March 2021

Sunday	Monday	Tuesday	Wednesday	Thursday	Friday	Saturday
	1	2	3	4	5	6
7	8	9	10	11 End of 4th grading period	12 No School	13
14	15	16	17 Conferences	18 No School- Conferences	19 No School	20
21	22 No School	23 No School	24 No School	25 No School	26 No School	27
28	29	30	31			

April 2021

Sunday	Monday	Tuesday	Wednesday	Thursday	Friday	Saturday
				1	2	2
4	5	6	7	8	9	10
11	12	13	14	15	16	17
18	19	20	21	22	23	24
25	26	27	28	29 End of 5th grading period	30 No School	

May 2021

Sunday	Monday	Tuesday	Wednesday	Thursday	Friday	Saturday
						1
2	3	4	5	6	7	8
9	10	11	12	13	14	15
16	17	18	19	20	21	22
23	24	25	26	27	28	29
30	31 Memorial Day-No School					

June 2021

Sunday	Monday	Tuesday	Wednesday	Thursday	Friday	Saturday
		1	2	3	4	5
6	7	8	9	10 Last day of School	11	12
13	14	15	16	17	18	19
20	21	22	23	24	25	26

