

Coleman Creek Consulting, Inc.

## **DRINKING WATER LEAD SAMPLING**

OF

### **DISTRICT OFFICE BUILDINGS #1 AND #2 GREENSPRINGS AND MAINTENANCE/BUS**

**2485 GREENSPRINGS DRIVE, KLAMATH FALLS, OREGON**

FOR

### **KLAMATH COUNTY SCHOOL DISTRICT**

#### **INTRODUCTION**

Coleman Creek Consulting, Inc. (CCC) was retained by Klamath County School District (KCS D) to perform representative lead drinking water sampling of District office Building #1 and Building #2 at the above address. The purpose of the lead drinking water sampling was to determine the concentration of lead in representative drinking water sources and compare with regulatory standards. In 2017, Education Service Districts were required to adopt a Healthy and Safe Schools Plan, including provisions for testing and reducing exposure to elevated levels of lead in water used for drinking and food preparation.

#### **LEAD DRINKING WATER SAMPLING REQUIREMENTS**

Guidelines for sampling lead in water were established by the Oregon Health Authority. Water sampling is to occur after water sits overnight in the pipes without being used, and must be sampled after a day occupied by students or building occupants. All water sources are to be sampled, with the exception of water used for heating, sanitation, irrigation, and science sinks for grades 6 and up with non-potable water signs. Initial testing is required to be performed by 2020, and every 6 years thereafter, according to a testing schedule determined by the Oregon Department of Education.

#### **SAMPLE LOCATION DETERMINATION/SAMPLE PREP**

David W. Fawcett of CCC contacted Steve Schooler, Head Custodian at the District Office Building #1, and discussed the objectives of the lead drinking water program. Mr. Fawcett contacted Darin Martins, Custodial Supervisor, and discussed the objectives of the lead drinking water program. Mr. Schooler reviewed Building #1 for water sources and identified by type on building floor plans. Mr. Martins reviewed Building #2 for water sources and identified by type on building floor plans. Mr. Fawcett, Mr. Schooler, and Mr. Martins discussed the drinking water sources by phone, and Mr. Fawcett created Site Sample Record Sheets describing each drinking water source by type and location. Mr. Fawcett identified each source by number (1-28), and identified each source number on floorplan diagrams of both Building #1 and Building #2. Mr. Fawcett delivered the following sampling materials to Mr. Schooler and Mr. Martins January 15, 2025: Numbered sample containers, Site Sample Record Sheet filled out with Sample Number, Sample Type, and Location. Mr. Schooler and Mr. Martins were instructed in proper sampling technique, including sampling prior to water

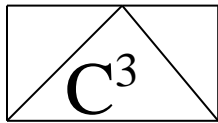

# Coleman Creek Consulting, Inc.

system use by other school occupants, fill sample container immediately from faucet opening, and recording time of water sampling on the Site Sample Record Sheets (pages 3-5).

## **DRINKING WATER SAMPLING**

Mr. Schooler collected lead drinking water samples from the drinking water sources identified in District Office Building #1 January 16, 2025. See Site Sample Record Sheet (page 3) for a description of the drinking water sources sampled. Mr. Martins collected lead drinking water samples from the drinking water sources identified in District Office Building #2 January 16, 2025. See Site Sample Record Sheet (page 4) for a description of the drinking water sources sampled. See Drinking Water Sample Location Diagrams in Appendix A for a visual review of all drinking water sample locations. The drinking water samples were collected in the early morning, ensuring that the sample source had not been in use since the previous day. The samples were placed in a cooler. Mr. Fawcett picked up the samples collected by Mr. Schooler and Mr. Martins January 16, 2025, and transported to Neilson Research Corporation in Medford, Oregon.

## **DRINKING WATER LEAD RESULTS AND TESTING SUMMARY SHEETS**

The twenty-eight (28) drinking water samples collected were analyzed for lead using EPA Method 200.8. See Neilson Research Corporation Analytical Report in Appendix B. Drinking Water Testing Summary Sheets (pages 5 and 6) indicate the lead in drinking water concentrations for the twenty-eight (28) samples collected from District Office Building #1 and Building #2 were reported ranging from <0.5 to 3.2 parts per billion (ppb).

## **CONCLUSIONS**

Twenty-eight (28) drinking water samples were collected from drinking water sources at District Office Building #1 and Building #2 prior to use that day by building occupants, and after a day the facility was occupied. The lead concentrations reported were all below the 15 ppb lead action level in water.

## **RECOMMENDATIONS**

Coleman Creek Consulting, Inc. recommends continuing the lead drinking water sampling schedule in the future. Coleman Creek Consulting, Inc. appreciates the opportunity to continue to perform environmental sampling and consulting services to Klamath County School District.

David W. Fawcett  
Director of Consulting Services

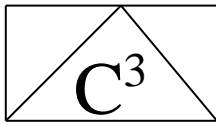

# Coleman Creek Consulting, Inc.

## DRINKING WATER SITE SAMPLE RECORD SHEET

BUILDING: District Office - Greensprings Bldg #1  
ADDRESS: 2845 Greensprings Drive  
Klamath Falls, Oregon

DATE: 01-16-25  
SAMPLER: Steve Schooler

SAMPLE #	SAMPLE TYPE	LOCATION	TIME
24-167G.1	DW	Men's Bath at Fitness Left Sink Faucet	0507
24-167G.2	DW	Men's Bath at Fitness Right Sink Faucet	0506
24-167G.3	DW	Women's Bath at Fitness Left Sink Faucet	0505
24-167G.4	DW	Women's Bath at Fitness Right Sink Faucet	0504
24-167G.5	DW	Men's Bath at Stairs Sink Faucet	0503
24-167G.6	DW	Women's Bath at Stairs Sink Faucet	0502
24-167G.7	DW	Break Room Sink Faucet	0500
24-167G.8	DW	1 <sup>st</sup> Floor Drinking Fountain at Elevator	0514
24-167G.9	DW	Staff Development Room Sink Faucet	0515
24-167G.10	DW	2 <sup>nd</sup> Floor Drinking Fountain at Elevator	0517
24-167G.11	DW	2 <sup>nd</sup> Floor Left Bath at Elevator Sink Faucet	0512
24-167G.12	DW	2 <sup>nd</sup> Floor Right Bath at Elevator Sink Faucet	0511
24-167G.13	DW	Boardroom Bath Sink Faucet	0508
24-167G.14	DW	Boardroom Break Room Sink Faucet	0509
24-167G.15	DW	2 <sup>nd</sup> Floor Bath at Payroll Support Sink Faucet	0511
24-167G.16	DW	Payroll Support Sink Faucet	0510

Comments: DW = Drinking Water RR = Restroom R = Right L = Left RM = Right Middle  
LM = Left Middle M = Middle

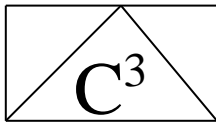

# Coleman Creek Consulting, Inc.

## DRINKING WATER SITE SAMPLE RECORD SHEET

BUILDING: Maintenance/Bus - Greensprings Bldg #2      DATE: 01-16-25  
ADDRESS: 2845 Greensprings Drive      SAMPLER: Darin Martins  
Klamath Falls, Oregon

SAMPLE #	SAMPLE TYPE	LOCATION	TIME
24-167G.17	DW	Maintenance 1 <sup>st</sup> Floor Bath Sink Faucet	0508
24-167G.18	DW	Maintenance 1 <sup>st</sup> Floor Conference Sink Faucet	0508
24-167G.19	DW	Maintenance 2 <sup>nd</sup> Floor Bath Sink Faucet	0510
24-167G.20	DW	Maintenance 2 <sup>nd</sup> Floor Conference Sink Faucet	0510
24-167G.21	DW	Bus 1 <sup>st</sup> Floor Bath at Office Sink Faucet	0514
24-167G.22	DW	Bus Mechanics Locker Sink Faucet	0515
24-167G.23	DW	Bus Mechanics Locker Bath Sink Faucet	0515
24-167G.24	DW	Bus Mechanics Outside Office Sink Faucet	0516
24-167G.25	DW	Bus 2 <sup>nd</sup> Floor Break Room Sink Faucet	0517
24-167G.26	DW	Bus 2 <sup>nd</sup> Floor Bath Sink Faucet	0517
24-167G.27	DW	IT Dept. Breakroom Sink Faucet	0519
24-167G.28	DW	IT Bath Sink Faucet	0519

Comments: DW = Drinking Water RR = Restroom R = Right L = Left RM = Right Middle  
LM = Left Middle M = Middle

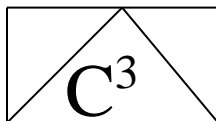

# Coleman Creek Consulting, Inc.

## DRINKING WATER TESTING SUMMARY SHEET

DISTRICT NAME: Klamath County School District  
DISTRICT ID#: 467  
SCHOOL NAME: District Office  
BUILDING NAME: District Office Building #1  
BUILDING ID#: 20572300

Sample Number	Fixture Location/ Description	Fixture ID#	Test Date	Test Result (ppb)	# Retest	Final Result (ppb)
25-167G.1	Men's Bath at Fitness Left Sink	20572300-001BF	01-16-25	<0.5		<0.5
25-167G.2	Men's Bath at Fitness Right Sink	20572300-002BF	01-16-25	<0.5		<0.5
25-167G.3	Women's Bath at Fitness Left Sink	20572300-003BF	01-16-25	<0.5		<0.5
25-167G.4	Women's Bath at Fitness Right Sink	20572300-004BF	01-16-25	<0.5		<0.5
25-167G.5	Men's Bath at Stairs Sink	20572300-005BF	01-16-25	<0.5		<0.5
25-167G.6	Women's Bath at Stairs Sink	20572300-006BF	01-16-25	0.573		0.573
25-167G.7	Break Room Sink	20572300-007SF	01-16-25	<0.5		<0.5
25-167G.8	1 <sup>st</sup> Floor Fountain at Elevator	20572300-008DW	01-16-25	<0.5		<0.5
25-167G.9	Staff Development Room Sink	20572300-009SF	01-16-25	<0.5		<0.5
25-167G.10	2 <sup>nd</sup> Floor Fountain at Elevator	20572300-010DW	01-16-25	<0.5		<0.5
25-167G.11	2 <sup>nd</sup> Floor Left Bath at Elevator Sink	20572300-011BF	01-16-25	<0.5		<0.5
25-167G.12	2 <sup>nd</sup> Floor Right Bath at Elevator Sink	20572300-012BF	01-16-25	<0.5		<0.5
25-167G.13	Boardroom Bath Sink	20572300-013BF	01-16-25	<0.5		<0.5
25-167G.14	Boardroom Break Room Sink	20572300-014SF	01-16-25	<0.5		<0.5
25-167G.15	2 <sup>nd</sup> Floor Bath at Payroll Support Sink	20572300-015BF	01-16-25	<0.5		<0.5
25-167G.16	Payroll Support Sink	20572300-016SF	01-16-25	0.57		0.57

Fixture ID Coding:

**Bold Indicates Test Result >15 ppb**

DW = Drinking Water Fountain WC = Water Cooler WB = Water Bottle Filler

CF = Classroom Faucet BF = Bathroom Faucet SF = Staff/Office Faucet

KF = Kitchen/Food Prep OS = Outside Spigot OT = Other (Specify)

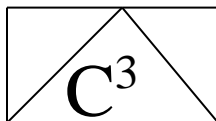

# Coleman Creek Consulting, Inc.

## DRINKING WATER TESTING SUMMARY SHEET

DISTRICT NAME: Klamath County School District  
DISTRICT ID#: 467  
SCHOOL NAME: District Office  
BUILDING NAME: District Office Building #2  
BUILDING ID#: 20572301

Sample Number	Fixture Location/ Description	Fixture ID#	Test Date	Test Result (ppb)	# Retest	Final Result (ppb)
25-167G.17	Maintenance 1 <sup>st</sup> Floor Bath Sink	20572301-017BF	01-16-25	0.915		0.915
25-167G.18	Maintenance 1 <sup>st</sup> Floor Conf. Sink	20572301-018SF	01-16-25	<0.5		<0.5
25-167G.19	Maintenance 2 <sup>nd</sup> Floor Bath Sink	20572301-019BF	01-16-25	<0.5		<0.5
25-167G.20	Maintenance 2 <sup>nd</sup> Floor Conf. Sink	20572301-020SF	01-16-25	<0.5		<0.5
25-167G.21	Bus 1 <sup>st</sup> Floor Bath at Office Sink	20572301-021BF	01-16-25	3.2		3.2
25-167G.22	Bus Mechanics Locker Sink	20572301-022BF	01-16-25	<0.5		<0.5
25-167G.23	Bus Mechanics Locker Bath Sink	20572301-023BF	01-16-25	<0.5		<0.5
25-167G.24	Bus Mechanics Outside Office Sink	20572301-024SF	01-16-25	<0.5		<0.5
25-167G.25	Bus 2 <sup>nd</sup> Floor Break Room Sink	20572301-025SF	01-16-25	<0.5		<0.5
25-167G.26	Bus 2 <sup>nd</sup> Floor Bath Sink	20572301-026BF	01-16-25	<0.5		<0.5
25-167G.27	IT Dept. Breakroom Sink	20572301-027SF	01-16-25	<0.5		<0.5
25-167G.28	IT Bath Sink	20572301-028BF	01-16-25	<0.5		<0.5

Fixture ID Coding:

**Bold Indicates Test Result >15 ppb**

DW = Drinking Water Fountain WC = Water Cooler WB = Water Bottle Filler  
CF = Classroom Faucet BF = Bathroom Faucet SF = Staff/Office Faucet  
KF = Kitchen/Food Prep OS = Outside Spigot OT = Other (Specify)

**APPENDIX A**

**DRINKING WATER SAMPLE LOCATION  
DIAGRAMS**

**DISTRICT OFFICE FIRST AND SECOND FLOOR  
MAINTENANCE/BUS BUILDING**

# Drinking Water Sample Location Diagram

## District Office - First Floor

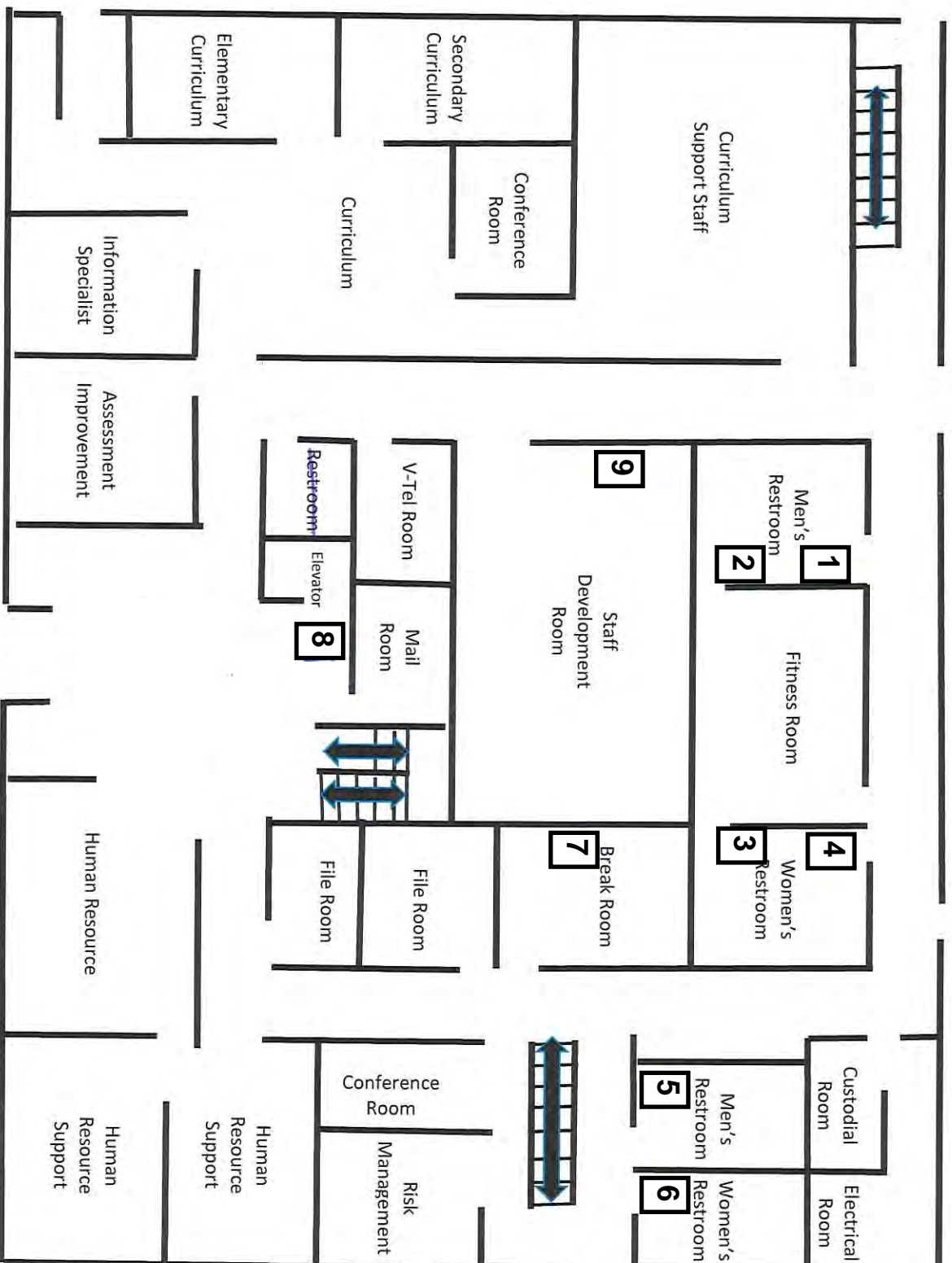

**2 = Drinking Water Sample Location**

Front Entrance



# DRINKING WATER SAMPLE LOCATION DIAGRAM

District Office - Second Floor

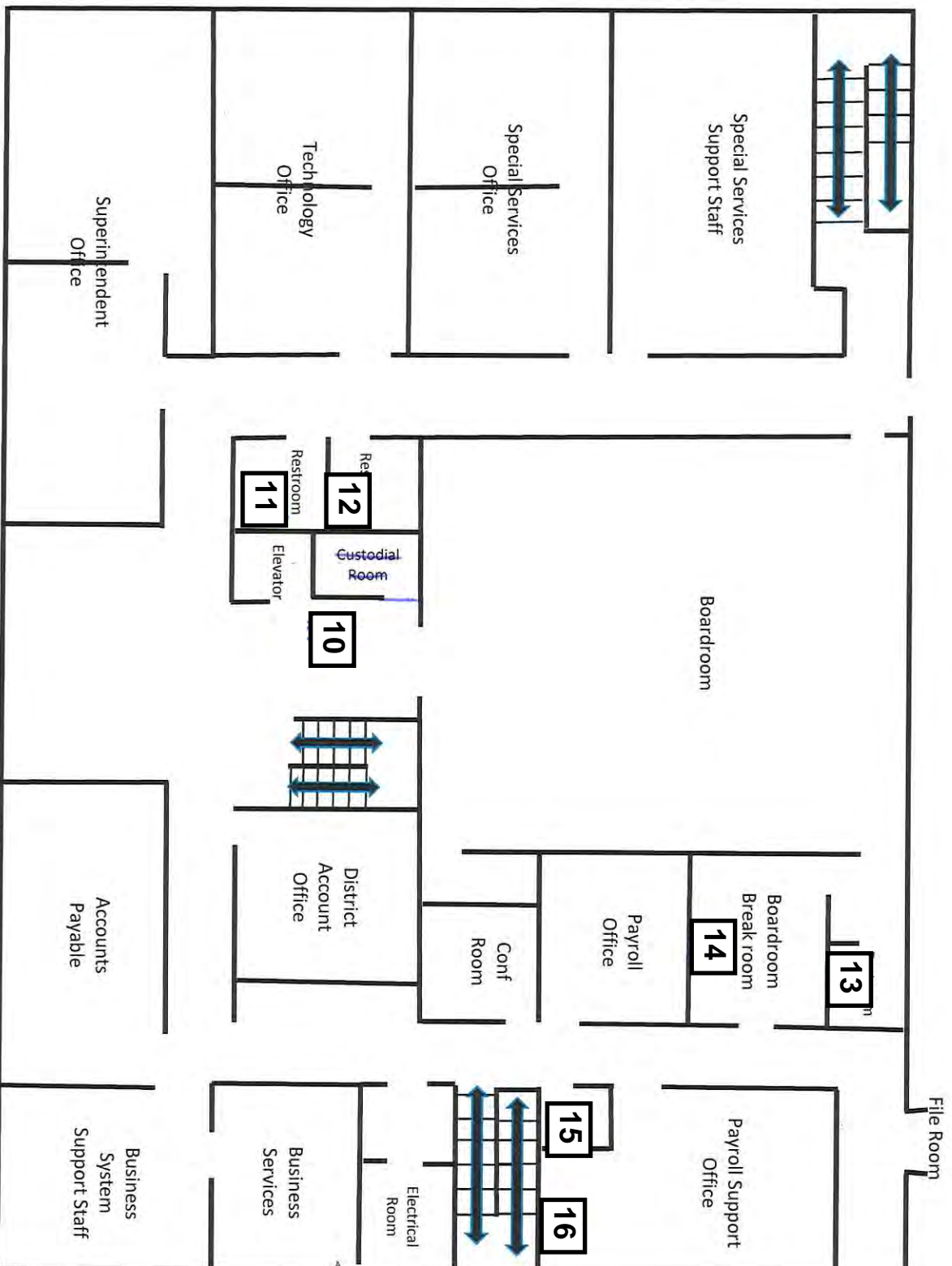

12 = Drinking Water Sample Location

# DRINKING WATER SAMPLE LOCATION DIAGRAM

## Greensprings Building #2 - Bus/Maintenance

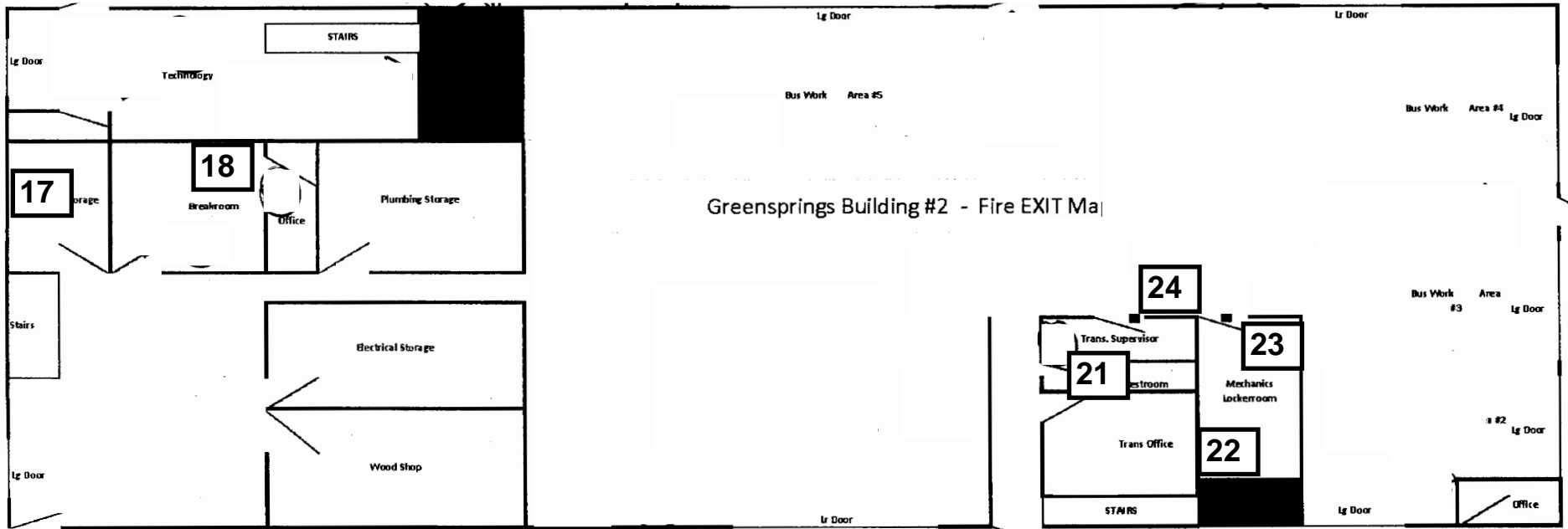

**22** = Drinking Water Sample Location

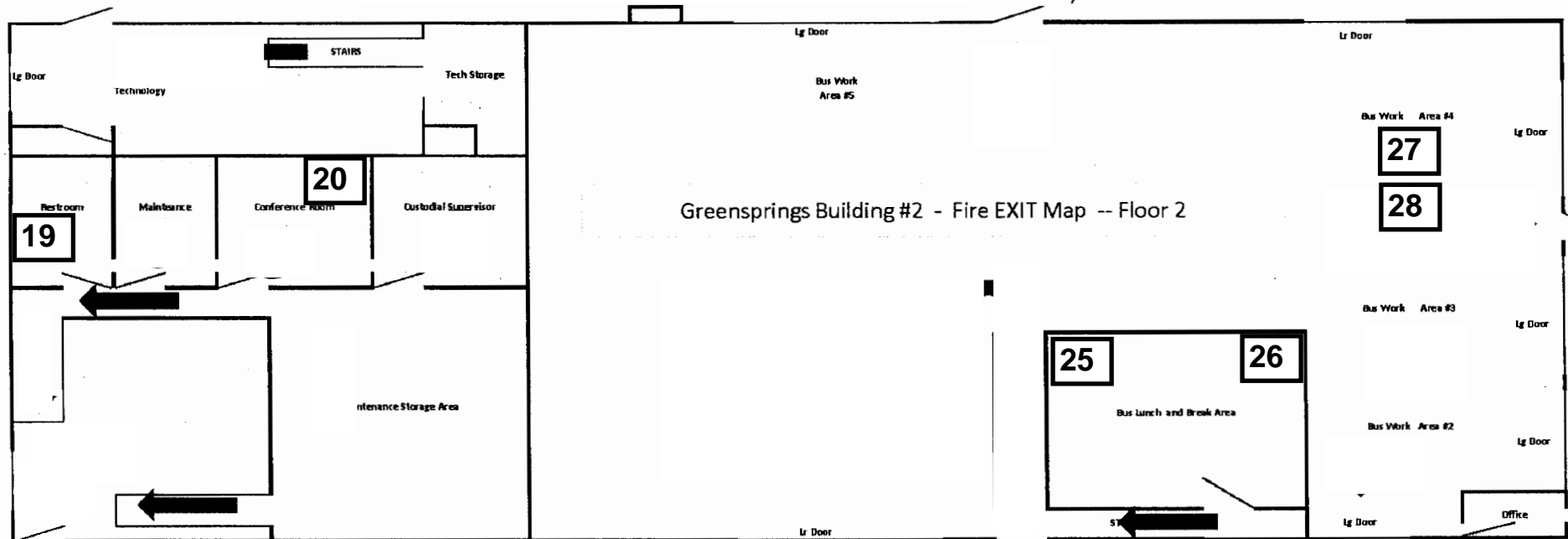

## **APPENDIX B**

### **NEILSON RESEARCH CORPORATION ANALYTICAL REPORT**



Neilson Research Corporation  
245 S Grape St  
Medford, OR 97501  
TEL: (541) 770-5678 FAX: (541) 770-2901  
Website: [www.nrclabs.com](http://www.nrclabs.com)

January 27, 2025

Dave Fawcett  
Coleman Creek Consulting  
810 Leonard St  
Ashland, OR 97520  
TEL: (541) 535-7108  
FAX (541) 535-8795

RE: 24-167G District Office Lead Testing

Order No.: 25010654

Dear Dave Fawcett:

Neilson Research Corporation received 16 sample(s) on 1/16/2025 for the analyses presented in the following report.

The results relate only to the parameters tested or to the sample as received by the laboratory. This report shall not be reproduced except in full, without the written approval of Neilson Research Corporation. If you have any questions regarding these test results, please feel free to call.

Sincerely,  
Neilson Research Corporation

Tamra Schmedemann  
Senior Project Manager  
245 S Grape St  
Medford, OR 97501



Original



Neilson Research Corporation  
245 S Grape St  
Medford, OR 97501  
TEL: (541) 770-5678 FAX: (541) 770-2901  
Website: [www.nrclabs.com](http://www.nrclabs.com)

## Case Narrative

WO#: 25010654  
Date: 1/27/2025

---

**CLIENT:** Coleman Creek Consulting

**Project:** 24-167G District Office Lead Testing

---

The analyses were performed according to the guidelines in the Neilson Research Corporation Quality Assurance Program. This report contains analytical results for the sample(s) as received by the laboratory.

Neilson Research Corporation certifies that this report is in compliance with the requirements of NELAP. No unusual difficulties were experienced during analysis of this batch except as noted below or qualified with data flags on the reports.

---

Original



Neilson Research Corporation  
245 S Grape St  
Medford, OR 97501  
TEL: (541) 770-5678 FAX: (541) 770-2901  
Website: www.nrclabs.com

## Analytical Report

WO#: 25010654

Date Reported: 1/27/2025

Coleman Creek Consulting  
810 Leonard St  
Ashland, OR 97520

**Lab Order:** 25010654  
**Received Date:** 1/16/2025 1:58:00 PM  
**Reported Date:** 1/27/2025 3:05:39 PM

Sample Information:

**Lab ID:** 25010654-01 **Client Sample ID:** 24-167G.1  
**Collection Date:** 1/16/2025 5:07:00 AM **Collected By:** Steve Schooler  
**Matrix:** Drinking Water **Sample Location:** Men's RR at Fitness L Sink

Trace Metals by EPA 200.8 ICP-MS								Analyst: KN
Analyses	Result	Qual	MRL	Units	DF	Date Analyzed	MCL	NELAP Status
Lead	ND		0.500	ppb	1	1/20/2025	15.0	A

**Lab ID:** 25010654-02 **Client Sample ID:** 24-167G.2  
**Collection Date:** 1/16/2025 5:06:00 AM **Collected By:** Steve Schooler  
**Matrix:** Drinking Water **Sample Location:** Men's RR at Fitness R Sink

Trace Metals by EPA 200.8 ICP-MS								Analyst: KN
Analyses	Result	Qual	MRL	Units	DF	Date Analyzed	MCL	NELAP Status
Lead	ND		0.500	ppb	1	1/20/2025	15.0	A

**Lab ID:** 25010654-03 **Client Sample ID:** 24-167G.3  
**Collection Date:** 1/16/2025 5:05:00 AM **Collected By:** Steve Schooler  
**Matrix:** Drinking Water **Sample Location:** Women's RR at Fitness L Sink

Trace Metals by EPA 200.8 ICP-MS								Analyst: KN
Analyses	Result	Qual	MRL	Units	DF	Date Analyzed	MCL	NELAP Status
Lead	ND		0.500	ppb	1	1/20/2025	15.0	A

QUALIFIERS	*	Value exceeds Maximum or Minimum Contaminant Level.	C1	Sample container temperature is out of limit as specified at testcode
	E	Value above quantitation range	H	Holding times for preparation or analysis exceeded
	J	Analyte detected below quantitation limits	MI	Recovery outside control limits due to Matrix Interference
	ND	Not Detected at the Reporting Limit	PL	Permit Limit
	PRE	Percent RE exceeds the Limit	R	RPD outside accepted recovery limits

**NELAP** A Accredited in accordance with NELAP ORELAP 100016, OR-028

Original



Neilson Research Corporation  
245 S Grape St  
Medford, OR 97501  
TEL: (541) 770-5678 FAX: (541) 770-2901  
Website: www.nrclabs.com

## Analytical Report

WO#: 25010654

Date Reported: 1/27/2025

Coleman Creek Consulting  
810 Leonard St  
Ashland, OR 97520

**Lab Order:** 25010654  
**Received Date:** 1/16/2025 1:58:00 PM  
**Reported Date:** 1/27/2025 3:05:39 PM

Sample Information:

**Lab ID:** 25010654-04 **Client Sample ID:** 24-167G.4  
**Collection Date:** 1/16/2025 5:04:00 AM **Collected By:** Steve Schooler  
**Matrix:** Drinking Water **Sample Location:** Women's RR at Fitness R Sink

Trace Metals by EPA 200.8 ICP-MS								Analyst: KN
Analyses	Result	Qual	MRL	Units	DF	Date Analyzed	MCL	NELAP Status
Lead	ND		0.500	ppb	1	1/20/2025	15.0	A

**Lab ID:** 25010654-05 **Client Sample ID:** 24-167G.5  
**Collection Date:** 1/16/2025 5:03:00 AM **Collected By:** Steve Schooler  
**Matrix:** Drinking Water **Sample Location:** Men's RR at Stairs Sink

Trace Metals by EPA 200.8 ICP-MS								Analyst: KN
Analyses	Result	Qual	MRL	Units	DF	Date Analyzed	MCL	NELAP Status
Lead	ND		0.500	ppb	1	1/20/2025	15.0	A

**Lab ID:** 25010654-06 **Client Sample ID:** 24-167G.6  
**Collection Date:** 1/16/2025 5:02:00 AM **Collected By:** Steve Schooler  
**Matrix:** Drinking Water **Sample Location:** Women's RR at Stairs Sink

Trace Metals by EPA 200.8 ICP-MS								Analyst: KN
Analyses	Result	Qual	MRL	Units	DF	Date Analyzed	MCL	NELAP Status
Lead	0.573		0.500	ppb	1	1/20/2025	15.0	A

QUALIFIERS	*	Value exceeds Maximum or Minimum Contaminant Level.	C1	Sample container temperature is out of limit as specified at testcode
	E	Value above quantitation range	H	Holding times for preparation or analysis exceeded
	J	Analyte detected below quantitation limits	MI	Recovery outside control limits due to Matrix Interference
	ND	Not Detected at the Reporting Limit	PL	Permit Limit
	PRE	Percent RE exceeds the Limit	R	RPD outside accepted recovery limits

NELAP A Accredited in accordance with NELAP ORELAP 100016, OR-028

Original



Neilson Research Corporation  
245 S Grape St  
Medford, OR 97501  
TEL: (541) 770-5678 FAX: (541) 770-2901  
Website: www.nrclabs.com

## Analytical Report

WO#: 25010654

Date Reported: 1/27/2025

Coleman Creek Consulting  
810 Leonard St  
Ashland, OR 97520

**Lab Order:** 25010654  
**Received Date:** 1/16/2025 1:58:00 PM  
**Reported Date:** 1/27/2025 3:05:39 PM

Sample Information:

**Lab ID:** 25010654-07 **Client Sample ID:** 24-167G.7  
**Collection Date:** 1/16/2025 5:00:00 AM **Collected By:** Steve Schooler  
**Matrix:** Drinking Water **Sample Location:** Break Room Sink

Trace Metals by EPA 200.8 ICP-MS								Analyst: KN
Analyses	Result	Qual	MRL	Units	DF	Date Analyzed	MCL	NELAP Status
Lead	ND		0.500	ppb	1	1/20/2025	15.0	A

**Lab ID:** 25010654-08 **Client Sample ID:** 24-167G.8  
**Collection Date:** 1/16/2025 5:14:00 AM **Collected By:** Steve Schooler  
**Matrix:** Drinking Water **Sample Location:** 1st Floor DF at Elevator

Trace Metals by EPA 200.8 ICP-MS								Analyst: KN
Analyses	Result	Qual	MRL	Units	DF	Date Analyzed	MCL	NELAP Status
Lead	ND		0.500	ppb	1	1/20/2025	15.0	A

**Lab ID:** 25010654-09 **Client Sample ID:** 24-167G.9  
**Collection Date:** 1/16/2025 5:15:00 AM **Collected By:** Steve Schooler  
**Matrix:** Drinking Water **Sample Location:** Staff Development Rm Sink

Trace Metals by EPA 200.8 ICP-MS								Analyst: KN
Analyses	Result	Qual	MRL	Units	DF	Date Analyzed	MCL	NELAP Status
Lead	ND		0.500	ppb	1	1/20/2025	15.0	A

QUALIFIERS	*	Value exceeds Maximum or Minimum Contaminant Level.	C1	Sample container temperature is out of limit as specified at testcode
	E	Value above quantitation range	H	Holding times for preparation or analysis exceeded
	J	Analyte detected below quantitation limits	MI	Recovery outside control limits due to Matrix Interference
	ND	Not Detected at the Reporting Limit	PL	Permit Limit
	PRE	Percent RE exceeds the Limit	R	RPD outside accepted recovery limits

NELAP A Accredited in accordance with NELAP ORELAP 100016, OR-028

Original





Neilson Research Corporation  
245 S Grape St  
Medford, OR 97501  
TEL: (541) 770-5678 FAX: (541) 770-2901  
Website: www.nrclabs.com

## Analytical Report

WO#: 25010654

Date Reported: 1/27/2025

Coleman Creek Consulting  
810 Leonard St  
Ashland, OR 97520

**Lab Order:** 25010654  
**Received Date:** 1/16/2025 1:58:00 PM  
**Reported Date:** 1/27/2025 3:05:39 PM

Sample Information:

**Lab ID:** 25010654-10 **Client Sample ID:** 24-167G.10  
**Collection Date:** 1/16/2025 5:17:00 AM **Collected By:** Steve Schooler  
**Matrix:** Drinking Water **Sample Location:** 2nd Floor DF at Elevator

Trace Metals by EPA 200.8 ICP-MS						Analyst: KN			
Analyses	Result	Qual	MRL	Units	DF	Date Analyzed	MCL	NELAP Status	
Lead	ND		0.500	ppb	1	1/20/2025	15.0	A	

**Lab ID:** 25010654-11 **Client Sample ID:** 24-167G.11  
**Collection Date:** 1/16/2025 5:12:00 AM **Collected By:** Steve Schooler  
**Matrix:** Drinking Water **Sample Location:** 2nd Floor L RR at Elevator Sink

Trace Metals by EPA 200.8 ICP-MS						Analyst: KN			
Analyses	Result	Qual	MRL	Units	DF	Date Analyzed	MCL	NELAP Status	
Lead	ND		0.500	ppb	1	1/20/2025	15.0	A	

**Lab ID:** 25010654-12 **Client Sample ID:** 24-167G.12  
**Collection Date:** 1/16/2025 5:11:00 AM **Collected By:** Steve Schooler  
**Matrix:** Drinking Water **Sample Location:** 2nd Floor R RR at Elevator Sink

Trace Metals by EPA 200.8 ICP-MS						Analyst: KN			
Analyses	Result	Qual	MRL	Units	DF	Date Analyzed	MCL	NELAP Status	
Lead	ND		0.500	ppb	1	1/20/2025	15.0	A	

QUALIFIERS	*	Value exceeds Maximum or Minimum Contaminant Level.	C1	Sample container temperature is out of limit as specified at testcode
	E	Value above quantitation range	H	Holding times for preparation or analysis exceeded
	J	Analyte detected below quantitation limits	MI	Recovery outside control limits due to Matrix Interference
	ND	Not Detected at the Reporting Limit	PL	Permit Limit
	PRE	Percent RE exceeds the Limit	R	RPD outside accepted recovery limits

NELAP A Accredited in accordance with NELAP ORELAP 100016, OR-028

Original



Neilson Research Corporation  
245 S Grape St  
Medford, OR 97501  
TEL: (541) 770-5678 FAX: (541) 770-2901  
Website: www.nrclabs.com

## Analytical Report

WO#: 25010654

Date Reported: 1/27/2025

Coleman Creek Consulting  
810 Leonard St  
Ashland, OR 97520

**Lab Order:** 25010654  
**Received Date:** 1/16/2025 1:58:00 PM  
**Reported Date:** 1/27/2025 3:05:39 PM

Sample Information:

**Lab ID:** 25010654-13 **Client Sample ID:** 24-167G.13  
**Collection Date:** 1/16/2025 5:08:00 AM **Collected By:** Steve Schooler  
**Matrix:** Drinking Water **Sample Location:** Boardroom RR Sink

Trace Metals by EPA 200.8 ICP-MS								Analyst: KN
Analyses	Result	Qual	MRL	Units	DF	Date Analyzed	MCL	NELAP Status
Lead	ND		0.500	ppb	1	1/20/2025	15.0	A

**Lab ID:** 25010654-14 **Client Sample ID:** 24-167G.14  
**Collection Date:** 1/16/2025 5:09:00 AM **Collected By:** Steve Schooler  
**Matrix:** Drinking Water **Sample Location:** Boardroom Break Room Sink

Trace Metals by EPA 200.8 ICP-MS								Analyst: KN
Analyses	Result	Qual	MRL	Units	DF	Date Analyzed	MCL	NELAP Status
Lead	ND		0.500	ppb	1	1/20/2025	15.0	A

**Lab ID:** 25010654-15 **Client Sample ID:** 24-167G.15  
**Collection Date:** 1/16/2025 5:11:00 AM **Collected By:** Steve Schooler  
**Matrix:** Drinking Water **Sample Location:** 2nd Floor RR at Payroll Support Sink

Trace Metals by EPA 200.8 ICP-MS								Analyst: KN
Analyses	Result	Qual	MRL	Units	DF	Date Analyzed	MCL	NELAP Status
Lead	ND		0.500	ppb	1	1/20/2025	15.0	A

QUALIFIERS	*	Value exceeds Maximum or Minimum Contaminant Level.	C1	Sample container temperature is out of limit as specified at testcode
	E	Value above quantitation range	H	Holding times for preparation or analysis exceeded
	J	Analyte detected below quantitation limits	MI	Recovery outside control limits due to Matrix Interference
	ND	Not Detected at the Reporting Limit	PL	Permit Limit
	PRE	Percent RE exceeds the Limit	R	RPD outside accepted recovery limits

**NELAP** A Accredited in accordance with NELAP ORELAP 100016, OR-028

Original



Neilson Research Corporation  
245 S Grape St  
Medford, OR 97501  
TEL: (541) 770-5678 FAX: (541) 770-2901  
Website: www.nrclabs.com

## Analytical Report

WO#: 25010654  
Date Reported: 1/27/2025

Coleman Creek Consulting  
810 Leonard St  
Ashland, OR 97520

**Lab Order:** 25010654  
**Received Date:** 1/16/2025 1:58:00 PM  
**Reported Date:** 1/27/2025 3:05:39 PM

Sample Information:

**Lab ID:** 25010654-16      **Client Sample ID:** 24-167G.16  
**Collection Date:** 1/16/2025 5:10:00 AM      **Collected By:** Steve Schooler  
**Matrix:** Drinking Water      **Sample Location:** Payroll Support Sink

Trace Metals by EPA 200.8 ICP-MS						Analyst: KN		
Analyses	Result	Qual	MRL	Units	DF	Date Analyzed	MCL	NELAP Status
Lead	0.570		0.500	ppb	1	1/20/2025	15.0	A

QUALIFIERS	*	Value exceeds Maximum or Minimum Contaminant Level.	C1	Sample container temperature is out of limit as specified at testcode
	E	Value above quantitation range	H	Holding times for preparation or analysis exceeded
	J	Analyte detected below quantitation limits	MI	Recovery outside control limits due to Matrix Interference
	ND	Not Detected at the Reporting Limit	PL	Permit Limit
	PRE	Percent RE exceeds the Limit	R	RPD outside accepted recovery limits

NELAP A Accredited in accordance with NELAP ORELAP 100016, OR-028

Original



Neilson Research Corporation  
245 S Grape St  
Medford, OR 97501  
TEL: (541) 770-5678 FAX: (541) 770-2901  
Website: www.nrclabs.com

## QC SUMMARY REPORT

WO#: 25010654  
27-Jan-25

Client: Coleman Creek Consulting  
Project: 24-167G District Office Lead Testing

TestCode: LEAD\_DW

Sample ID: <b>MB-29929</b>	SampType: <b>MBLK</b>	TestCode: <b>LEAD_DW</b>	Units: <b>ppb</b>	Prep Date: <b>1/17/2025</b>	RunNo: <b>55617</b>						
Client ID: <b>PBW</b>	Batch ID: <b>29929</b>	TestNo: <b>E200.8</b>	<b>E200.8</b>	Analysis Date: <b>1/20/2025</b>	SeqNo: <b>919224</b>						
Analyte	Result	PQL	SPK value	SPK Ref Val	%REC	LowLimit	HighLimit	RPD Ref Val	%RPD	RPDLimit	Qual
Lead	ND	0.500									

Sample ID: LCS-29929	SampType: LCS	TestCode: LEAD_DW	Units: ppb	Prep Date: 1/17/2025	RunNo: 55617						
Client ID: LCSW	Batch ID: 29929	TestNo: E200.8	E200.8	Analysis Date: 1/20/2025	SeqNo: 919225						
Analyte	Result	PQL	SPK value	SPK Ref Val	%REC	LowLimit	HighLimit	RPD Ref Val	%RPD	RPDLimit	Qual
Lead	104	0.500	100	0	104	85	115				

Sample ID: 25010654-01AMS	SampType: MS	TestCode: LEAD_DW	Units: ppb	Prep Date: 1/17/2025	RunNo: 55617						
Client ID: 24-167G.1	Batch ID: 29929	TestNo: E200.8	E200.8	Analysis Date: 1/20/2025	SeqNo: 919227						
Analyte	Result	PQL	SPK value	SPK Ref Val	%REC	LowLimit	HighLimit	RPD Ref Val	%RPD	RPDLimit	Qual
Lead	98.7	0.500	100	0.0860	98.6	70	130				

Sample ID: 25010654-01AMSD	SampType: MSD	TestCode: LEAD_DW	Units: ppb	Prep Date: 1/17/2025	RunNo: 55617						
Client ID: 24-167G.1	Batch ID: 29929	TestNo: E200.8	E200.8	Analysis Date: 1/20/2025	SeqNo: 919228						
Analyte	Result	PQL	SPK value	SPK Ref Val	%REC	LowLimit	HighLimit	RPD Ref Val	%RPD	RPDLimit	Qual
Lead	100	0.500	100	0.0860	99.9	70	130	98.7	1.30	20	

Qualifiers: C1 Sample container temperature is out of limit as specified at testcode  
ND Not Detected at the Reporting Limit

H Holding times for preparation or analysis exceeded  
PL Permit Limit

MI Recovery outside control limits due to Matrix In  
RL Reporting Detection Limit

Original



Neilson Research Corporation  
245 S Grape St  
Medford, OR 97501  
TEL: (541) 770-5678 FAX: (541) 770-2901  
Website: www.nrclabs.com

## Sample Log-In Check List

Client Name: ColemanCreek

Work Order Number: 25010654

RcptNo: 1

Logged by: Ashley Spiegelberg 1/16/2025 1:58:00 PM

Completed By: Danielle Garten 1/17/2025 10:33:40 AM

Reviewed By: Ashley Spiegelberg 1/27/2025 11:25:03 AM

*Am*  
*Danielle Garten*  
*Am*

### Chain of Custody

1. Is Chain of Custody complete? Yes ☒ No ☐ Not Present ☐  
2. How was the sample delivered? Client

### Log In

3. Coolers are present? Yes ☐ No ☐ NA ☒  
4. Shipping container/cooler in good condition? Yes ☒ No ☐  
Custody seals intact on shipping container/cooler? Yes ☐ No ☐ Not Present ☒ NA ☐  
No. Seal Date: Signed By:  
5. Was an attempt made to cool the samples? Yes ☐ No ☐ NA ☒  
6. Were all samples received at a temperature of  $>0^{\circ}\text{C}$  to  $6.0^{\circ}\text{C}$ ? Yes ☐ No ☐ NA ☒  
7. Sample(s) in proper container(s)? Yes ☒ No ☐  
8. Sufficient sample volume for indicated test(s)? Yes ☒ No ☐  
9. Are samples (except VOA and ONG) properly preserved? Yes ☒ No ☐  
10. Was preservative added to bottles? Yes ☐ No ☒ NA ☐  
11. Is the headspace in the VOA vials less than 1/4 inch or 6 mm? Yes ☐ No ☐ No VOA Vials ☒  
12. Were any sample containers received broken? Yes ☐ No ☒  
13. Does paperwork match bottle labels?  
(Note discrepancies on chain of custody) Yes ☒ No ☐  
14. Are matrices correctly identified on Chain of Custody? Yes ☒ No ☐  
15. Is it clear what analyses were requested? Yes ☒ No ☐  
16. Were all holding times able to be met?  
(If no, notify customer for authorization.) Yes ☒ No ☐

### Special Handling (if applicable)

17. Was client notified of all discrepancies with this order? Yes ☐ No ☐ NA ☒

Person Notified:  Date   
By Whom:  Via: ☐ eMail ☐ Phone ☐ Fax ☐ In Person  
Regarding:   
Client Instructions:

18. Additional remarks:

### Cooler Information

Cooler No	Temp $^{\circ}\text{C}$	Condition	Seal Intact	Seal No	Seal Date	Signed By
-----------	-------------------------	-----------	-------------	---------	-----------	-----------



**Section A  
Required Client Information**

Company:	Coleman Creek Consulting
Address:	810 Leonard St Ashland, OR 97520
Email:	<a href="mailto:fawbro@ccountry.net">fawbro@ccountry.net</a>
Phone:	Fax:
Collected By (Print):	<i>Steve Schaefer</i>
Collected By (Sign):	
Email Report <input type="checkbox"/>	Mail Report <input type="checkbox"/> Fax Report <input type="checkbox"/>

**Section B  
Required Project Information**

Project Name:	<i>District Office</i>
Project Number:	<i>24-1679</i>
Report To:	Dave Fawcett
Copy To:	

**Section C  
Invoice Information**

Attention:	
Company Name:	
Address:	
P.O. #	

**Section D  
Rush Status (Subject to Scheduling)**

<input type="checkbox"/> Standard: 10 Business Days
<input type="checkbox"/> Priority: 5 Business Days (List x 1.50)
<input type="checkbox"/> Express: 3 Business Days (List x 1.75)
<input type="checkbox"/> Rush: 2 Business Days (List x 2.00)
<input type="checkbox"/> Rush: 1 Business Day (List x 2.50)
<input type="checkbox"/> Rush: Same Day (List x 3.00)

Authorized ☐ Yes ☐ No

**Section E  
Sample Information**

Sample ID	Comp/Grab	Matrix*	Date Collected	Time Collected	No. of Containers	Analysis Requested										Remarks / Field Data	NRC Sample # Use Only)	(Lab
						Total												
24-1679.1-16	Grab	DW	1-16-25	See Below	16		X								01-16			

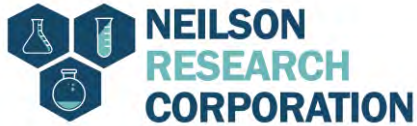

Neilson Research Corporation  
245 S Grape St  
Medford, OR 97501  
TEL: (541) 770-5678 FAX: (541) 770-2901  
Website: [www.nrclabs.com](http://www.nrclabs.com)

January 27, 2025

Dave Fawcett  
Coleman Creek Consulting  
810 Leonard St  
Ashland, OR 97520  
TEL: (541) 535-7108  
FAX (541) 535-8795

RE: 24-167G Maint/Bus

Order No.: 25010660

Dear Dave Fawcett:

Neilson Research Corporation received 12 sample(s) on 1/16/2025 for the analyses presented in the following report.

The results relate only to the parameters tested or to the sample as received by the laboratory. This report shall not be reproduced except in full, without the written approval of Neilson Research Corporation. If you have any questions regarding these test results, please feel free to call.

Sincerely,  
Neilson Research Corporation

Tamra Schmedemann  
Senior Project Manager  
245 S Grape St  
Medford, OR 97501



Original



Neilson Research Corporation  
245 S Grape St  
Medford, OR 97501  
TEL: (541) 770-5678 FAX: (541) 770-2901  
Website: [www.nrclabs.com](http://www.nrclabs.com)

## Case Narrative

WO#: 25010660  
Date: 1/27/2025

---

**CLIENT:** Coleman Creek Consulting

**Project:** 24-167G Maint/Bus

---

The analyses were performed according to the guidelines in the Neilson Research Corporation Quality Assurance Program. This report contains analytical results for the sample(s) as received by the laboratory.

Neilson Research Corporation certifies that this report is in compliance with the requirements of NELAP. No unusual difficulties were experienced during analysis of this batch except as noted below or qualified with data flags on the reports.

---

Original





Neilson Research Corporation  
245 S Grape St  
Medford, OR 97501  
TEL: (541) 770-5678 FAX: (541) 770-2901  
Website: www.nrclabs.com

## Analytical Report

WO#: 25010660

Date Reported: 1/27/2025

Coleman Creek Consulting  
810 Leonard St  
Ashland, OR 97520

**Lab Order:** 25010660  
**Received Date:** 1/16/2025 1:53:00 PM  
**Reported Date:** 1/27/2025 3:13:21 PM

Sample Information:

**Lab ID:** 25010660-01 **Client Sample ID:** 24-167G.17  
**Collection Date:** 1/16/2025 5:08:00 AM **Collected By:** Darin Martins  
**Matrix:** Drinking Water **Sample Location:** Maint 1st Floor RR Sink

Trace Metals by EPA 200.8 ICP-MS								Analyst: KN
Analyses	Result	Qual	MRL	Units	DF	Date Analyzed	MCL	NELAP Status
Lead	0.915		0.500	ppb	1	1/20/2025	15.0	A

**Lab ID:** 25010660-02 **Client Sample ID:** 24-167G.18  
**Collection Date:** 1/16/2025 5:08:00 AM **Collected By:** Darin Martins  
**Matrix:** Drinking Water **Sample Location:** Maint 1st Floor Conf Sink

Trace Metals by EPA 200.8 ICP-MS								Analyst: KN
Analyses	Result	Qual	MRL	Units	DF	Date Analyzed	MCL	NELAP Status
Lead	ND		0.500	ppb	1	1/20/2025	15.0	A

**Lab ID:** 25010660-03 **Client Sample ID:** 24-167G.19  
**Collection Date:** 1/16/2025 5:10:00 AM **Collected By:** Darin Martins  
**Matrix:** Drinking Water **Sample Location:** Maint 2nd Floor RR Sink

Trace Metals by EPA 200.8 ICP-MS								Analyst: KN
Analyses	Result	Qual	MRL	Units	DF	Date Analyzed	MCL	NELAP Status
Lead	ND		0.500	ppb	1	1/20/2025	15.0	A

QUALIFIERS	*	Value exceeds Maximum or Minimum Contaminant Level.	C1	Sample container temperature is out of limit as specified at testcode
	E	Value above quantitation range	H	Holding times for preparation or analysis exceeded
	J	Analyte detected below quantitation limits	MI	Recovery outside control limits due to Matrix Interference
	ND	Not Detected at the Reporting Limit	PL	Permit Limit
	PRE	Percent RE exceeds the Limit	R	RPD outside accepted recovery limits

**NELAP** A Accredited in accordance with NELAP ORELAP 100016, OR-028

Original



Neilson Research Corporation  
245 S Grape St  
Medford, OR 97501  
TEL: (541) 770-5678 FAX: (541) 770-2901  
Website: www.nrclabs.com

## Analytical Report

WO#: 25010660

Date Reported: 1/27/2025

Coleman Creek Consulting  
810 Leonard St  
Ashland, OR 97520

**Lab Order:** 25010660  
**Received Date:** 1/16/2025 1:53:00 PM  
**Reported Date:** 1/27/2025 3:13:21 PM

Sample Information:

**Lab ID:** 25010660-04 **Client Sample ID:** 24-167G.20  
**Collection Date:** 1/16/2025 5:10:00 AM **Collected By:** Darin Martins  
**Matrix:** Drinking Water **Sample Location:** Maint 2nd Floor Conf Sink

Trace Metals by EPA 200.8 ICP-MS								Analyst: KN
Analyses	Result	Qual	MRL	Units	DF	Date Analyzed	MCL	NELAP Status
Lead	ND		0.500	ppb	1	1/20/2025	15.0	A

**Lab ID:** 25010660-05 **Client Sample ID:** 24-167G.21  
**Collection Date:** 1/16/2025 5:14:00 AM **Collected By:** Darin Martins  
**Matrix:** Drinking Water **Sample Location:** Bus 1st Floor RR at Office Sink

Trace Metals by EPA 200.8 ICP-MS								Analyst: KN
Analyses	Result	Qual	MRL	Units	DF	Date Analyzed	MCL	NELAP Status
Lead	3.20		0.500	ppb	1	1/20/2025	15.0	A

**Lab ID:** 25010660-06 **Client Sample ID:** 24-167G.22  
**Collection Date:** 1/16/2025 5:15:00 AM **Collected By:** Darin Martins  
**Matrix:** Drinking Water **Sample Location:** Bus Mechanics Locker Sink

Trace Metals by EPA 200.8 ICP-MS								Analyst: KN
Analyses	Result	Qual	MRL	Units	DF	Date Analyzed	MCL	NELAP Status
Lead	ND		0.500	ppb	1	1/20/2025	15.0	A

QUALIFIERS	*	Value exceeds Maximum or Minimum Contaminant Level.	C1	Sample container temperature is out of limit as specified at testcode
	E	Value above quantitation range	H	Holding times for preparation or analysis exceeded
	J	Analyte detected below quantitation limits	MI	Recovery outside control limits due to Matrix Interference
	ND	Not Detected at the Reporting Limit	PL	Permit Limit
	PRE	Percent RE exceeds the Limit	R	RPD outside accepted recovery limits

NELAP A Accredited in accordance with NELAP ORELAP 100016, OR-028

Original



Neilson Research Corporation  
245 S Grape St  
Medford, OR 97501  
TEL: (541) 770-5678 FAX: (541) 770-2901  
Website: www.nrclabs.com

## Analytical Report

WO#: 25010660

Date Reported: 1/27/2025

Coleman Creek Consulting  
810 Leonard St  
Ashland, OR 97520

**Lab Order:** 25010660  
**Received Date:** 1/16/2025 1:53:00 PM  
**Reported Date:** 1/27/2025 3:13:21 PM

Sample Information:

**Lab ID:** 25010660-07 **Client Sample ID:** 24-167G.23  
**Collection Date:** 1/16/2025 5:15:00 AM **Collected By:** Darin Martins  
**Matrix:** Drinking Water **Sample Location:** Bus Mechanics Locker RR Sink

Trace Metals by EPA 200.8 ICP-MS								Analyst: KN
Analyses	Result	Qual	MRL	Units	DF	Date Analyzed	MCL	NELAP Status
Lead	ND		0.500	ppb	1	1/20/2025	15.0	A

**Lab ID:** 25010660-08 **Client Sample ID:** 24-167G.24  
**Collection Date:** 1/16/2025 5:16:00 AM **Collected By:** Darin Martins  
**Matrix:** Drinking Water **Sample Location:** Bus Mechanics Outside Ofc Sink

Trace Metals by EPA 200.8 ICP-MS								Analyst: KN
Analyses	Result	Qual	MRL	Units	DF	Date Analyzed	MCL	NELAP Status
Lead	ND		0.500	ppb	1	1/20/2025	15.0	A

**Lab ID:** 25010660-09 **Client Sample ID:** 24-167G.25  
**Collection Date:** 1/16/2025 5:17:00 AM **Collected By:** Darin Martins  
**Matrix:** Drinking Water **Sample Location:** Bus 2nd Floor Break Rm Sink

Trace Metals by EPA 200.8 ICP-MS								Analyst: KN
Analyses	Result	Qual	MRL	Units	DF	Date Analyzed	MCL	NELAP Status
Lead	ND		0.500	ppb	1	1/20/2025	15.0	A

QUALIFIERS	*	Value exceeds Maximum or Minimum Contaminant Level.	C1	Sample container temperature is out of limit as specified at testcode
	E	Value above quantitation range	H	Holding times for preparation or analysis exceeded
	J	Analyte detected below quantitation limits	MI	Recovery outside control limits due to Matrix Interference
	ND	Not Detected at the Reporting Limit	PL	Permit Limit
	PRE	Percent RE exceeds the Limit	R	RPD outside accepted recovery limits

NELAP A Accredited in accordance with NELAP ORELAP 100016, OR-028

Original



Neilson Research Corporation  
245 S Grape St  
Medford, OR 97501  
TEL: (541) 770-5678 FAX: (541) 770-2901  
Website: www.nrclabs.com

## Analytical Report

WO#: 25010660

Date Reported: 1/27/2025

Coleman Creek Consulting  
810 Leonard St  
Ashland, OR 97520

**Lab Order:** 25010660  
**Received Date:** 1/16/2025 1:53:00 PM  
**Reported Date:** 1/27/2025 3:13:21 PM

Sample Information:

**Lab ID:** 25010660-10 **Client Sample ID:** 24-167G.26  
**Collection Date:** 1/16/2025 5:17:00 AM **Collected By:** Darin Martins  
**Matrix:** Drinking Water **Sample Location:** Bus 2nd Floor RR Sink

Trace Metals by EPA 200.8 ICP-MS								Analyst: KN
Analyses	Result	Qual	MRL	Units	DF	Date Analyzed	MCL	NELAP Status
Lead	ND		0.500	ppb	1	1/20/2025	15.0	A

**Lab ID:** 25010660-11 **Client Sample ID:** 24-167G.27  
**Collection Date:** 1/16/2025 5:19:00 AM **Collected By:** Darin Martins  
**Matrix:** Drinking Water **Sample Location:** IT Dept Breakroom Sink

Trace Metals by EPA 200.8 ICP-MS								Analyst: KN
Analyses	Result	Qual	MRL	Units	DF	Date Analyzed	MCL	NELAP Status
Lead	ND		0.500	ppb	1	1/20/2025	15.0	A

**Lab ID:** 25010660-12 **Client Sample ID:** 24-167G.28  
**Collection Date:** 1/16/2025 5:19:00 AM **Collected By:** Darin Martins  
**Matrix:** Drinking Water **Sample Location:** IT RR Sink

Trace Metals by EPA 200.8 ICP-MS								Analyst: KN
Analyses	Result	Qual	MRL	Units	DF	Date Analyzed	MCL	NELAP Status
Lead	ND		0.500	ppb	1	1/20/2025	15.0	A

QUALIFIERS	*	Value exceeds Maximum or Minimum Contaminant Level.	C1	Sample container temperature is out of limit as specified at testcode
	E	Value above quantitation range	H	Holding times for preparation or analysis exceeded
	J	Analyte detected below quantitation limits	MI	Recovery outside control limits due to Matrix Interference
	ND	Not Detected at the Reporting Limit	PL	Permit Limit
	PRE	Percent RE exceeds the Limit	R	RPD outside accepted recovery limits

**NELAP** A Accredited in accordance with NELAP ORELAP 100016, OR-028

Original



Neilson Research Corporation  
245 S Grape St  
Medford, OR 97501  
TEL: (541) 770-5678 FAX: (541) 770-2901  
Website: www.nrclabs.com

## QC SUMMARY REPORT

WO#: 25010660  
27-Jan-25

Client: Coleman Creek Consulting

Project: 24-167G Maint/Bus

TestCode: LEAD\_DW

Sample ID: MB-29947	SampType: MBLK	TestCode: LEAD_DW	Units: ppb	Prep Date: 1/20/2025	RunNo: 55617						
Client ID: PBW	Batch ID: 29947	TestNo: E200.8	E200.8	Analysis Date: 1/20/2025	SeqNo: 919159						
Analyte	Result	PQL	SPK value	SPK Ref Val	%REC	LowLimit	HighLimit	RPD Ref Val	%RPD	RPDLimit	Qual
Lead	ND	0.500									

Sample ID: <b>LCS-29947</b>	SampType: <b>LCS</b>	TestCode: <b>LEAD_DW</b>	Units: <b>ppb</b>	Prep Date: <b>1/20/2025</b>	RunNo: <b>55617</b>						
Client ID: <b>LCSW</b>	Batch ID: <b>29947</b>	TestNo: <b>E200.8</b>	<b>E200.8</b>	Analysis Date: <b>1/20/2025</b>	SeqNo: <b>919160</b>						
Analyte	Result	PQL	SPK value	SPK Ref Val	%REC	LowLimit	HighLimit	RPD Ref Val	%RPD	RPDLimit	Qual
Lead	102	0.500	100	0	102	85	115				

Sample ID: 25010679-01AMS	SampType: MS	TestCode: LEAD_DW	Units: ppb	Prep Date: 1/20/2025	RunNo: 55617						
Client ID: BatchQC	Batch ID: 29947	TestNo: E200.8	E200.8	Analysis Date: 1/20/2025	SeqNo: 919162						
Analyte	Result	PQL	SPK value	SPK Ref Val	%REC	LowLimit	HighLimit	RPD Ref Val	%RPD	RPDLimit	Qual
Lead	98.6	0.500	100	0.608	98.0	70	130				

Sample ID: 25010679-01AMSD	SampType: MSD	TestCode: LEAD_DW	Units: ppb	Prep Date: 1/20/2025	RunNo: 55617						
Client ID: BatchQC	Batch ID: 29947	TestNo: E200.8	E200.8	Analysis Date: 1/20/2025	SeqNo: 919163						
Analyte	Result	PQL	SPK value	SPK Ref Val	%REC	LowLimit	HighLimit	RPD Ref Val	%RPD	RPDLimit	Qual
Lead	98.7	0.500	100	0.608	98.1	70	130	98.6	0.111	20	

Qualifiers: C1 Sample container temperature is out of limit as specified at testcode  
ND Not Detected at the Reporting Limit

H Holding times for preparation or analysis exceeded  
PL Permit Limit

MI Recovery outside control limits due to Matrix In  
RL Reporting Detection Limit

Original



Neilson Research Corporation  
245 S Grape St  
Medford, OR 97501  
TEL: (541) 770-5678 FAX: (541) 770-2901  
Website: www.nrclabs.com

## QC SUMMARY REPORT

WO#: 25010660  
27-Jan-25

Client: Coleman Creek Consulting

Project: 24-167G Maint/Bus

TestCode: LEAD\_DW

Sample ID: <b>MB-29946</b>		SampType: <b>MBLK</b>		TestCode: <b>LEAD_DW</b>		Units: <b>ppb</b>		Prep Date: <b>1/20/2025</b>			RunNo: <b>55617</b>		
Client ID: <b>PBW</b>		Batch ID: <b>29946</b>		TestNo: <b>E200.8</b>		<b>E200.8</b>		Analysis Date: <b>1/20/2025</b>			SeqNo: <b>919176</b>		
Analyte		Result		PQL	SPK value	SPK Ref Val	%REC	LowLimit	HighLimit	RPD Ref Val	%RPD	RPDLimit	Qual

Lead	ND	0.500									
------	----	-------	--	--	--	--	--	--	--	--	--

Sample ID: <b>LCS-29946</b>		SampType: <b>LCS</b>		TestCode: <b>LEAD_DW</b>		Units: <b>ppb</b>		Prep Date: <b>1/20/2025</b>			RunNo: <b>55617</b>		
Client ID: <b>LCSW</b>		Batch ID: <b>29946</b>		TestNo: <b>E200.8</b>		<b>E200.8</b>		Analysis Date: <b>1/20/2025</b>			SeqNo: <b>919177</b>		
Analyte		Result		PQL	SPK value	SPK Ref Val	%REC	LowLimit	HighLimit	RPD Ref Val	%RPD	RPDLimit	Qual

Lead	103	0.500	100	0	103	85	115				
------	-----	-------	-----	---	-----	----	-----	--	--	--	--

Sample ID: <b>25010692-01AMS</b>	SampType: <b>MS</b>	TestCode: <b>LEAD_DW</b>	Units: <b>ppb</b>	Prep Date: <b>1/20/2025</b>	RunNo: <b>55617</b>						
Client ID: <b>BatchQC</b>	Batch ID: <b>29946</b>	TestNo: <b>E200.8</b>	<b>E200.8</b>	Analysis Date: <b>1/20/2025</b>	SeqNo: <b>919194</b>						
Analyte	Result	PQL	SPK value	SPK Ref Val	%REC	LowLimit	HighLimit	RPD Ref Val	%RPD	RPDLimit	Qual

Lead	103	0.500	100	2.22	101	70	130				
------	-----	-------	-----	------	-----	----	-----	--	--	--	--

Sample ID: 25010692-01AMSD		SampType: MSD		TestCode: LEAD_DW		Units: ppb		Prep Date: 1/20/2025			RunNo: 55617		
Client ID: BatchQC		Batch ID: 29946		TestNo: E200.8		E200.8		Analysis Date: 1/20/2025			SeqNo: 919195		
Analyte		Result		PQL	SPK value	SPK Ref Val	%REC	LowLimit	HighLimit	RPD Ref Val	%RPD	RPDLimit	Qual

Lead	102	0.500	100	2.22	99.5	70	130	103	0.991	20	
------	-----	-------	-----	------	------	----	-----	-----	-------	----	--

Qualifiers: C1 Sample container temperature is out of limit as specified at testcode  
ND Not Detected at the Reporting Limit

H Holding times for preparation or analysis exceeded  
PL Permit Limit

MI Recovery outside control limits due to Matrix In  
RL Reporting Detection Limit

Original



Neilson Research Corporation  
245 S Grape St  
Medford, OR 97501  
TEL: (541) 770-5678 FAX: (541) 770-2901  
Website: www.nrclabs.com

## Sample Log-In Check List

Client Name: ColemanCreek

Work Order Number: 25010660

RcptNo: 1

Logged by: Ashley Spiegelberg 1/16/2025 1:53:00 PM

Completed By: Danielle Garten 1/17/2025 10:31:16 AM

Reviewed By: Jordan Diemer 1/27/2025 3:07:55 PM

*Am*  
*Danielle Garten*  
*Jordan Diemer*

### Chain of Custody

1. Is Chain of Custody complete? Yes ☒ No ☐ Not Present ☐  
2. How was the sample delivered? Client

### Log In

3. Coolers are present? Yes ☐ No ☐ NA ☒  
4. Shipping container/cooler in good condition? Yes ☒ No ☐  
Custody seals intact on shipping container/cooler? Yes ☐ No ☐ Not Present ☒ NA ☐  
No. Seal Date: Signed By:  
5. Was an attempt made to cool the samples? Yes ☐ No ☐ NA ☒  
6. Were all samples received at a temperature of >0° C to 6.0°C Yes ☐ No ☐ NA ☒  
7. Sample(s) in proper container(s)? Yes ☒ No ☐  
8. Sufficient sample volume for indicated test(s)? Yes ☒ No ☐  
9. Are samples (except VOA and ONG) properly preserved? Yes ☒ No ☐  
10. Was preservative added to bottles? Yes ☒ No ☐ NA ☐  
HNO3 pH<2  
11. Is the headspace in the VOA vials less than 1/4 inch or 6 mm? Yes ☐ No ☐ No VOA Vials ☒  
12. Were any sample containers received broken? Yes ☐ No ☒  
13. Does paperwork match bottle labels? Yes ☒ No ☐  
(Note discrepancies on chain of custody)  
14. Are matrices correctly identified on Chain of Custody? Yes ☒ No ☐  
15. Is it clear what analyses were requested? Yes ☒ No ☐  
16. Were all holding times able to be met? Yes ☒ No ☐  
(If no, notify customer for authorization.)

### Special Handling (if applicable)

17. Was client notified of all discrepancies with this order? Yes ☐ No ☐ NA ☒

Person Notified:  Date   
By Whom:  Via: ☐ eMail ☐ Phone ☐ Fax ☐ In Person  
Regarding:   
Client Instructions:

18. Additional remarks:

### Cooler Information

Cooler No	Temp °C	Condition	Seal Intact	Seal No	Seal Date	Signed By
-----------	---------	-----------	-------------	---------	-----------	-----------



# Chain of Custody Record

This Chain of Custody is a LEGAL DOCUMENT and must be filled out accurately.

Section A Required Client Information	Section B Required Project Information	Section C Invoice Information	Section D Rush Status (Subject to Scheduling)																																																						
Company: Coleman Creek Consulting	Project Name: <u>Maint. / Bus</u>	Attention:	<input checked="" type="checkbox"/> Standard: 10 Business Days <input type="checkbox"/> Priority: 5 Business Days (List x 1.50) <input type="checkbox"/> Express: 3 Business Days (List x 1.75) <input type="checkbox"/> Rush: 2 Business Days (List x 2.00) <input type="checkbox"/> Rush: 1 Business Day (List x 2.50) <input type="checkbox"/> Rush: Same Day (List x 3.00)																																																						
Address: 810 Leonard St	Project Number: <u>24-1676</u>	Company Name:																																																							
Ashland, OR 97520	Report To: Dave Fawcett	Address:																																																							
Email: <u>fawbro@ccountry.net</u>	Copy To:	P.O. #																																																							
Phone: Fax:																																																									
Collected By (Print): <u>Darin Martins</u>	<div style="border: 1px solid black; padding: 5px;"> <b>Analysis Requested</b> <table border="1" style="width:100%; border-collapse: collapse;"> <tr> <th>No. of Containers</th> <th></th> <th></th> <th></th> <th></th> <th></th> <th></th> <th></th> <th></th> <th></th> <th></th> <th></th> <th></th> <th></th> <th></th> <th></th> <th></th> <th></th> </tr> <tr> <td></td> <td></td> <td></td> <td></td> <td></td> <td></td> <td></td> <td></td> <td></td> <td></td> <td></td> <td></td> <td></td> <td></td> <td></td> <td></td> <td></td> <td></td> </tr> <tr> <td></td> <td></td> <td></td> <td></td> <td></td> <td></td> <td></td> <td></td> <td></td> <td></td> <td></td> <td></td> <td></td> <td></td> <td></td> <td></td> <td></td> <td></td> </tr> </table> </div>		No. of Containers																																																						<div style="border: 1px solid black; padding: 5px;">           Authorized <input type="checkbox"/> Yes <input type="checkbox"/> No         </div>
No. of Containers																																																									
Collected By (Sign):																																																									
Email Report <input type="checkbox"/> Mail Report <input type="checkbox"/> Fax Report <input type="checkbox"/>																																																									

Section E Sample Information					No. of Containers	Total Pb											NRC Workorder # (Lab Use Only) 25010660	
Sample ID	Comp/Grab	Matrix*	Date Collected	Time Collected													Remarks / Field Data	NRC Sample # Use Only)
24-1676, 17-28	Grab	DW	1-16-24	See Below	12	X												01-12

\*Matrix: DW - Drinking Water WW - Wastewater W - Water S - Soil/Solid SL - Sludge O - Oil WP - Wipe OT - Other

Section F Relinquish/Receive				Section G Lab Use Only	
Relinquished By: <u>David Fawcett</u>	Sign	Print	Date	Time	Temp: <u>Amb</u> IR Therm ID: <u>NA</u>
Received By:					≤6°C: <input type="checkbox"/> Yes <input type="checkbox"/> No <u>NA</u>
Relinquished By:					Received on Ice: <input type="checkbox"/> Yes <input type="checkbox"/> No
Received By:					Number of Bottles Received: <u>12</u>
Relinquished By:					pH Checked: <input checked="" type="checkbox"/>
Received By Laboratory: <u>Ashley Spreyberg</u>			<u>1/16/25</u>	<u>13:53</u>	COC Seals Intact: <input type="checkbox"/> Yes <input type="checkbox"/> No <u>NA</u>
<u>See site sample record sheet attached for times</u>					Field Blank Included: <input type="checkbox"/> Yes <input type="checkbox"/> No <u>NA</u>
					Received Via <input type="checkbox"/> UPS <input type="checkbox"/> FedEx <input type="checkbox"/> Other <input checked="" type="checkbox"/> Hand
Payment: <input checked="" type="checkbox"/> Invoice <input type="checkbox"/> Cash <input type="checkbox"/> VISA, M/C <input type="checkbox"/> Check # <input type="checkbox"/> Amount <input type="checkbox"/>					