

Coleman Creek Consulting, Inc.

DRINKING WATER LEAD SAMPLING

OF

CHILOQUIN JR./SR. HIGH SCHOOL

300 E. ELM STREET, CHILOQUIN, OREGON

FOR

KLAMATH COUNTY SCHOOL DISTRICT

INTRODUCTION

Coleman Creek Consulting, Inc. (CCC) was retained by Klamath County School District (KCSD) to perform representative lead drinking water sampling of Chiloquin Jr./Sr. High School (Chiloquin HS) at the above address. The purpose of the lead drinking water sampling was to determine the concentration of lead in representative drinking water sources and compare with regulatory standards. In 2017, Education Service Districts were required to adopt a Healthy and Safe Schools Plan, including provisions for testing and reducing exposure to elevated levels of lead in water used for drinking and food preparation.

LEAD DRINKING WATER SAMPLING REQUIREMENTS

Guidelines for sampling lead in water were established by the Oregon Health Authority. Water sampling is to occur after water sits overnight in the pipes without being used, and must be sampled after a day occupied by students or building occupants. All water sources are to be sampled, with the exception of water used for heating, sanitation, irrigation, and science sinks for grades 6 and up with non-potable water signs. Initial testing is required to be performed by 2020, and every 6 years thereafter, according to a testing schedule determined by the Oregon Department of Education.

SAMPLE LOCATION DETERMINATION/SAMPLE PREP

David W. Fawcett of CCC contacted Lloyd Rogers, Head Custodian at Chiloquin ES, and discussed the objectives of the lead drinking water program. Mr. Rogers reviewed the School buildings for water sources and identified by type on a building floor plan. Mr. Fawcett and Mr. Rogers discussed the drinking water sources by phone, and Mr. Fawcett created a Site Sample Record Sheet describing each drinking water source by type and location. Mr. Fawcett identified each source by number (CH1-CH54), and identified each source number on a floor plan diagram of the school building. There was no Sample CH15. Mr. Fawcett delivered the following sampling materials to Mr. Rogers October 25, 2023: Numbered sample containers, Site Sample Record Sheet filled out with Sample Number, Sample Type, and Location. Mr. Rogers was instructed in proper sampling technique, including sampling prior to water system use by other school occupants, fill sample container immediately from faucet opening, and recording time of water sampling on the Site Sample Record Sheets (pages 3-5).

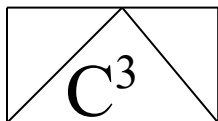

Coleman Creek Consulting, Inc.

DRINKING WATER SAMPLING

Mr. Rogers collected lead drinking water samples from the drinking water sources identified in Chiloquin Jr./Sr. High School October 26, 2023. See Site Sample Record Sheets (pages 3-5) for a description of the drinking water sources sampled. See Drinking Water Sample Location Diagram in Appendix A for a visual review of all drinking water sample locations. The drinking water samples were collected in the early morning, ensuring that the sample source had not been in use since the previous day. The samples were placed in a cooler. Mr. Fawcett picked up the samples collected by Mr. Rogers October 26, 2023, and transported to Neilson Research Corporation in Medford, Oregon.

DRINKING WATER LEAD RESULTS AND TESTING SUMMARY SHEETS

The fifty-three (53) drinking water samples collected were analyzed for lead using EPA Method 200.8. See Neilson Research Corporation Analytical Report in Appendix B. Drinking Water Testing Summary Sheets (pages 6-8) indicate the lead in drinking water concentrations for the fifty-three (53) samples collected from the Chiloquin Jr./Sr. High School were reported ranging from <0.515 to 8.72 parts per billion (ppb).

CONCLUSIONS

Fifty-three (53) drinking water samples were collected from drinking water sources at the Chiloquin Jr./Sr. High School Building prior to use that day by building occupants, and after a day the facility was occupied. The lead concentrations reported were all below the 15 ppb lead action level in water.

RECOMMENDATIONS

Coleman Creek Consulting, Inc. recommends continuing the lead drinking water sampling schedule in the future. Coleman Creek Consulting, Inc. appreciates the opportunity to continue to perform environmental sampling and consulting services to Klamath County School District.

David W. Fawcett
Director of Consulting Services

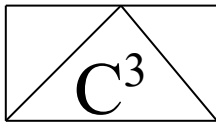

Coleman Creek Consulting, Inc.

DRINKING WATER SITE SAMPLE RECORD SHEET

BUILDING: Chiloquin High School
ADDRESS: 300 E. Elm Street
Chiloquin, Oregon

DATE: 10-26-23
SAMPLER: Lloyd Rogers

SAMPLE #	SAMPLE TYPE	LOCATION	TIME
23-120G.CH1	DW	Cafeteria Drinking Fountain	0548
23-120G.CH2	DW	Cafeteria Drinking Fountain Bottle Filler	0548
23-120G.CH3	DW	Girl's Hall RR at Room D-1 Left Sink	0552
23-120G.CH4	DW	Girl's Hall RR at Room D-1 Middle Sink	0552
23-120G.CH5	DW	Girl's Locker Room Sink	0631
23-120G.CH6	DW	Boy's Hall RR at Room D-1 Left Sink	0555
23-120G.CH7	DW	Boy's Hall RR at Room D-1 Middle Sink	0555
23-120G.CH8	DW	Boy's Hall RR at Room D-1 Right Sink	0555
23-120G.CH9	DW	Hall Drinking Fountain at Room D-1	0557
23-120G.CH10	DW	Office Break Room Sink	0558
23-120G.CH11	DW	Office RR Left Sink	0559
23-120G.CH12	DW	Office RR Right Sink	0559
23-120G.CH13	DW	Girl's RR at Room B-1 Left Sink	0601
23-120G.CH14	DW	Girl's RR at Room B-1 Middle Sink	0601
23-120G.CH16	DW	Room A-3 Left Sink	0608
23-120G.CH17	DW	Room A-3 Left Middle Sink	0608
23-120G.CH18	DW	Room A-3 Left Middle Middle Sink	0608
23-120G.CH19	DW	Room A-3 Middle Sink	0608
23-120G.CH20	DW	Room A-3 Right Middle Middle Sink	0609

Comments: DW = Drinking Water RR = Restroom R = Right L = Left RM = Right Middle
LM = Left Middle M = Middle

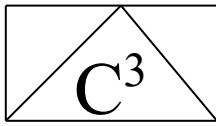

Coleman Creek Consulting, Inc.

DRINKING WATER SITE SAMPLE RECORD SHEET

BUILDING: Chiloquin High School
ADDRESS: 300 E. Elm Street
Chiloquin, Oregon

DATE: 10-26-23
SAMPLER: Lloyd Rogers

SAMPLE #	SAMPLE TYPE	LOCATION	TIME
23-120G.CH21	DW	Room A-3 Right Middle Sink	0609
23-120G.CH22	DW	Room A-3 Right Sink	0609
23-120G.CH23	DW	Hall Drinking Fountain at Room A-3	0610
23-120G.CH24	DW	Room A-4 Left Sink	0615
23-120G.CH25	DW	Room A-4 Left Middle Sink	0615
23-120G.CH26	DW	Room A-4 Left Middle Middle Sink	0616
23-120G.CH27	DW	Room A-4 Middle Sink	0616
23-120G.CH28	DW	Room A-4 Right Middle Middle Sink	0616
23-120G.CH29	DW	Room A-4 Right Middle Sink	0616
23-120G.CH30	DW	Room A-4 Right Sink	0617
23-120G.CH31	DW	Room A-5 Left Sink	0619
23-120G.CH32	DW	Room A-5 Middle Sink	0619
23-120G.CH33	DW	Room A-5 Right Sink	0621
23-120G.CH34	DW	Boy's Hall RR at Room B-5, Left Sink	0623
23-120G.CH35	DW	Boy's Hall RR at Room B-5, Middle Sink	0623
23-120G.CH36	DW	Boy's Hall RR at Room B-5, Right Sink	0623
23-120G.CH37	DW	Hall Drinking Fountain at Courtyard	0624
23-120G.CH38	DW	Boy's Locker Room Drinking Fountain	0626
23-120G.CH39	DW	Boy's Locker Room Left Sink	0626
23-120G.CH40	DW	Boy's Locker Room Right Sink	0626

Comments: DW = Drinking Water RR = Restroom R = Right L = Left RM = Right Middle
LM = Left Middle M = Middle

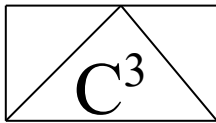

Coleman Creek Consulting, Inc.

DRINKING WATER SITE SAMPLE RECORD SHEET

BUILDING: Chiloquin High School
ADDRESS: 300 E. Elm Street
Chiloquin, Oregon

DATE: 10-26-23
SAMPLER: Lloyd Rogers

SAMPLE #	SAMPLE TYPE	LOCATION	TIME
23-120G.CH41	DW	Gym Drinking Fountain	0628
23-120G.CH42	DW	Girl's Locker Room Drinking Fountain	0630
23-120G.CH43	DW	Hall Drinking Fountain at Girl's Locker Room	0632
23-120G.CH44	DW	Hall DF Bottle Filler at Girl's Locker Room	0632
23-120G.CH45	DW	Big Gym Bldg Girl's Locker Drinking Fountain	0926
23-120G.CH46	DW	Big Gym Bldg Girl's Locker Left Sink	0928
23-120G.CH47	DW	Big Gym Bldg Girl's Locker Right Sink	0928
23-120G.CH48	DW	Big Gym Bldg Boy's Locker Drinking Fountain	0929
23-120G.CH49	DW	Big Gym Bldg Boy's Locker Left Sink	0929
23-120G.CH50	DW	Big Gym Bldg Boy's Locker Right Sink	0929
23-120G.CH51	DW	Big Gym Bldg Front Entry Sink	0931
23-120G.CH52	DW	Big Gym Bldg Front Entry RR Sink	0932
23-120G.CH53	DW	Big Gym Bldg Upper Front RR Left Sink	0934
23-120G.CH54	DW	Big Gym Bldg Upper Front RR Right Sink	0934

Comments: DW = Drinking Water RR = Restroom R = Right L = Left RM = Right Middle
LM = Left Middle M = Middle

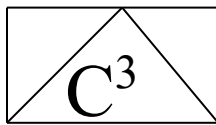

Coleman Creek Consulting, Inc.

DRINKING WATER TESTING SUMMARY SHEET

DISTRICT NAME: Klamath County School District
DISTRICT ID#: 467
SCHOOL NAME: Chiloquin High School
BUILDING NAME: Chiloquin High School
BUILDING ID#: 20571600

Sample Number	Fixture Location/ Description	Fixture ID#	Test Date	Test Result (ppb)	# Retest	Final Result (ppb)
23-120G.CH1	Cafeteria Drinking Fountain	20571600-001DW	10-26-23	<0.515		<0.515
23-120G.CH2	Cafeteria Drinking Fountain WB	20571600-002WB	10-26-23	<0.515		<0.515
23-120G.CH3	Girl's Hall RR at Room D-1 Left Sink	20571600-003BF	10-26-23	<0.515		<0.515
23-120G.CH4	Girl's Hall RR at Room D-1 Mid Sink	20571600-004BF	10-26-23	<0.515		<0.515
23-120G.CH5	Girl's Locker Room Sink	20571600-005BF	10-26-23	2.40		2.40
23-120G.CH6	Boy's Hall RR at Room D-1 Left Sink	20571600-006BF	10-26-23	0.838		0.838
23-120G.CH7	Boy's Hall RR at Room D-1 Mid Sink	20571600-007BF	10-26-23	0.775		0.775
23-120G.CH8	Boy's Hall RR at Room D-1 R Sink	20571600-008BF	10-26-23	<0.515		<0.515
23-120G.CH9	Hall Drinking Fountain at Room D-1	20571600-009DW	10-26-23	<0.515		<0.515
23-120G.CH10	Office Break Room Sink	20571600-010SF	10-26-23	<0.515		<0.515
23-120G.CH11	Office RR Left Sink	20571600-011BF	10-26-23	3.31		3.31
23-120G.CH12	Office RR Right Sink	20571600-012BF	10-26-23	<0.515		<0.515
23-120G.CH13	Girl's RR at Room B-1 Left Sink	20571600-013BF	10-26-23	<0.515		<0.515
23-120G.CH14	Girl's RR at Room B-1 Middle Sink	20571600-014BF	10-26-23	<0.515		<0.515
23-120G.CH16	Room A-3 Left Sink	20571600-016CF	10-26-23	6.09		6.09
23-120G.CH17	Room A-3 Left Middle Sink	20571600-017CF	10-26-23	8.72		8.72
23-120G.CH18	Room A-3 Left Middle Middle Sink	20571600-018CF	10-26-23	2.74		2.74
23-120G.CH19	Room A-3 Middle Sink	20571600-019CF	10-26-23	1.55		1.55
23-120G.CH20	Room A-3 Right Middle Middle Sink	20571600-020CF	10-26-23	1.82		1.82
23-120G.CH21	Room A-3 Right Middle Sink	20571600-021CF	10-26-23	4.66		4.66
23-120G.CH22	Room A-3 Right Sink	20571600-022CF	10-26-23	5.86		5.86
23-120G.CH23	Hall Drinking Fountain at Room A-3	20571600-023SW	10-26-23	2.51		2.51
23-120G.CH24	Room A-4 Left Sink	20571600-024CF	10-26-23	1.05		1.05
23-120G.CH25	Room A-4 Left Middle Sink	20571600-025CF	10-26-23	2.43		2.43
23-120G.CH26	Room A-4 Left Middle Middle Sink	20571600-026CF	10-26-23	2.17		2.17
23-120G.CH27	Room A-4 Middle Sink	20571600-027CF	10-26-23	7.45		7.45
23-120G.CH28	Room A-4 Right Middle Middle Sink	20571600-028CF	10-26-23	1.28		1.28
23-120G.CH29	Room A-4 Right Middle Sink	20571600-029CF	10-26-23	2.30		2.30
23-120G.CH30	Room A-4 Right Sink	20571600-030CF	10-26-23	0.788		0.788
23-120G.CH31	Room A-5 Left Sink	20571600-031CF	10-26-23	<0.515		<0.515
23-120G.CH32	Room A-5 Middle Sink	20571600-032CF	10-26-23	<0.515		<0.515
23-120G.CH33	Room A-5 Right Sink	20571600-033CF	10-26-23	0.539		0.539

Fixture ID Coding:

Bold Indicates Test Result >15 ppb

DW = Drinking Water Fountain WC = Water Cooler WB = Water Bottle Filler
CF = Classroom Faucet BF = Bathroom Faucet SF = Staff/Office Faucet
KF = Kitchen/Food Prep OS = Outside Spigot OT = Other (Specify)

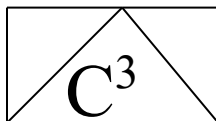

Coleman Creek Consulting, Inc.

DRINKING WATER TESTING SUMMARY SHEET

DISTRICT NAME: Klamath County School District
DISTRICT ID#: 467
SCHOOL NAME: Chiloquin High School
BUILDING NAME: Chiloquin High School
BUILDING ID#: 20571600

Sample Number	Fixture Location/ Description	Fixture ID#	Test Date	Test Result (ppb)	# Retest	Final Result (ppb)
23-120G.CE34	Boy's Hall RR at Rm B-5, Left Sink	20571600-034BF	10-26-23	<0.515		<0.515
23-120G.CE35	Boy's Hall RR at Rm B-5, Mid Sink	20571600-035BF	10-26-23	<0.515		<0.515
23-120G.CE36	Boy's Hall RR at Rm B-5, R Sink	20571600-036BF	10-26-23	<0.515		<0.515
23-120G.CE37	Hall DF at Courtyard	20571600-037DF	10-26-23	<0.515		<0.515
23-120G.CE38	Boy's Locker Room DF	20571600-038DF	10-26-23	<0.515		<0.515
23-120G.CE39	Boy's Locker Room Left Sink	20571600-039BF	10-26-23	<0.515		<0.515
23-120G.CE40	Boy's Locker Room Right Sink	20571600-040BF	10-26-23	<0.515		<0.515
23-120G.CE41	Gym Drinking Fountain	20571600-041DF	10-26-23	<0.515		<0.515
23-120G.CE42	Girl's Locker Room DF	20571600-042DF	10-26-23	1.11		1.11
23-120G.CE43	Hall DF at Girl's Locker Room	20571600-043DF	10-26-23	<0.515		<0.515
23-120G.CE44	Hall DF WB at Girl's Locker Room	20571600-044WB	10-26-23	<0.515		<0.515

Fixture ID Coding:

DW = Drinking Water Fountain WC = Water Cooler WB = Water Bottle Filler
CF = Classroom Faucet BF = Bathroom Faucet SF = Staff/Office Faucet
KF = Kitchen/Food Prep OS = Outside Spigot OT = Other (Specify)

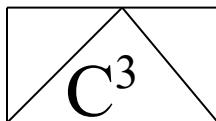

Coleman Creek Consulting, Inc.

DRINKING WATER TESTING SUMMARY SHEET

DISTRICT NAME: Klamath County School District
DISTRICT ID#: 467
SCHOOL NAME: Chiloquin High School
BUILDING NAME: Big Gym
BUILDING ID#: 20571602

Sample Number	Fixture Location/ Description	Fixture ID#	Test Date	Test Result (ppb)	# Retest	Final Result (ppb)
23-120G.CE45	Big Gym Bldg Girl's Locker DF	20571602-045DF	10-26-23	<0.515		<0.515
23-120G.CE46	Big Gym Bldg Girl's Locker L Sink	20571602-046BF	10-26-23	<0.515		<0.515
23-120G.CE47	Big Gym Bldg Girl's Locker R Sink	20571602-047BF	10-26-23	3.10		3.10
23-120G.CE48	Big Gym Bldg Boy's Locker DF	20571602-048DF	10-26-23	1.89		1.89
23-120G.CE49	Big Gym Bldg Boy's Locker L Sink	20571602-049BF	10-26-23	4.09		4.09
23-120G.CE50	Big Gym Bldg Boy's Locker R Sink	20571602-050BF	10-26-23	4.34		4.34
23-120G.CE51	Big Gym Bldg Front Entry Sink	20571602-051CF	10-26-23	<0.515		<0.515
23-120G.CE52	Big Gym Bldg Front Entry RR Sink	20571602-052BF	10-26-23	0.630		0.630
23-120G.CE53	Big Gym Upper Front RR L Sink	20571602-053BF	10-26-23	<0.515		<0.515
23-120G.CE54	Big Gym Upper Front RR R Sink	20571602-054BF	10-26-23	4.09		4.09

Fixture ID Coding:

DW = Drinking Water Fountain WC = Water Cooler WB = Water Bottle Filler
CF = Classroom Faucet BF = Bathroom Faucet SF = Staff/Office Faucet
KF = Kitchen/Food Prep OS = Outside Spigot OT = Other (Specify)

APPENDIX A

**DRINKING WATER SAMPLE LOCATION
DIAGRAM**

CHILOQUIN HIGH SCHOOL

Drinking Water Sample Locations

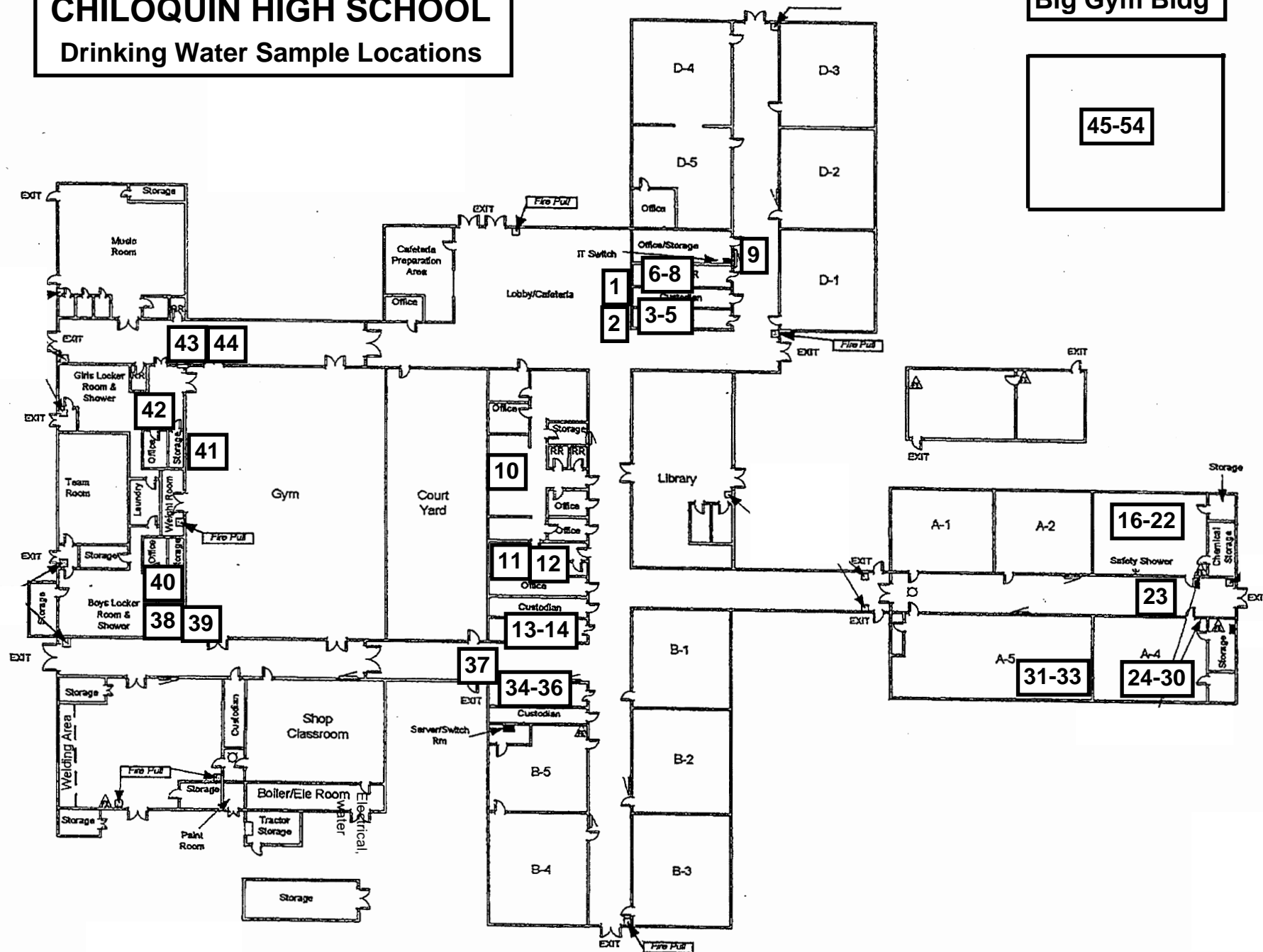

12 = Water Sample Locations

APPENDIX B

NEILSON RESEARCH CORPORATION ANALYTICAL REPORT



Neilson Research Corporation
245 S Grape St
Medford, OR 97501
TEL: (541) 770-5678 FAX: (541) 770-2901
Website: www.nrclabs.com

November 09, 2023

Dave Fawcett
Coleman Creek Consulting
810 Leonard St
Ashland, OR 97520
TEL: (541) 535-7108
FAX (541) 535-8795

RE: 23-120 G Chiloquin HS

Order No.: 23101128

Dear Dave Fawcett:

Neilson Research Corporation received 53 sample(s) on 10/26/2023 for the analyses presented in the following report.

The results relate only to the parameters tested or to the sample as received by the laboratory. This report shall not be reproduced except in full, without the written approval of Neilson Research Corporation. If you have any questions regarding these test results, please feel free to call.

Sincerely,
Neilson Research Corporation

Tamra Schmedemann
Senior Project Manager
245 S Grape St
Medford, OR 97501



Original



Neilson Research Corporation
245 S Grape St
Medford, OR 97501
TEL: (541) 770-5678 FAX: (541) 770-2901
Website: www.nrclabs.com

Case Narrative

WO#: 23101128
Date: 11/9/2023

CLIENT: Coleman Creek Consulting
Project: 23-120 G Chiloquin HS

The analyses were performed according to the guidelines in the Neilson Research Corporation Quality Assurance Program. This report contains analytical results for the sample(s) as received by the laboratory.

Neilson Research Corporation certifies that this report is in compliance with the requirements of NELAP. No unusual difficulties were experienced during analysis of this batch except as noted below or qualified with data flags on the reports.

Original



Neilson Research Corporation
245 S Grape St
Medford, OR 97501
TEL: (541) 770-5678 FAX: (541) 770-2901
Website: www.nrclabs.com

Analytical Report

WO#: 23101128

Date Reported: 11/9/2023

Coleman Creek Consulting
810 Leonard St
Ashland, OR 97520

Lab Order: 23101128
Received Date: 10/26/2023 3:15:00 PM
Reported Date: 11/9/2023 10:11:35 AM

Sample Information:

Lab ID: 23101128-01 **Client Sample ID:** 23-120G.CH1
Collection Date: 10/26/2023 5:48:00 AM **Collected By:** Lloyd Rogers
Matrix: Drinking Water **Sample Location:** Cafeteria Drinking Fountain

Trace Metals by EPA 200.8 ICP-MS							Analyst: CBB	
Analyses	Result	Qual	MRL	Units	DF	Date Analyzed	MCL	NELAP Status
Lead	ND		0.515	ppb	1	11/2/2023	15.0	A

Lab ID: 23101128-02 **Client Sample ID:** 23-120G.CH2
Collection Date: 10/26/2023 5:48:00 AM **Collected By:** Lloyd Rogers
Matrix: Drinking Water **Sample Location:** Cafeteria DF Bottle Filler

Trace Metals by EPA 200.8 ICP-MS							Analyst: CBB	
Analyses	Result	Qual	MRL	Units	DF	Date Analyzed	MCL	NELAP Status
Lead	ND		0.515	ppb	1	11/2/2023	15.0	A

Lab ID: 23101128-03 **Client Sample ID:** 23-120G.CH3
Collection Date: 10/26/2023 5:52:00 AM **Collected By:** Lloyd Rogers
Matrix: Drinking Water **Sample Location:** Girl's Hall RR at Room D-1 L Sink

Trace Metals by EPA 200.8 ICP-MS							Analyst: CBB	
Analyses	Result	Qual	MRL	Units	DF	Date Analyzed	MCL	NELAP Status
Lead	ND		0.515	ppb	1	11/2/2023	15.0	A

QUALIFIERS	*	Value exceeds Maximum Contaminant Level.	C1	Sample container temperature is out of limit as specified at testcode
	E	Value above quantitation range	H	Holding times for preparation or analysis exceeded
	J	Analyte detected below quantitation limits	MI	Recovery outside control limits due to Matrix Interference
	ND	Not Detected at the Reporting Limit	PL	Permit Limit
	PRE	Percent RE exceeds the Limit	R	RPD outside accepted recovery limits

NELAP A Accredited in accordance with NELAP ORELAP 100016, OR-028

Original



Neilson Research Corporation
245 S Grape St
Medford, OR 97501
TEL: (541) 770-5678 FAX: (541) 770-2901
Website: www.nrclabs.com

Analytical Report

WO#: 23101128

Date Reported: 11/9/2023

Coleman Creek Consulting
810 Leonard St
Ashland, OR 97520

Lab Order: 23101128
Received Date: 10/26/2023 3:15:00 PM
Reported Date: 11/9/2023 10:11:35 AM

Sample Information:

Lab ID: 23101128-04 **Client Sample ID:** 23-120G.CH4
Collection Date: 10/26/2023 5:52:00 AM **Collected By:** Lloyd Rogers
Matrix: Drinking Water **Sample Location:** Girl's Hall RR at Room D-1 Middle Sink

Trace Metals by EPA 200.8 ICP-MS							Analyst: CBB	
Analyses	Result	Qual	MRL	Units	DF	Date Analyzed	MCL	NELAP Status
Lead	ND		0.515	ppb	1	11/2/2023	15.0	A

Lab ID: 23101128-05 **Client Sample ID:** 23-120G.CH5
Collection Date: 10/26/2023 6:31:00 AM **Collected By:** Lloyd Rogers
Matrix: Drinking Water **Sample Location:** Girl's Locker Rm Sink

Trace Metals by EPA 200.8 ICP-MS							Analyst: CBB	
Analyses	Result	Qual	MRL	Units	DF	Date Analyzed	MCL	NELAP Status
Lead	2.40		0.515	ppb	1	11/2/2023	15.0	A

Lab ID: 23101128-06 **Client Sample ID:** 23-120G.CH6
Collection Date: 10/26/2023 5:55:00 AM **Collected By:** Lloyd Rogers
Matrix: Drinking Water **Sample Location:** Boy's Hall RR at Room D-1 L Sink

Trace Metals by EPA 200.8 ICP-MS							Analyst: CBB	
Analyses	Result	Qual	MRL	Units	DF	Date Analyzed	MCL	NELAP Status
Lead	0.838		0.515	ppb	1	11/2/2023	15.0	A

QUALIFIERS	*	Value exceeds Maximum Contaminant Level.	C1	Sample container temperature is out of limit as specified at testcode
	E	Value above quantitation range	H	Holding times for preparation or analysis exceeded
	J	Analyte detected below quantitation limits	MI	Recovery outside control limits due to Matrix Interference
	ND	Not Detected at the Reporting Limit	PL	Permit Limit
	PRE	Percent RE exceeds the Limit	R	RPD outside accepted recovery limits

NELAP A Accredited in accordance with NELAP ORELAP 100016, OR-028

Original



Neilson Research Corporation
245 S Grape St
Medford, OR 97501
TEL: (541) 770-5678 FAX: (541) 770-2901
Website: www.nrclabs.com

Analytical Report

WO#: 23101128

Date Reported: 11/9/2023

Coleman Creek Consulting
810 Leonard St
Ashland, OR 97520

Lab Order: 23101128
Received Date: 10/26/2023 3:15:00 PM
Reported Date: 11/9/2023 10:11:35 AM

Sample Information:

Lab ID: 23101128-07 **Client Sample ID:** 23-120G.CH7
Collection Date: 10/26/2023 5:55:00 AM **Collected By:** Lloyd Rogers
Matrix: Drinking Water **Sample Location:** Boy's Hall RR at Room D-1 Middle Sink

Trace Metals by EPA 200.8 ICP-MS						Analyst: CBB		
Analyses	Result	Qual	MRL	Units	DF	Date Analyzed	MCL	NELAP Status
Lead	0.775		0.515	ppb	1	11/2/2023	15.0	A

Lab ID: 23101128-08 **Client Sample ID:** 23-120G.CH8
Collection Date: 10/26/2023 5:55:00 AM **Collected By:** Lloyd Rogers
Matrix: Drinking Water **Sample Location:** Boy's Hall RR at Room D-1 R Sink

Trace Metals by EPA 200.8 ICP-MS						Analyst: CBB		
Analyses	Result	Qual	MRL	Units	DF	Date Analyzed	MCL	NELAP Status
Lead	ND		0.515	ppb	1	11/2/2023	15.0	A

Lab ID: 23101128-09 **Client Sample ID:** 23-120G.CH9
Collection Date: 10/26/2023 5:57:00 AM **Collected By:** Lloyd Rogers
Matrix: Drinking Water **Sample Location:** Hall DF at Room D-1

Trace Metals by EPA 200.8 ICP-MS						Analyst: CBB		
Analyses	Result	Qual	MRL	Units	DF	Date Analyzed	MCL	NELAP Status
Lead	ND		0.515	ppb	1	11/2/2023	15.0	A

QUALIFIERS	*	Value exceeds Maximum Contaminant Level.	C1	Sample container temperature is out of limit as specified at testcode
	E	Value above quantitation range	H	Holding times for preparation or analysis exceeded
	J	Analyte detected below quantitation limits	MI	Recovery outside control limits due to Matrix Interference
	ND	Not Detected at the Reporting Limit	PL	Permit Limit
	PRE	Percent RE exceeds the Limit	R	RPD outside accepted recovery limits

NELAP A Accredited in accordance with NELAP ORELAP 100016, OR-028

Original



Neilson Research Corporation
245 S Grape St
Medford, OR 97501
TEL: (541) 770-5678 FAX: (541) 770-2901
Website: www.nrclabs.com

Analytical Report

WO#: 23101128

Date Reported: 11/9/2023

Coleman Creek Consulting
810 Leonard St
Ashland, OR 97520

Lab Order: 23101128
Received Date: 10/26/2023 3:15:00 PM
Reported Date: 11/9/2023 10:11:35 AM

Sample Information:

Lab ID: 23101128-10 **Client Sample ID:** 23-120G.CH10
Collection Date: 10/26/2023 5:58:00 AM **Collected By:** Lloyd Rogers
Matrix: Drinking Water **Sample Location:** Office Break Room Sink

Trace Metals by EPA 200.8 ICP-MS							Analyst: CBB	
Analyses	Result	Qual	MRL	Units	DF	Date Analyzed	MCL	NELAP Status
Lead	ND		0.515	ppb	1	11/2/2023	15.0	A

Lab ID: 23101128-11 **Client Sample ID:** 23-120G.CH11
Collection Date: 10/26/2023 5:59:00 AM **Collected By:** Lloyd Rogers
Matrix: Drinking Water **Sample Location:** Office RR Left Sink

Trace Metals by EPA 200.8 ICP-MS							Analyst: CBB	
Analyses	Result	Qual	MRL	Units	DF	Date Analyzed	MCL	NELAP Status
Lead	3.31		0.515	ppb	1	11/2/2023	15.0	A

Lab ID: 23101128-12 **Client Sample ID:** 23-120G.CH12
Collection Date: 10/26/2023 5:59:00 AM **Collected By:** Lloyd Rogers
Matrix: Drinking Water **Sample Location:** Office RR Right Sink

Trace Metals by EPA 200.8 ICP-MS							Analyst: CBB	
Analyses	Result	Qual	MRL	Units	DF	Date Analyzed	MCL	NELAP Status
Lead	ND		0.515	ppb	1	11/2/2023	15.0	A

QUALIFIERS	*	Value exceeds Maximum Contaminant Level.	C1	Sample container temperature is out of limit as specified at testcode
	E	Value above quantitation range	H	Holding times for preparation or analysis exceeded
	J	Analyte detected below quantitation limits	MI	Recovery outside control limits due to Matrix Interference
	ND	Not Detected at the Reporting Limit	PL	Permit Limit
	PRE	Percent RE exceeds the Limit	R	RPD outside accepted recovery limits

NELAP A Accredited in accordance with NELAP ORELAP 100016, OR-028

Original



Neilson Research Corporation
245 S Grape St
Medford, OR 97501
TEL: (541) 770-5678 FAX: (541) 770-2901
Website: www.nrclabs.com

Analytical Report

WO#: 23101128

Date Reported: 11/9/2023

Coleman Creek Consulting
810 Leonard St
Ashland, OR 97520

Lab Order: 23101128
Received Date: 10/26/2023 3:15:00 PM
Reported Date: 11/9/2023 10:11:35 AM

Sample Information:

Lab ID: 23101128-13 **Client Sample ID:** 23-120G.CH13
Collection Date: 10/26/2023 6:01:00 AM **Collected By:** Lloyd Rogers
Matrix: Drinking Water **Sample Location:** Girl's RR at Room B-1 L Sink

Trace Metals by EPA 200.8 ICP-MS							Analyst: CBB	
Analyses	Result	Qual	MRL	Units	DF	Date Analyzed	MCL	NELAP Status
Lead	ND		0.515	ppb	1	11/2/2023	15.0	A

Lab ID: 23101128-14 **Client Sample ID:** 23-120G.CH14
Collection Date: 10/26/2023 6:01:00 AM **Collected By:** Lloyd Rogers
Matrix: Drinking Water **Sample Location:** Girl's RR at Room B-1 Middle Sink

Trace Metals by EPA 200.8 ICP-MS							Analyst: CBB	
Analyses	Result	Qual	MRL	Units	DF	Date Analyzed	MCL	NELAP Status
Lead	ND		0.515	ppb	1	11/2/2023	15.0	A

Lab ID: 23101128-15 **Client Sample ID:** 23-120G.CH16
Collection Date: 10/26/2023 6:08:00 AM **Collected By:** Lloyd Rogers
Matrix: Drinking Water **Sample Location:** Room A-3 Left Sink

Trace Metals by EPA 200.8 ICP-MS							Analyst: CBB	
Analyses	Result	Qual	MRL	Units	DF	Date Analyzed	MCL	NELAP Status
Lead	6.09		0.515	ppb	1	11/2/2023	15.0	A

QUALIFIERS	*	Value exceeds Maximum Contaminant Level.	C1	Sample container temperature is out of limit as specified at testcode
	E	Value above quantitation range	H	Holding times for preparation or analysis exceeded
	J	Analyte detected below quantitation limits	MI	Recovery outside control limits due to Matrix Interference
	ND	Not Detected at the Reporting Limit	PL	Permit Limit
	PRE	Percent RE exceeds the Limit	R	RPD outside accepted recovery limits

NELAP A Accredited in accordance with NELAP ORELAP 100016, OR-028

Original



Neilson Research Corporation
245 S Grape St
Medford, OR 97501
TEL: (541) 770-5678 FAX: (541) 770-2901
Website: www.nrclabs.com

Analytical Report

WO#: 23101128

Date Reported: 11/9/2023

Coleman Creek Consulting
810 Leonard St
Ashland, OR 97520

Lab Order: 23101128
Received Date: 10/26/2023 3:15:00 PM
Reported Date: 11/9/2023 10:11:35 AM

Sample Information:

Lab ID: 23101128-16 **Client Sample ID:** 23-120G.CH17
Collection Date: 10/26/2023 6:08:00 AM **Collected By:** Lloyd Rogers
Matrix: Drinking Water **Sample Location:** Room A-3 Left Middle Sink

Trace Metals by EPA 200.8 ICP-MS							Analyst: CBB	
Analyses	Result	Qual	MRL	Units	DF	Date Analyzed	MCL	NELAP Status
Lead	8.72		0.515	ppb	1	11/2/2023	15.0	A

Lab ID: 23101128-17 **Client Sample ID:** 23-120G.CH18
Collection Date: 10/26/2023 6:08:00 AM **Collected By:** Lloyd Rogers
Matrix: Drinking Water **Sample Location:** Room A-3 Left Middle Middle Sink

Trace Metals by EPA 200.8 ICP-MS							Analyst: CBB	
Analyses	Result	Qual	MRL	Units	DF	Date Analyzed	MCL	NELAP Status
Lead	2.74		0.515	ppb	1	11/2/2023	15.0	A

Lab ID: 23101128-18 **Client Sample ID:** 23-120G.CH19
Collection Date: 10/26/2023 6:08:00 AM **Collected By:** Lloyd Rogers
Matrix: Drinking Water **Sample Location:** Room A-3 Middle Sink

Trace Metals by EPA 200.8 ICP-MS							Analyst: CBB	
Analyses	Result	Qual	MRL	Units	DF	Date Analyzed	MCL	NELAP Status
Lead	1.55		0.515	ppb	1	11/2/2023	15.0	A

QUALIFIERS	*	Value exceeds Maximum Contaminant Level.	C1	Sample container temperature is out of limit as specified at testcode
	E	Value above quantitation range	H	Holding times for preparation or analysis exceeded
	J	Analyte detected below quantitation limits	MI	Recovery outside control limits due to Matrix Interference
	ND	Not Detected at the Reporting Limit	PL	Permit Limit
	PRE	Percent RE exceeds the Limit	R	RPD outside accepted recovery limits

NELAP NELAP A Accredited in accordance with NELAP ORELAP 100016, OR-028

Original



Neilson Research Corporation
245 S Grape St
Medford, OR 97501
TEL: (541) 770-5678 FAX: (541) 770-2901
Website: www.nrclabs.com

Analytical Report

WO#: 23101128

Date Reported: 11/9/2023

Coleman Creek Consulting
810 Leonard St
Ashland, OR 97520

Lab Order: 23101128
Received Date: 10/26/2023 3:15:00 PM
Reported Date: 11/9/2023 10:11:35 AM

Sample Information:

Lab ID: 23101128-19 **Client Sample ID:** 23-120G.CH20
Collection Date: 10/26/2023 6:09:00 AM **Collected By:** Lloyd Rogers
Matrix: Drinking Water **Sample Location:** Room A-3 Right Middle Middle Sink

Trace Metals by EPA 200.8 ICP-MS							Analyst: CBB	
Analyses	Result	Qual	MRL	Units	DF	Date Analyzed	MCL	NELAP Status
Lead	1.82		0.515	ppb	1	11/2/2023	15.0	A

Lab ID: 23101128-20 **Client Sample ID:** 23-120G.CH21
Collection Date: 10/26/2023 6:09:00 AM **Collected By:** Lloyd Rogers
Matrix: Drinking Water **Sample Location:** Room A-3 Right Middle Sink

Trace Metals by EPA 200.8 ICP-MS							Analyst: CBB	
Analyses	Result	Qual	MRL	Units	DF	Date Analyzed	MCL	NELAP Status
Lead	4.66		0.515	ppb	1	11/2/2023	15.0	A

Lab ID: 23101128-21 **Client Sample ID:** 23-120G.CH22
Collection Date: 10/26/2023 6:09:00 AM **Collected By:** Lloyd Rogers
Matrix: Drinking Water **Sample Location:** Room A-3 Right Sink

Trace Metals by EPA 200.8 ICP-MS							Analyst: CBB	
Analyses	Result	Qual	MRL	Units	DF	Date Analyzed	MCL	NELAP Status
Lead	5.86		0.515	ppb	1	11/2/2023	15.0	A

QUALIFIERS	*	Value exceeds Maximum Contaminant Level.	C1	Sample container temperature is out of limit as specified at testcode
	E	Value above quantitation range	H	Holding times for preparation or analysis exceeded
	J	Analyte detected below quantitation limits	MI	Recovery outside control limits due to Matrix Interference
	ND	Not Detected at the Reporting Limit	PL	Permit Limit
	PRE	Percent RE exceeds the Limit	R	RPD outside accepted recovery limits

NELAP A Accredited in accordance with NELAP ORELAP 100016, OR-028

Original



Neilson Research Corporation
245 S Grape St
Medford, OR 97501
TEL: (541) 770-5678 FAX: (541) 770-2901
Website: www.nrclabs.com

Analytical Report

WO#: 23101128

Date Reported: 11/9/2023

Coleman Creek Consulting
810 Leonard St
Ashland, OR 97520

Lab Order: 23101128
Received Date: 10/26/2023 3:15:00 PM
Reported Date: 11/9/2023 10:11:35 AM

Sample Information:

Lab ID: 23101128-22 **Client Sample ID:** 23-120G.CH23
Collection Date: 10/26/2023 6:10:00 AM **Collected By:** Lloyd Rogers
Matrix: Drinking Water **Sample Location:** Hall DF at Room A-3

Trace Metals by EPA 200.8 ICP-MS							Analyst: CBB	
Analyses	Result	Qual	MRL	Units	DF	Date Analyzed	MCL	NELAP Status
Lead	2.51		0.515	ppb	1	11/2/2023	15.0	A

Lab ID: 23101128-23 **Client Sample ID:** 23-120G.CH24
Collection Date: 10/26/2023 6:15:00 AM **Collected By:** Lloyd Rogers
Matrix: Drinking Water **Sample Location:** Room A-4 Left Sink

Trace Metals by EPA 200.8 ICP-MS							Analyst: CBB	
Analyses	Result	Qual	MRL	Units	DF	Date Analyzed	MCL	NELAP Status
Lead	1.05		0.515	ppb	1	11/2/2023	15.0	A

Lab ID: 23101128-24 **Client Sample ID:** 23-120G.CH25
Collection Date: 10/26/2023 6:15:00 AM **Collected By:** Lloyd Rogers
Matrix: Drinking Water **Sample Location:** Room A-4 Left Middle Sink

Trace Metals by EPA 200.8 ICP-MS							Analyst: CBB	
Analyses	Result	Qual	MRL	Units	DF	Date Analyzed	MCL	NELAP Status
Lead	2.43		0.515	ppb	1	11/2/2023	15.0	A

QUALIFIERS	*	Value exceeds Maximum Contaminant Level.	C1	Sample container temperature is out of limit as specified at testcode
	E	Value above quantitation range	H	Holding times for preparation or analysis exceeded
	J	Analyte detected below quantitation limits	MI	Recovery outside control limits due to Matrix Interference
	ND	Not Detected at the Reporting Limit	PL	Permit Limit
	PRE	Percent RE exceeds the Limit	R	RPD outside accepted recovery limits

NELAP A Accredited in accordance with NELAP ORELAP 100016, OR-028

Original



Neilson Research Corporation
245 S Grape St
Medford, OR 97501
TEL: (541) 770-5678 FAX: (541) 770-2901
Website: www.nrclabs.com

Analytical Report

WO#: 23101128

Date Reported: 11/9/2023

Coleman Creek Consulting
810 Leonard St
Ashland, OR 97520

Lab Order: 23101128
Received Date: 10/26/2023 3:15:00 PM
Reported Date: 11/9/2023 10:11:35 AM

Sample Information:

Lab ID: 23101128-25 **Client Sample ID:** 23-120G.CH26
Collection Date: 10/26/2023 6:16:00 AM **Collected By:** Lloyd Rogers
Matrix: Drinking Water **Sample Location:** Room A-4 Left Middle Middle Sink

Trace Metals by EPA 200.8 ICP-MS							Analyst: CBB	
Analyses	Result	Qual	MRL	Units	DF	Date Analyzed	MCL	NELAP Status
Lead	2.17		0.515	ppb	1	11/2/2023	15.0	A

Lab ID: 23101128-26 **Client Sample ID:** 23-120G.CH27
Collection Date: 10/26/2023 6:16:00 AM **Collected By:** Lloyd Rogers
Matrix: Drinking Water **Sample Location:** Room A-4 Middle Sink

Trace Metals by EPA 200.8 ICP-MS							Analyst: CBB	
Analyses	Result	Qual	MRL	Units	DF	Date Analyzed	MCL	NELAP Status
Lead	7.45		0.515	ppb	1	11/2/2023	15.0	A

Lab ID: 23101128-27 **Client Sample ID:** 23-120G.CH28
Collection Date: 10/26/2023 6:16:00 AM **Collected By:** Lloyd Rogers
Matrix: Drinking Water **Sample Location:** Room A-4 Right Middle Middle Sink

Trace Metals by EPA 200.8 ICP-MS							Analyst: CBB	
Analyses	Result	Qual	MRL	Units	DF	Date Analyzed	MCL	NELAP Status
Lead	1.28		0.515	ppb	1	11/2/2023	15.0	A

QUALIFIERS	*	Value exceeds Maximum Contaminant Level.	C1	Sample container temperature is out of limit as specified at testcode
	E	Value above quantitation range	H	Holding times for preparation or analysis exceeded
	J	Analyte detected below quantitation limits	MI	Recovery outside control limits due to Matrix Interference
	ND	Not Detected at the Reporting Limit	PL	Permit Limit
	PRE	Percent RE exceeds the Limit	R	RPD outside accepted recovery limits

NELAP NELAP A Accredited in accordance with NELAP ORELAP 100016, OR-028

Original



Neilson Research Corporation
245 S Grape St
Medford, OR 97501
TEL: (541) 770-5678 FAX: (541) 770-2901
Website: www.nrclabs.com

Analytical Report

WO#: 23101128

Date Reported: 11/9/2023

Coleman Creek Consulting
810 Leonard St
Ashland, OR 97520

Lab Order: 23101128
Received Date: 10/26/2023 3:15:00 PM
Reported Date: 11/9/2023 10:11:35 AM

Sample Information:

Lab ID: 23101128-28 **Client Sample ID:** 23-120G.CH29
Collection Date: 10/26/2023 6:16:00 AM **Collected By:** Lloyd Rogers
Matrix: Drinking Water **Sample Location:** Room A-4 Right Middle Sink

Trace Metals by EPA 200.8 ICP-MS							Analyst: CBB	
Analyses	Result	Qual	MRL	Units	DF	Date Analyzed	MCL	NELAP Status
Lead	2.30		0.515	ppb	1	11/2/2023	15.0	A

Lab ID: 23101128-29 **Client Sample ID:** 23-120G.CH30
Collection Date: 10/26/2023 6:17:00 AM **Collected By:** Lloyd Rogers
Matrix: Drinking Water **Sample Location:** Room A-4 Right Sink

Trace Metals by EPA 200.8 ICP-MS							Analyst: CBB	
Analyses	Result	Qual	MRL	Units	DF	Date Analyzed	MCL	NELAP Status
Lead	0.788		0.515	ppb	1	11/2/2023	15.0	A

Lab ID: 23101128-30 **Client Sample ID:** 23-120G.CH31
Collection Date: 10/26/2023 6:19:00 AM **Collected By:** Lloyd Rogers
Matrix: Drinking Water **Sample Location:** Room A-5 Left Sink

Trace Metals by EPA 200.8 ICP-MS							Analyst: CBB	
Analyses	Result	Qual	MRL	Units	DF	Date Analyzed	MCL	NELAP Status
Lead	ND		0.515	ppb	1	11/2/2023	15.0	A

QUALIFIERS	*	Value exceeds Maximum Contaminant Level.	C1	Sample container temperature is out of limit as specified at testcode
	E	Value above quantitation range	H	Holding times for preparation or analysis exceeded
	J	Analyte detected below quantitation limits	MI	Recovery outside control limits due to Matrix Interference
	ND	Not Detected at the Reporting Limit	PL	Permit Limit
	PRE	Percent RE exceeds the Limit	R	RPD outside accepted recovery limits

NELAP A Accredited in accordance with NELAP ORELAP 100016, OR-028

Original



Neilson Research Corporation
245 S Grape St
Medford, OR 97501
TEL: (541) 770-5678 FAX: (541) 770-2901
Website: www.nrclabs.com

Analytical Report

WO#: 23101128

Date Reported: 11/9/2023

Coleman Creek Consulting
810 Leonard St
Ashland, OR 97520

Lab Order: 23101128
Received Date: 10/26/2023 3:15:00 PM
Reported Date: 11/9/2023 10:11:35 AM

Sample Information:

Lab ID: 23101128-31 **Client Sample ID:** 23-120G.CH32
Collection Date: 10/26/2023 6:19:00 AM **Collected By:** Lloyd Rogers
Matrix: Drinking Water **Sample Location:** Room A-5 Middle Sink

Trace Metals by EPA 200.8 ICP-MS							Analyst: CBB	
Analyses	Result	Qual	MRL	Units	DF	Date Analyzed	MCL	NELAP Status
Lead	ND		0.515	ppb	1	11/2/2023	15.0	A

Lab ID: 23101128-32 **Client Sample ID:** 23-120G.CH33
Collection Date: 10/26/2023 6:21:00 AM **Collected By:** Lloyd Rogers
Matrix: Drinking Water **Sample Location:** Room A-5 Sink

Trace Metals by EPA 200.8 ICP-MS							Analyst: CBB	
Analyses	Result	Qual	MRL	Units	DF	Date Analyzed	MCL	NELAP Status
Lead	0.539		0.515	ppb	1	11/2/2023	15.0	A

Lab ID: 23101128-33 **Client Sample ID:** 23-120G.CH34
Collection Date: 10/26/2023 6:23:00 AM **Collected By:** Lloyd Rogers
Matrix: Drinking Water **Sample Location:** Boy's Hall RR at Room B-5 L Sink

Trace Metals by EPA 200.8 ICP-MS							Analyst: CBB	
Analyses	Result	Qual	MRL	Units	DF	Date Analyzed	MCL	NELAP Status
Lead	ND		0.515	ppb	1	11/2/2023	15.0	A

QUALIFIERS	*	Value exceeds Maximum Contaminant Level.	C1	Sample container temperature is out of limit as specified at testcode
	E	Value above quantitation range	H	Holding times for preparation or analysis exceeded
	J	Analyte detected below quantitation limits	MI	Recovery outside control limits due to Matrix Interference
	ND	Not Detected at the Reporting Limit	PL	Permit Limit
	PRE	Percent RE exceeds the Limit	R	RPD outside accepted recovery limits

NELAP NELAP A Accredited in accordance with NELAP ORELAP 100016, OR-028

Original



Neilson Research Corporation
245 S Grape St
Medford, OR 97501
TEL: (541) 770-5678 FAX: (541) 770-2901
Website: www.nrclabs.com

Analytical Report

WO#: 23101128

Date Reported: 11/9/2023

Coleman Creek Consulting
810 Leonard St
Ashland, OR 97520

Lab Order: 23101128
Received Date: 10/26/2023 3:15:00 PM
Reported Date: 11/9/2023 10:11:35 AM

Sample Information:

Lab ID: 23101128-34 **Client Sample ID:** 23-120G.CH35
Collection Date: 10/26/2023 6:23:00 AM **Collected By:** Lloyd Rogers
Matrix: Drinking Water **Sample Location:** Boy's Hall RR at Room B-5 Middle Sink

Trace Metals by EPA 200.8 ICP-MS							Analyst: CBB	
Analyses	Result	Qual	MRL	Units	DF	Date Analyzed	MCL	NELAP Status
Lead	ND		0.515	ppb	1	11/2/2023	15.0	A

Lab ID: 23101128-35 **Client Sample ID:** 23-120G.CH36
Collection Date: 10/26/2023 6:23:00 AM **Collected By:** Lloyd Rogers
Matrix: Drinking Water **Sample Location:** Boy's Hall RR at Room B-5 R Sink

Trace Metals by EPA 200.8 ICP-MS							Analyst: CBB	
Analyses	Result	Qual	MRL	Units	DF	Date Analyzed	MCL	NELAP Status
Lead	ND		0.515	ppb	1	11/2/2023	15.0	A

Lab ID: 23101128-36 **Client Sample ID:** 23-120G.CH37
Collection Date: 10/26/2023 6:24:00 AM **Collected By:** Lloyd Rogers
Matrix: Drinking Water **Sample Location:** Hall DF at Courtyard

Trace Metals by EPA 200.8 ICP-MS							Analyst: CBB	
Analyses	Result	Qual	MRL	Units	DF	Date Analyzed	MCL	NELAP Status
Lead	ND		0.515	ppb	1	11/2/2023	15.0	A

QUALIFIERS	*	Value exceeds Maximum Contaminant Level.	C1	Sample container temperature is out of limit as specified at testcode
	E	Value above quantitation range	H	Holding times for preparation or analysis exceeded
	J	Analyte detected below quantitation limits	MI	Recovery outside control limits due to Matrix Interference
	ND	Not Detected at the Reporting Limit	PL	Permit Limit
	PRE	Percent RE exceeds the Limit	R	RPD outside accepted recovery limits

NELAP A Accredited in accordance with NELAP ORELAP 100016, OR-028

Original



Neilson Research Corporation
245 S Grape St
Medford, OR 97501
TEL: (541) 770-5678 FAX: (541) 770-2901
Website: www.nrclabs.com

Analytical Report

WO#: 23101128

Date Reported: 11/9/2023

Coleman Creek Consulting
810 Leonard St
Ashland, OR 97520

Lab Order: 23101128
Received Date: 10/26/2023 3:15:00 PM
Reported Date: 11/9/2023 10:11:35 AM

Sample Information:

Lab ID: 23101128-37 **Client Sample ID:** 23-120G.CH38
Collection Date: 10/26/2023 6:26:00 AM **Collected By:** Lloyd Rogers
Matrix: Drinking Water **Sample Location:** Boy's Locker Room DF

Trace Metals by EPA 200.8 ICP-MS							Analyst: CBB	
Analyses	Result	Qual	MRL	Units	DF	Date Analyzed	MCL	NELAP Status
Lead	ND		0.515	ppb	1	11/2/2023	15.0	A

Lab ID: 23101128-38 **Client Sample ID:** 23-120G.CH39
Collection Date: 10/26/2023 6:26:00 AM **Collected By:** Lloyd Rogers
Matrix: Drinking Water **Sample Location:** Boy's Locker Room Left Sink

Trace Metals by EPA 200.8 ICP-MS							Analyst: CBB	
Analyses	Result	Qual	MRL	Units	DF	Date Analyzed	MCL	NELAP Status
Lead	ND		0.515	ppb	1	11/2/2023	15.0	A

Lab ID: 23101128-39 **Client Sample ID:** 23-120G.CH40
Collection Date: 10/26/2023 6:26:00 AM **Collected By:** Lloyd Rogers
Matrix: Drinking Water **Sample Location:** Boy's Locker Room Right Sink

Trace Metals by EPA 200.8 ICP-MS							Analyst: CBB	
Analyses	Result	Qual	MRL	Units	DF	Date Analyzed	MCL	NELAP Status
Lead	ND		0.515	ppb	1	11/2/2023	15.0	A

QUALIFIERS	*	Value exceeds Maximum Contaminant Level.	C1	Sample container temperature is out of limit as specified at testcode
	E	Value above quantitation range	H	Holding times for preparation or analysis exceeded
	J	Analyte detected below quantitation limits	MI	Recovery outside control limits due to Matrix Interference
	ND	Not Detected at the Reporting Limit	PL	Permit Limit
	PRE	Percent RE exceeds the Limit	R	RPD outside accepted recovery limits

NELAP NELAP A Accredited in accordance with NELAP ORELAP 100016, OR-028

Original



Neilson Research Corporation
245 S Grape St
Medford, OR 97501
TEL: (541) 770-5678 FAX: (541) 770-2901
Website: www.nrclabs.com

Analytical Report

WO#: 23101128

Date Reported: 11/9/2023

Coleman Creek Consulting
810 Leonard St
Ashland, OR 97520

Lab Order: 23101128
Received Date: 10/26/2023 3:15:00 PM
Reported Date: 11/9/2023 10:11:35 AM

Sample Information:

Lab ID: 23101128-40 **Client Sample ID:** 23-120G.CH41
Collection Date: 10/26/2023 6:28:00 AM **Collected By:** Lloyd Rogers
Matrix: Drinking Water **Sample Location:** Gym Drinking Fountain

Trace Metals by EPA 200.8 ICP-MS							Analyst: CBB	
Analyses	Result	Qual	MRL	Units	DF	Date Analyzed	MCL	NELAP Status
Lead	ND		0.515	ppb	1	11/2/2023	15.0	A

Lab ID: 23101128-41 **Client Sample ID:** 23-120G.CH42
Collection Date: 10/26/2023 6:30:00 AM **Collected By:** Lloyd Rogers
Matrix: Drinking Water **Sample Location:** Girl's Locker Room DF

Trace Metals by EPA 200.8 ICP-MS							Analyst: CJS	
Analyses	Result	Qual	MRL	Units	DF	Date Analyzed	MCL	NELAP Status
Lead	1.11		0.515	ppb	1	11/6/2023	15.0	A

Lab ID: 23101128-42 **Client Sample ID:** 23-120G.CH43
Collection Date: 10/26/2023 6:32:00 AM **Collected By:** Lloyd Rogers
Matrix: Drinking Water **Sample Location:** Hall DF at Girl's Locker Room

Trace Metals by EPA 200.8 ICP-MS							Analyst: CJS	
Analyses	Result	Qual	MRL	Units	DF	Date Analyzed	MCL	NELAP Status
Lead	ND		0.515	ppb	1	11/6/2023	15.0	A

QUALIFIERS	*	Value exceeds Maximum Contaminant Level.	C1	Sample container temperature is out of limit as specified at testcode
	E	Value above quantitation range	H	Holding times for preparation or analysis exceeded
	J	Analyte detected below quantitation limits	MI	Recovery outside control limits due to Matrix Interference
	ND	Not Detected at the Reporting Limit	PL	Permit Limit
	PRE	Percent RE exceeds the Limit	R	RPD outside accepted recovery limits

NELAP A Accredited in accordance with NELAP ORELAP 100016, OR-028

Original



Neilson Research Corporation
245 S Grape St
Medford, OR 97501
TEL: (541) 770-5678 FAX: (541) 770-2901
Website: www.nrclabs.com

Analytical Report

WO#: 23101128

Date Reported: 11/9/2023

Coleman Creek Consulting
810 Leonard St
Ashland, OR 97520

Lab Order: 23101128
Received Date: 10/26/2023 3:15:00 PM
Reported Date: 11/9/2023 10:11:35 AM

Sample Information:

Lab ID: 23101128-43 **Client Sample ID:** 23-120G.CH44
Collection Date: 10/26/2023 6:32:00 AM **Collected By:** Lloyd Rogers
Matrix: Drinking Water **Sample Location:** Hall DF Bottle Filler at Girl's Locker Rm

Trace Metals by EPA 200.8 ICP-MS							Analyst: CJS	
Analyses	Result	Qual	MRL	Units	DF	Date Analyzed	MCL	NELAP Status
Lead	ND		0.515	ppb	1	11/6/2023	15.0	A

Lab ID: 23101128-44 **Client Sample ID:** 23-120G.CH45
Collection Date: 10/26/2023 9:26:00 AM **Collected By:** Lloyd Rogers
Matrix: Drinking Water **Sample Location:** Big Gym Bldg Girl's Locker DF

Trace Metals by EPA 200.8 ICP-MS							Analyst: CJS	
Analyses	Result	Qual	MRL	Units	DF	Date Analyzed	MCL	NELAP Status
Lead	1.81		0.515	ppb	1	11/6/2023	15.0	A

Lab ID: 23101128-45 **Client Sample ID:** 23-120G.CH46
Collection Date: 10/26/2023 9:28:00 AM **Collected By:** Lloyd Rogers
Matrix: Drinking Water **Sample Location:** Big Gym Bldg Girl's Locker L Sink

Trace Metals by EPA 200.8 ICP-MS							Analyst: CJS	
Analyses	Result	Qual	MRL	Units	DF	Date Analyzed	MCL	NELAP Status
Lead	ND		0.515	ppb	1	11/6/2023	15.0	A

QUALIFIERS	*	Value exceeds Maximum Contaminant Level.	C1	Sample container temperature is out of limit as specified at testcode
	E	Value above quantitation range	H	Holding times for preparation or analysis exceeded
	J	Analyte detected below quantitation limits	MI	Recovery outside control limits due to Matrix Interference
	ND	Not Detected at the Reporting Limit	PL	Permit Limit
	PRE	Percent RE exceeds the Limit	R	RPD outside accepted recovery limits

NELAP NELAP A Accredited in accordance with NELAP ORELAP 100016, OR-028

Original



Neilson Research Corporation
245 S Grape St
Medford, OR 97501
TEL: (541) 770-5678 FAX: (541) 770-2901
Website: www.nrclabs.com

Analytical Report

WO#: 23101128

Date Reported: 11/9/2023

Coleman Creek Consulting
810 Leonard St
Ashland, OR 97520

Lab Order: 23101128
Received Date: 10/26/2023 3:15:00 PM
Reported Date: 11/9/2023 10:11:35 AM

Sample Information:

Lab ID: 23101128-46 **Client Sample ID:** 23-120G.CH47
Collection Date: 10/26/2023 9:28:00 AM **Collected By:** Lloyd Rogers
Matrix: Drinking Water **Sample Location:** Big Gym Bldg Girl's Locker R Sink

Trace Metals by EPA 200.8 ICP-MS							Analyst: CJS	
Analyses	Result	Qual	MRL	Units	DF	Date Analyzed	MCL	NELAP Status
Lead	3.10		0.515	ppb	1	11/6/2023	15.0	A

Lab ID: 23101128-47 **Client Sample ID:** 23-120G.CH48
Collection Date: 10/26/2023 9:29:00 AM **Collected By:** Lloyd Rogers
Matrix: Drinking Water **Sample Location:** Big Gym Bldg Boy's Locker DF

Trace Metals by EPA 200.8 ICP-MS							Analyst: CJS	
Analyses	Result	Qual	MRL	Units	DF	Date Analyzed	MCL	NELAP Status
Lead	1.89		0.515	ppb	1	11/6/2023	15.0	A

Lab ID: 23101128-48 **Client Sample ID:** 23-120G.CH49
Collection Date: 10/26/2023 9:29:00 AM **Collected By:** Lloyd Rogers
Matrix: Drinking Water **Sample Location:** Big Gym Bldg Boy's Locker L Sink

Trace Metals by EPA 200.8 ICP-MS							Analyst: CJS	
Analyses	Result	Qual	MRL	Units	DF	Date Analyzed	MCL	NELAP Status
Lead	4.09		0.515	ppb	1	11/6/2023	15.0	A

QUALIFIERS	*	Value exceeds Maximum Contaminant Level.	C1	Sample container temperature is out of limit as specified at testcode
	E	Value above quantitation range	H	Holding times for preparation or analysis exceeded
	J	Analyte detected below quantitation limits	MI	Recovery outside control limits due to Matrix Interference
	ND	Not Detected at the Reporting Limit	PL	Permit Limit
	PRE	Percent RE exceeds the Limit	R	RPD outside accepted recovery limits

NELAP NELAP A Accredited in accordance with NELAP ORELAP 100016, OR-028

Original



Neilson Research Corporation
245 S Grape St
Medford, OR 97501
TEL: (541) 770-5678 FAX: (541) 770-2901
Website: www.nrclabs.com

Analytical Report

WO#: 23101128

Date Reported: 11/9/2023

Coleman Creek Consulting
810 Leonard St
Ashland, OR 97520

Lab Order: 23101128
Received Date: 10/26/2023 3:15:00 PM
Reported Date: 11/9/2023 10:11:35 AM

Sample Information:

Lab ID: 23101128-49 **Client Sample ID:** 23-120G.CH50
Collection Date: 10/26/2023 9:29:00 AM **Collected By:** Lloyd Rogers
Matrix: Drinking Water **Sample Location:** Big Gym Bldg Boy's Locker R Sink

Trace Metals by EPA 200.8 ICP-MS							Analyst: CJS	
Analyses	Result	Qual	MRL	Units	DF	Date Analyzed	MCL	NELAP Status
Lead	4.34		0.515	ppb	1	11/6/2023	15.0	A

Lab ID: 23101128-50 **Client Sample ID:** 23-120G.CH51
Collection Date: 10/26/2023 9:31:00 AM **Collected By:** Lloyd Rogers
Matrix: Drinking Water **Sample Location:** Big Gym Bldg Front Entry Sink

Trace Metals by EPA 200.8 ICP-MS							Analyst: CJS	
Analyses	Result	Qual	MRL	Units	DF	Date Analyzed	MCL	NELAP Status
Lead	ND		0.515	ppb	1	11/6/2023	15.0	A

Lab ID: 23101128-51 **Client Sample ID:** 23-120G.CH52
Collection Date: 10/26/2023 9:32:00 AM **Collected By:** Lloyd Rogers
Matrix: Drinking Water **Sample Location:** Big Gym Bldg Front Entry RR Sink

Trace Metals by EPA 200.8 ICP-MS							Analyst: CJS	
Analyses	Result	Qual	MRL	Units	DF	Date Analyzed	MCL	NELAP Status
Lead	0.630		0.515	ppb	1	11/6/2023	15.0	A

QUALIFIERS	*	Value exceeds Maximum Contaminant Level.	C1	Sample container temperature is out of limit as specified at testcode
	E	Value above quantitation range	H	Holding times for preparation or analysis exceeded
	J	Analyte detected below quantitation limits	MI	Recovery outside control limits due to Matrix Interference
	ND	Not Detected at the Reporting Limit	PL	Permit Limit
	PRE	Percent RE exceeds the Limit	R	RPD outside accepted recovery limits

NELAP A Accredited in accordance with NELAP ORELAP 100016, OR-028

Original



Neilson Research Corporation
245 S Grape St
Medford, OR 97501
TEL: (541) 770-5678 FAX: (541) 770-2901
Website: www.nrclabs.com

Analytical Report

WO#: 23101128

Date Reported: 11/9/2023

Coleman Creek Consulting
810 Leonard St
Ashland, OR 97520

Lab Order: 23101128
Received Date: 10/26/2023 3:15:00 PM
Reported Date: 11/9/2023 10:11:35 AM

Sample Information:

Lab ID: 23101128-52 **Client Sample ID:** 23-120G.CH53
Collection Date: 10/26/2023 9:34:00 AM **Collected By:** Lloyd Rogers
Matrix: Drinking Water **Sample Location:** Big Gym Bldg Upper Front RR L Sink

Trace Metals by EPA 200.8 ICP-MS						Analyst: CJS		
Analyses	Result	Qual	MRL	Units	DF	Date Analyzed	MCL	NELAP Status
Lead	ND		0.515	ppb	1	11/6/2023	15.0	A

Lab ID: 23101128-53 **Client Sample ID:** 23-120G.CH54
Collection Date: 10/26/2023 9:34:00 AM **Collected By:** Lloyd Rogers
Matrix: Drinking Water **Sample Location:** Big Gym Bldg Upper Front RR R Sink

Trace Metals by EPA 200.8 ICP-MS						Analyst: CJS		
Analyses	Result	Qual	MRL	Units	DF	Date Analyzed	MCL	NELAP Status
Lead	4.09		0.515	ppb	1	11/6/2023	15.0	A

QUALIFIERS	*	Value exceeds Maximum Contaminant Level.	C1	Sample container temperature is out of limit as specified at testcode
	E	Value above quantitation range	H	Holding times for preparation or analysis exceeded
	J	Analyte detected below quantitation limits	MI	Recovery outside control limits due to Matrix Interference
	ND	Not Detected at the Reporting Limit	PL	Permit Limit
	PRE	Percent RE exceeds the Limit	R	RPD outside accepted recovery limits

NELAP A Accredited in accordance with NELAP ORELAP 100016, OR-028

Original



Neilson Research Corporation
245 S Grape St
Medford, OR 97501
TEL: (541) 770-5678 FAX: (541) 770-2901
Website: www.nrlabs.com

QC SUMMARY REPORT

WO#: 23101128
09-Nov-23

Client: Coleman Creek Consulting
Project: 23-120 G Chiloquin HS

TestCode: LEAD_DW

Sample ID: MB-23221	SampType: MBLK	TestCode: LEAD_DW	Units: ppb	Prep Date: 11/2/2023	RunNo: 43848
Client ID: PBW	Batch ID: 23221	TestNo: E200.8	E200.8	Analysis Date: 11/2/2023	SeqNo: 730813
Analyte	Result	PQL	SPK value	SPK Ref Val	%REC LowLimit HighLimit RPD Ref Val %RPD RPDLimit Qual

Lead ND 0.515

Sample ID: LCS-23221	SampType: LCS	TestCode: LEAD_DW	Units: ppb	Prep Date: 11/2/2023	RunNo: 43848
Client ID: LCSW	Batch ID: 23221	TestNo: E200.8	E200.8	Analysis Date: 11/2/2023	SeqNo: 730814
Analyte	Result	PQL	SPK value	SPK Ref Val	%REC LowLimit HighLimit RPD Ref Val %RPD RPDLimit Qual

Lead 95.2 0.520 100 0 95.2 85 115

Sample ID: 23101128-01AMS	SampType: MS	TestCode: LEAD_DW	Units: ppb	Prep Date: 11/2/2023	RunNo: 43848
Client ID: 23-120G.CH1	Batch ID: 23221	TestNo: E200.8	E200.8	Analysis Date: 11/2/2023	SeqNo: 730816
Analyte	Result	PQL	SPK value	SPK Ref Val	%REC LowLimit HighLimit RPD Ref Val %RPD RPDLimit Qual

Lead 92.8 0.520 100 0 92.8 70 130

Sample ID: 23101128-01AMSD	SampType: MSD	TestCode: LEAD_DW	Units: ppb	Prep Date: 11/2/2023	RunNo: 43848
Client ID: 23-120G.CH1	Batch ID: 23221	TestNo: E200.8	E200.8	Analysis Date: 11/2/2023	SeqNo: 730817
Analyte	Result	PQL	SPK value	SPK Ref Val	%REC LowLimit HighLimit RPD Ref Val %RPD RPDLimit Qual

Lead 91.2 0.520 100 0 91.2 70 130 92.8 1.73 20

Qualifiers: CI Sample container temperature is out of limit as specified at testcode H Holding times for preparation or analysis exceeded MI Recovery outside control limits due to Matrix Int
ND Not Detected at the Reporting Limit PL Permit Limit RL Reporting Detection Limit

Original



Neilson Research Corporation
245 S Grape St
Medford, OR 97501
TEL: (541) 770-5678 FAX: (541) 770-2901
Website: www.nrlabs.com

QC SUMMARY REPORT

WO#: 23101128
09-Nov-23

Client: Coleman Creek Consulting
Project: 23-120 G Chiloquin HS

TestCode: LEAD_DW

Sample ID: MB-23222	SampType: MBLK	TestCode: LEAD_DW	Units: ppb	Prep Date: 11/2/2023	RunNo: 43848
Client ID: PBW	Batch ID: 23222	TestNo: E200.8	E200.8	Analysis Date: 11/2/2023	SeqNo: 730841
Analyte	Result	PQL	SPK value	SPK Ref Val	%REC LowLimit HighLimit RPD Ref Val %RPD RPDLimit Qual

Lead	ND	0.515
------	----	-------

Sample ID: LCS-23222	SampType: LCS	TestCode: LEAD_DW	Units: ppb	Prep Date: 11/2/2023	RunNo: 43848
Client ID: LCSW	Batch ID: 23222	TestNo: E200.8	E200.8	Analysis Date: 11/2/2023	SeqNo: 730842
Analyte	Result	PQL	SPK value	SPK Ref Val	%REC LowLimit HighLimit RPD Ref Val %RPD RPDLimit Qual

Lead	93.3	0.520	100	0	93.3	85	115
------	------	-------	-----	---	------	----	-----

Sample ID: 23101128-21AMS	SampType: MS	TestCode: LEAD_DW	Units: ppb	Prep Date: 11/2/2023	RunNo: 43848
Client ID: 23-120G.CH22	Batch ID: 23222	TestNo: E200.8	E200.8	Analysis Date: 11/2/2023	SeqNo: 730844
Analyte	Result	PQL	SPK value	SPK Ref Val	%REC LowLimit HighLimit RPD Ref Val %RPD RPDLimit Qual

Lead	101	0.520	100	5.86	94.8	70	130
------	-----	-------	-----	------	------	----	-----

Sample ID: 23101128-21AMSD	SampType: MSD	TestCode: LEAD_DW	Units: ppb	Prep Date: 11/2/2023	RunNo: 43848
Client ID: 23-120G.CH22	Batch ID: 23222	TestNo: E200.8	E200.8	Analysis Date: 11/2/2023	SeqNo: 730845
Analyte	Result	PQL	SPK value	SPK Ref Val	%REC LowLimit HighLimit RPD Ref Val %RPD RPDLimit Qual

Lead	98.7	0.520	100	5.86	92.8	70	130	101	1.99	20
------	------	-------	-----	------	------	----	-----	-----	------	----

Qualifiers: C1 Sample container temperature is out of limit as specified at testcode H Holding times for preparation or analysis exceeded MI Recovery outside control limits due to Matrix Int
ND Not Detected at the Reporting Limit PL Permit Limit RL Reporting Detection Limit

Original



Neilson Research Corporation
245 S Grape St
Medford, OR 97501
TEL: (541) 770-5678 FAX: (541) 770-2901
Website: www.nrlabs.com

QC SUMMARY REPORT

WO#: 23101128
09-Nov-23

Client: Coleman Creek Consulting
Project: 23-120 G Chiloquin HS

TestCode: LEAD_DW

Sample ID: MB-23223	SampType: MBLK	TestCode: LEAD_DW	Units: ppb	Prep Date: 11/2/2023	RunNo: 43919
Client ID: PBW	Batch ID: 23223	TestNo: E200.8	E200.8	Analysis Date: 11/6/2023	SeqNo: 732516
Analyte	Result	PQL	SPK value	SPK Ref Val	%REC LowLimit HighLimit RPD Ref Val %RPD RPDLimit Qual
Lead	ND	0.515			

Sample ID: LCS-23223	SampType: LCS	TestCode: LEAD_DW	Units: ppb	Prep Date: 11/2/2023	RunNo: 43919
Client ID: LCSW	Batch ID: 23223	TestNo: E200.8	E200.8	Analysis Date: 11/6/2023	SeqNo: 732517
Analyte	Result	PQL	SPK value	SPK Ref Val	%REC LowLimit HighLimit RPD Ref Val %RPD RPDLimit Qual
Lead	105	0.520	100	0	105 85 115

Sample ID: 23101128-41AMS	SampType: MS	TestCode: LEAD_DW	Units: ppb	Prep Date: 11/2/2023	RunNo: 43919
Client ID: 23-120G.CH42	Batch ID: 23223	TestNo: E200.8	E200.8	Analysis Date: 11/6/2023	SeqNo: 732519
Analyte	Result	PQL	SPK value	SPK Ref Val	%REC LowLimit HighLimit RPD Ref Val %RPD RPDLimit Qual
Lead	102	0.520	100	1.11	101 70 130

Sample ID: 23101128-41AMSD	SampType: MSD	TestCode: LEAD_DW	Units: ppb	Prep Date: 11/2/2023	RunNo: 43919
Client ID: 23-120G.CH42	Batch ID: 23223	TestNo: E200.8	E200.8	Analysis Date: 11/6/2023	SeqNo: 732520
Analyte	Result	PQL	SPK value	SPK Ref Val	%REC LowLimit HighLimit RPD Ref Val %RPD RPDLimit Qual
Lead	103	0.520	100	1.11	102 70 130 102 0.531 20

Qualifiers: CI Sample container temperature is out of limit as specified at testcode H Holding times for preparation or analysis exceeded MI Recovery outside control limits due to Matrix Int
ND Not Detected at the Reporting Limit PL Permit Limit RL Reporting Detection Limit

Original

Sample Log-In Check List

Client Name: **ColemanCreek**

Work Order Number: **23101128**

RcptNo: **1**

Logged by: **Tamra Schmedemann** **10/26/2023 3:15:00 PM**

Tamra Schmedemann

Completed By: **Erin Hernandez** **10/27/2023 5:02:00 PM**

Erin Hernandez

Reviewed By: **Jordan Diemer** **11/8/2023 12:18:52 PM**

Jordan Diemer

Chain of Custody

1. Is Chain of Custody complete? Yes ☒ No ☐ Not Present ☐
2. How was the sample delivered? Client

Log In

3. Coolers are present? Yes ☐ No ☐ NA ☒
4. Shipping container/cooler in good condition? Yes ☒ No ☐
Custody seals intact on shipping container/cooler? Yes ☐ No ☐ Not Present ☒
No. Seal Date: Signed By:
5. Was an attempt made to cool the samples? Yes ☐ No ☐ NA ☒
6. Were all samples received at a temperature of $>0^{\circ}\text{C}$ to 6.0°C ? Yes ☐ No ☐ NA ☒
7. Sample(s) in proper container(s)? Yes ☒ No ☐
8. Sufficient sample volume for indicated test(s)? Yes ☒ No ☐
9. Are samples (except VOA and ONG) properly preserved? Yes ☒ No ☐
10. Was preservative added to bottles? Yes ☒ No ☐ NA ☐
HNO₃ pH<2
11. Is the headspace in the VOA vials less than 1/4 inch or 6 mm? Yes ☐ No ☐ No VOA Vials ☒
12. Were any sample containers received broken? Yes ☐ No ☒
13. Does paperwork match bottle labels? Yes ☒ No ☐
(Note discrepancies on chain of custody)
14. Are matrices correctly identified on Chain of Custody? Yes ☒ No ☐
15. Is it clear what analyses were requested? Yes ☒ No ☐
16. Were all holding times able to be met? Yes ☒ No ☐
(If no, notify customer for authorization.)

Special Handling (if applicable)

17. Was client notified of all discrepancies with this order? Yes ☐ No ☐ NA ☒

Person Notified: Date
By Whom: Via: ☐ eMail ☐ Phone ☐ Fax ☐ In Person
Regarding:
Client Instructions:

18. Additional remarks:

Cooler Information

Cooler No	Temp °C	Condition	Seal Intact	Seal No	Seal Date	Signed By
-----------	---------	-----------	-------------	---------	-----------	-----------

