

Coleman Creek Consulting, Inc.

## **DRINKING WATER LEAD SAMPLING**

OF

**CHILOQUIN ELEMENTARY SCHOOL**

**548 S. 2<sup>ND</sup> AVENUE, CHILOQUIN, OREGON**

FOR

**KLAMATH COUNTY SCHOOL DISTRICT**

### **INTRODUCTION**

Coleman Creek Consulting, Inc. (CCC) was retained by Klamath County School District (KCSD) to perform representative lead drinking water sampling of Chiloquin Elementary School (Chiloquin ES) at the above address. The purpose of the lead drinking water sampling was to determine the concentration of lead in representative drinking water sources and compare with regulatory standards. In 2017, Education Service Districts were required to adopt a Healthy and Safe Schools Plan, including provisions for testing and reducing exposure to elevated levels of lead in water used for drinking and food preparation.

### **LEAD DRINKING WATER SAMPLING REQUIREMENTS**

Guidelines for sampling lead in water were established by the Oregon Health Authority. Water sampling is to occur after water sits overnight in the pipes without being used, and must be sampled after a day occupied by students or building occupants. All water sources are to be sampled, with the exception of water used for heating, sanitation, irrigation, and science sinks for grades 6 and up with non-potable water signs. Initial testing is required to be performed by 2020, and every 6 years thereafter, according to a testing schedule determined by the Oregon Department of Education.

### **SAMPLE LOCATION DETERMINATION/SAMPLE PREP**

David W. Fawcett of CCC contacted Michael Newman, Head Custodian at Chiloquin ES, and discussed the objectives of the lead drinking water program. Mr. Newman reviewed the School buildings for water sources and identified by type on a building floor plan. Mr. Fawcett and Mr. Newman discussed the drinking water sources by phone, and Mr. Fawcett created a Site Sample Record Sheet describing each drinking water source by type and location. Mr. Fawcett identified each source by number (CE1-CE53), and identified each source number on a floor plan diagram of the school building. There was no sample CE24 collected. Mr. Fawcett delivered the following sampling materials to Mr. Newman October 25, 2023: Numbered sample containers, Site Sample Record Sheet filled out with Sample Number, Sample Type, and Location. Mr. Newman was instructed in proper sampling technique, including sampling prior to water system use by other school occupants, fill sample container immediately from faucet opening, and recording time of water sampling on the Site Sample Record Sheets (pages 3-5).

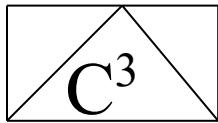

# Coleman Creek Consulting, Inc.

## **DRINKING WATER SAMPLING**

Mr. Newman collected lead drinking water samples from the drinking water sources identified in Chiloquin Elementary School October 26, 2023. See Site Sample Record Sheets (pages 3-5) for a description of the drinking water sources sampled. See Drinking Water Sample Location Diagram in Appendix A for a visual review of all drinking water sample locations. The drinking water samples were collected in the early morning, ensuring that the sample source had not been in use since the previous day. The samples were placed in a cooler. Mr. Fawcett picked up the samples collected by Mr. Newman October 26, 2023, and transported to Neilson Research Corporation in Medford, Oregon.

## **DRINKING WATER LEAD RESULTS AND TESTING SUMMARY SHEETS**

The fifty-two (52) drinking water samples collected were analyzed for lead using EPA Method 200.8. See Neilson Research Corporation Analytical Report in Appendix B. Drinking Water Testing Summary Sheets (pages 6-7) indicate the lead in drinking water concentrations for the fifty-two (52) samples collected from the Chiloquin Elementary School were reported ranging from <0.515 to 3.55 parts per billion (ppb).

## **CONCLUSIONS**

Fifty-two (52) drinking water samples were collected from drinking water sources at the Chiloquin Elementary School Building prior to use that day by building occupants, and after a day the facility was occupied. The lead concentrations reported were all below the 15 ppb lead action level in water.

## **RECOMMENDATIONS**

Coleman Creek Consulting, Inc. recommends continuing the lead drinking water sampling schedule in the future. Coleman Creek Consulting, Inc. appreciates the opportunity to continue to perform environmental sampling and consulting services to Klamath County School District.

David W. Fawcett  
Director of Consulting Services

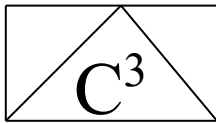

# Coleman Creek Consulting, Inc.

## DRINKING WATER SITE SAMPLE RECORD SHEET

BUILDING: Chiloquin Elementary School  
ADDRESS: 548 S. 2<sup>nd</sup> Avenue  
Chiloquin, Oregon

DATE: 10-26-23  
SAMPLER: Michael Newman

SAMPLE #	SAMPLE TYPE	LOCATION	TIME
23-120G.CE1	DW	Room 19 Sink	0501
23-120G.CE2	DW	Room 19 Fountain	0501
23-120G.CE3	DW	Room 18 Sink	0503
23-120G.CE4	DW	Room 18 Fountain	0503
23-120G.CE5	DW	Cafeteria Drinking Fountain	0503
23-120G.CE6	DW	Kitchen Left Sink	0506
23-120G.CE7	DW	Kitchen Right Sink	0506
23-120G.CE8	DW	Room 17 Sink	0508
23-120G.CE9	DW	Room 17 Fountain	0508
23-120G.CE10	DW	Room 16 Sink	0510
23-120G.CE11	DW	Room 16 Fountain	0510
23-120G.CE12	DW	Hall Drinking Fountain at Room 16	0511
23-120G.CE13	DW	Hall Drinking Fountain at Room 16 Bottle Filler	0511
23-120G.CE14	DW	Staff Break Room Sink	0512
23-120G.CE15	DW	Staff RR Sink	0512
23-120G.CE16	DW	Gym Drinking Fountain	0513
23-120G.CE17	DW	Hall Girl's RR at Room 15, Left Sink	0515
23-120G.CE18	DW	Hall Girl's RR at Room 15, Right Sink	0515
23-120G.CE19	DW	Hall Boy's RR at Room 15, Left Sink	0516
23-120G.CE20	DW	Hall Boy's RR at Room 15, Right Sink	0516

Comments: DW = Drinking Water RR = Restroom R = Right L = Left RM = Right Middle  
LM = Left Middle M = Middle

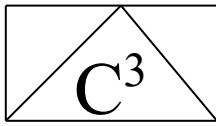

# Coleman Creek Consulting, Inc.

## DRINKING WATER SITE SAMPLE RECORD SHEET

BUILDING: Chiloquin Elementary School  
ADDRESS: 548 S. 2<sup>nd</sup> Avenue  
Chiloquin, Oregon

DATE: 10-26-23  
SAMPLER: Michael Newman

SAMPLE #	SAMPLE TYPE	LOCATION	TIME
23-120G.CE21	DW	Room 15 Sink	0518
23-120G.CE22	DW	Room 15 Fountain	0518
23-120G.CE23	DW	Library Sink	0519
23-120G.CE25	DW	Title 1 Room Sink	0520
23-120G.CE26	DW	Office RR Sink	0522
23-120G.CE27	DW	Library Sink	0523
23-120G.CE28	DW	Hall Girl's RR at Room 9, Left Sink	0525
23-120G.CE29	DW	Hall Girl's RR at Room 9, Right Sink	0525
23-120G.CE30	DW	Hall Boy's RR at Room 10, Left Sink	0526
23-120G.CE31	DW	Hall Boy's RR at Room 10, Left Sink	0526
23-120G.CE32	DW	Hall Drinking Fountain at Room 9	0527
23-120G.CE33	DW	Hall Drinking Fountain at Room 9 Bottle Filler	0527
23-120G.CE34	DW	Room 9 Sink	0529
23-120G.CE35	DW	Room 9 Fountain	0529
23-120G.CE36	DW	Room 10 Sink	0530
23-120G.CE37	DW	Room 10 Fountain	0530
23-120G.CE38	DW	Room 5 Sink	0532
23-120G.CE39	DW	Room 5 Fountain	0532
23-120G.CE40	DW	Room 6 Sink	0533

Comments: DW = Drinking Water RR = Restroom R = Right L = Left RM = Right Middle  
LM = Left Middle M = Middle

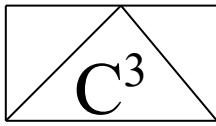

# Coleman Creek Consulting, Inc.

## DRINKING WATER SITE SAMPLE RECORD SHEET

BUILDING: Chiloquin Elementary School  
ADDRESS: 548 S. 2<sup>nd</sup> Avenue  
Chiloquin, Oregon

DATE: 10-26-23  
SAMPLER: Michael Newman

SAMPLE #	SAMPLE TYPE	LOCATION	TIME
23-120G.CE41	DW	Room 6 Fountain	0533
23-120G.CE42	DW	Room 2 Sink	0534
23-120G.CE43	DW	Room 2 Fountain	0534
23-120G.CE44	DW	Room 1 Sink	0536
23-120G.CE45	DW	Room 1 Fountain	0536
23-120G.CE46	DW	Girl's RR at Room 1 Left Sink	0538
23-120G.CE47	DW	Girl's RR at Room 1 Right Sink	0538
23-120G.CE48	DW	Boy's RR at Room 2 Left Sink	0543
23-120G.CE49	DW	Boy's RR at Room 2 Right Sink	0543
23-120G.CE50	DW	Room 3 Sink	0544
23-120G.CE51	DW	Room 3 Fountain	0544
23-120G.CE52	DW	Room 4 Sink	0545
23-120G.CE53	DW	Room 4 Fountain	0545

Comments: DW = Drinking Water RR = Restroom R = Right L = Left RM = Right Middle  
LM = Left Middle M = Middle

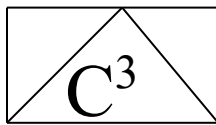

# Coleman Creek Consulting, Inc.

## DRINKING WATER TESTING SUMMARY SHEET

DISTRICT NAME: Klamath County School District  
DISTRICT ID#: 467  
SCHOOL NAME: Chiloquin Elementary School  
BUILDING NAME: Chiloquin Elementary School  
BUILDING ID#: 20570200

Sample Number	Fixture Location/ Description	Fixture ID#	Test Date	Test Result (ppb)	# Retest	Final Result (ppb)
23-120G.CE1	Room 19 Sink	20570200-001CF	10-26-23	<0.515		<0.515
23-120G.CE2	Room 19 Fountain	20570200-002DW	10-26-23	<0.515		<0.515
23-120G.CE3	Room 18 Sink	20570200-003CF	10-26-23	<0.515		<0.515
23-120G.CE4	Room 18 Fountain	20570200-004DW	10-26-23	1.21		1.21
23-120G.CE5	Cafeteria Drinking Fountain	20570200-005DW	10-26-23	0.992		0.992
23-120G.CE6	Kitchen Left Sink	20570200-006KF	10-26-23	<0.515		<0.515
23-120G.CE7	Kitchen Right Sink	20570200-007KF	10-26-23	<0.515		<0.515
23-120G.CE8	Room 17 Sink	20570200-008CF	10-26-23	0.914		0.914
23-120G.CE9	Room 17 Fountain	20570200-009DW	10-26-23	0.853		0.853
23-120G.CE10	Room 16 Sink	20570200-010CF	10-26-23	3.55		3.55
23-120G.CE11	Room 16 Fountain	20570200-011DW	10-26-23	<0.515		<0.515
23-120G.CE12	Hall Drinking Fountain at Room 16	20570200-012DW	10-26-23	<0.515		<0.515
23-120G.CE13	Hall DW at Room 16 - WB	20570200-013WB	10-26-23	<0.515		<0.515
23-120G.CE14	Staff Break Room Sink	20570200-014SF	10-26-23	<0.515		<0.515
23-120G.CE15	Staff RR Sink	20570200-015BF	10-26-23	<0.515		<0.515
23-120G.CE16	Gym Drinking Fountain	20570200-016DW	10-26-23	<0.515		<0.515
23-120G.CE17	Hall Girl's RR at Room 15, Left Sink	20570200-017BF	10-26-23	<0.515		<0.515
23-120G.CE18	Hall Girl's RR at Room 15, Right BF	20570200-018BF	10-26-23	<0.515		<0.515
23-120G.CE19	Hall Boy's RR at Room 15, Left Sink	20570200-019BF	10-26-23	<0.515		<0.515
23-120G.CE20	Hall Boy's RR at Room 15, Right BF	20570200-020BF	10-26-23	<0.515		<0.515
23-120G.CE21	Room 15 Sink	20570200-021CF	10-26-23	<0.515		<0.515
23-120G.CE22	Room 15 Fountain	20570200-022DW	10-26-23	<0.515		<0.515
23-120G.CE23	Library Sink	20570200-023SF	10-26-23	<0.515		<0.515
23-120G.CE25	Title 1 Room Sink	20570200-025SF	10-26-23	<0.515		<0.515
23-120G.CE26	Office RR Sink	20570200-026BF	10-26-23	<0.515		<0.515
23-120G.CE27	Library Sink	20570200-027SF	10-26-23	1.69		1.69
23-120G.CE28	Hall Girl's RR at Room 9, Left Sink	20570200-028BF	10-26-23	<0.515		<0.515
23-120G.CE29	Hall Girl's RR at Room 9, Right Sink	20570200-029BF	10-26-23	<0.515		<0.515
23-120G.CE30	Hall Boy's RR at Room 10, Left Sink	20570200-030BF	10-26-23	<0.515		<0.515
23-120G.CE31	Hall Boy's RR at Room 10, Left Sink	20570200-031BF	10-26-23	<0.515		<0.515
23-120G.CE32	Hall Drinking Fountain at Room 9	20570200-032DW	10-26-23	<0.515		<0.515
23-120G.CE33	Hall DW at Room 9 - WB	20570200-033WB	10-26-23	<0.515		<0.515

Fixture ID Coding:

**Bold Indicates Test Result >15 ppb**

DW = Drinking Water Fountain WC = Water Cooler WB = Water Bottle Filler  
CF = Classroom Faucet BF = Bathroom Faucet SF = Staff/Office Faucet  
KF = Kitchen/Food Prep OS = Outside Spigot OT = Other (Specify)

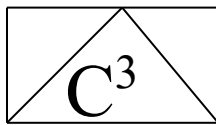

# Coleman Creek Consulting, Inc.

## DRINKING WATER TESTING SUMMARY SHEET

DISTRICT NAME: Klamath County School District  
DISTRICT ID#: 467  
SCHOOL NAME: Chiloquin Elementary School  
BUILDING NAME: Chiloquin Elementary School  
BUILDING ID#: 20570200

Sample Number	Fixture Location/ Description	Fixture ID#	Test Date	Test Result (ppb)	# Retest	Final Result (ppb)
23-120G.CE34	Room 9 Sink	20570200-034CF	10-26-23	<0.515		<0.515
23-120G.CE35	Room 9 Fountain	20570200-035DW	10-26-23	<0.515		<0.515
23-120G.CE36	Room 10 Sink	20570200-036CF	10-26-23	<0.515		<0.515
23-120G.CE37	Room 10 Fountain	20570200-037DW	10-26-23	<0.515		<0.515
23-120G.CE38	Room 5 Sink	20570200-038CF	10-26-23	<0.515		<0.515
23-120G.CE39	Room 5 Fountain	20570200-039DW	10-26-23	<0.515		<0.515
23-120G.CE40	Room 6 Sink	20570200-040CF	10-26-23	0.605		0.605
23-120G.CE41	Room 6 Fountain	20570200-041DW	10-26-23	0.686		0.686
23-120G.CE42	Room 2 Sink	20570200-042CF	10-26-23	0.924		0.924
23-120G.CE43	Room 2 Fountain	20570200-043DW	10-26-23	0.56		0.56
23-120G.CE44	Room 1 Sink	20570200-044CF	10-26-23	<0.515		<0.515
23-120G.CE45	Room 1 Fountain	20570200-045DW	10-26-23	<0.515		<0.515
23-120G.CE46	Girl's RR at Room 1 Left BF	20570200-046BF	10-26-23	<0.515		<0.515
23-120G.CE47	Girl's RR at Room 1 R Sink	20570200-047BF	10-26-23	<0.515		<0.515
23-120G.CE48	Boy's RR at Room 2 Left BF	20570200-048BF	10-26-23	<0.515		<0.515
23-120G.CE49	Boy's RR at Room 2 R Sink	20570200-049BF	10-26-23	<0.515		<0.515
23-120G.CE50	Room 3 Sink	20570200-050CF	10-26-23	<0.515		<0.515
23-120G.CE51	Room 3 Fountain	20570200-051DW	10-26-23	<0.515		<0.515
23-120G.CE52	Room 4 Sink	20571000-052CF	10-26-23	<0.515		<0.515
23-120G.CE53	Room 4 Fountain	20571000-053DW	10-26-23	<0.515		<0.515

Fixture ID Coding:

DW = Drinking Water Fountain WC = Water Cooler WB = Water Bottle Filler  
CF = Classroom Faucet BF = Bathroom Faucet SF = Staff/Office Faucet  
KF = Kitchen/Food Prep OS = Outside Spigot OT = Other (Specify)

**APPENDIX A**

**DRINKING WATER SAMPLE LOCATION  
DIAGRAM**



# CHILOQUIN ELEMENTARY SCHOOL Drinking Water Sample Locations

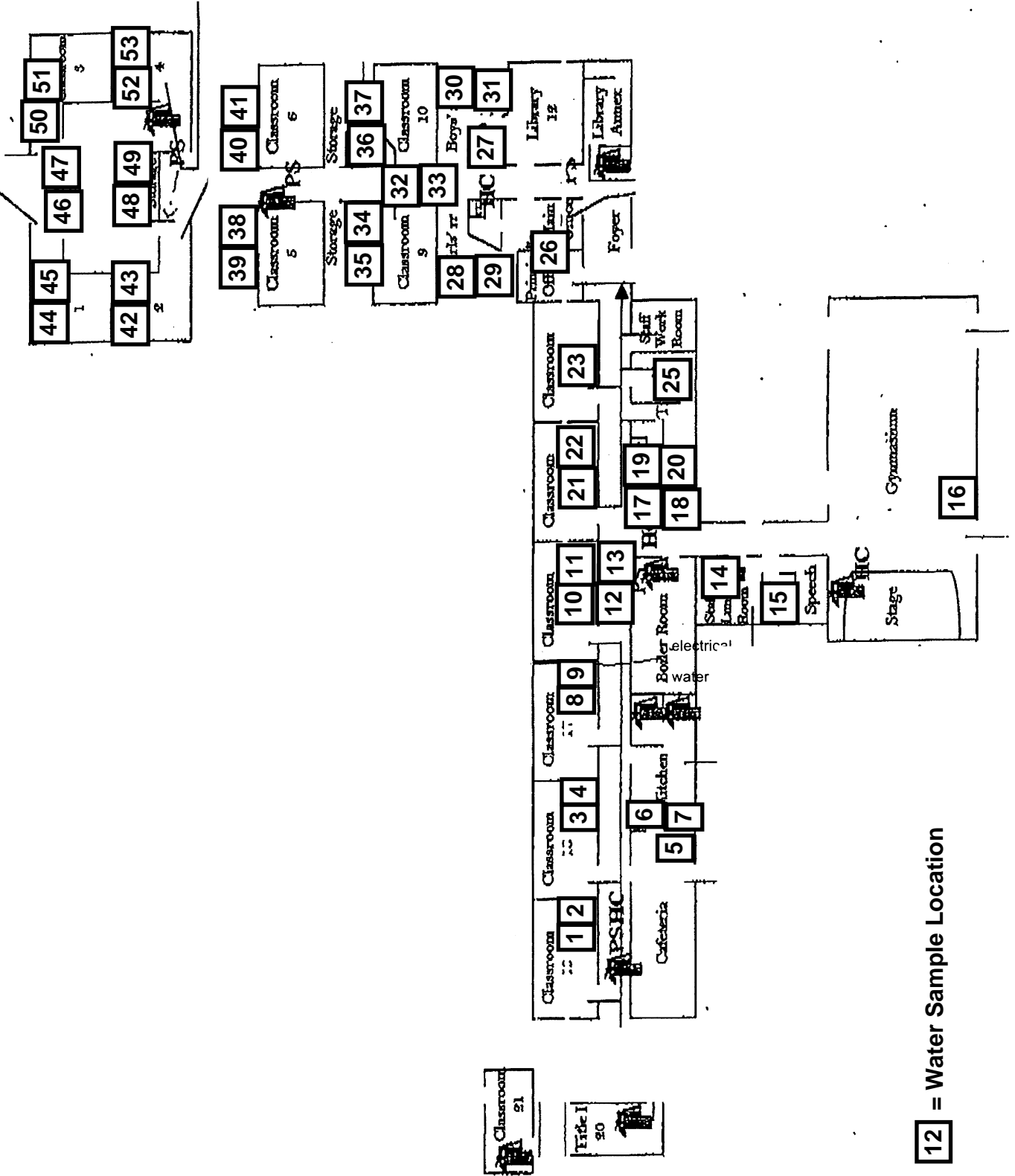

## **APPENDIX B**

### **NEILSON RESEARCH CORPORATION ANALYTICAL REPORT**



Neilson Research Corporation  
245 S Grape St  
Medford, OR 97501  
TEL: (541) 770-5678 FAX: (541) 770-2901  
Website: [www.nrclabs.com](http://www.nrclabs.com)

November 09, 2023

Dave Fawcett  
Coleman Creek Consulting  
810 Leonard St  
Ashland, OR 97520  
TEL: (541) 535-7108  
FAX (541) 535-8795

RE: 23-120G Chiloquin ES School Lead

Order No.: 23101132

Dear Dave Fawcett:

Neilson Research Corporation received 52 sample(s) on 10/26/2023 for the analyses presented in the following report.

The results relate only to the parameters tested or to the sample as received by the laboratory. This report shall not be reproduced except in full, without the written approval of Neilson Research Corporation. If you have any questions regarding these test results, please feel free to call.

Sincerely,  
Neilson Research Corporation

Tamra Schmedemann  
Senior Project Manager  
245 S Grape St  
Medford, OR 97501



Original



Neilson Research Corporation  
245 S Grape St  
Medford, OR 97501  
TEL: (541) 770-5678 FAX: (541) 770-2901  
Website: [www.nrclabs.com](http://www.nrclabs.com)

## Case Narrative

WO#: 23101132  
Date: 11/9/2023

---

**CLIENT:** Coleman Creek Consulting

**Project:** 23-120G Chiloquin ES School Lead

---

The analyses were performed according to the guidelines in the Neilson Research Corporation Quality Assurance Program. This report contains analytical results for the sample(s) as received by the laboratory.

Neilson Research Corporation certifies that this report is in compliance with the requirements of NELAP. No unusual difficulties were experienced during analysis of this batch except as noted below or qualified with data flags on the reports.

---

Original



Neilson Research Corporation  
245 S Grape St  
Medford, OR 97501  
TEL: (541) 770-5678 FAX: (541) 770-2901  
Website: www.nrclabs.com

## Analytical Report

WO#: 23101132

Date Reported: 11/9/2023

Coleman Creek Consulting  
810 Leonard St  
Ashland, OR 97520

**Lab Order:** 23101132  
**Received Date:** 10/26/2023 3:27:00 PM  
**Reported Date:** 11/9/2023 11:46:10 AM

Sample Information:

**Lab ID:** 23101132-01 **Client Sample ID:** 23-120G.CE1  
**Collection Date:** 10/26/2023 5:01:00 AM **Collected By:** Michael Newman  
**Matrix:** Drinking Water **Sample Location:** Room 19 Sink

Trace Metals by EPA 200.8 ICP-MS							Analyst: CJS	
Analyses	Result	Qual	MRL	Units	DF	Date Analyzed	MCL	NELAP Status
Lead	ND		0.515	ppb	1	11/6/2023	15.0	A

**Lab ID:** 23101132-02 **Client Sample ID:** 23-120G.CE2  
**Collection Date:** 10/26/2023 5:01:00 AM **Collected By:** Michael Newman  
**Matrix:** Drinking Water **Sample Location:** Room 19 Fountain

Trace Metals by EPA 200.8 ICP-MS							Analyst: CJS	
Analyses	Result	Qual	MRL	Units	DF	Date Analyzed	MCL	NELAP Status
Lead	ND		0.515	ppb	1	11/6/2023	15.0	A

**Lab ID:** 23101132-03 **Client Sample ID:** 23-120G.CE3  
**Collection Date:** 10/26/2023 5:03:00 AM **Collected By:** Michael Newman  
**Matrix:** Drinking Water **Sample Location:** Room 18 Sink

Trace Metals by EPA 200.8 ICP-MS							Analyst: CJS	
Analyses	Result	Qual	MRL	Units	DF	Date Analyzed	MCL	NELAP Status
Lead	ND		0.515	ppb	1	11/6/2023	15.0	A

QUALIFIERS	*	Value exceeds Maximum Contaminant Level.	C1	Sample container temperature is out of limit as specified at testcode
	E	Value above quantitation range	H	Holding times for preparation or analysis exceeded
	J	Analyte detected below quantitation limits	MI	Recovery outside control limits due to Matrix Interference
	ND	Not Detected at the Reporting Limit	PL	Permit Limit
	PRE	Percent RE exceeds the Limit	R	RPD outside accepted recovery limits

NELAP A Accredited in accordance with NELAP ORELAP 100016, OR-028

Original



Neilson Research Corporation  
245 S Grape St  
Medford, OR 97501  
TEL: (541) 770-5678 FAX: (541) 770-2901  
Website: www.nrclabs.com

## Analytical Report

WO#: 23101132

Date Reported: 11/9/2023

Coleman Creek Consulting  
810 Leonard St  
Ashland, OR 97520

**Lab Order:** 23101132  
**Received Date:** 10/26/2023 3:27:00 PM  
**Reported Date:** 11/9/2023 11:46:10 AM

Sample Information:

**Lab ID:** 23101132-04 **Client Sample ID:** 23-120G.CE4  
**Collection Date:** 10/26/2023 5:03:00 AM **Collected By:** Michael Newman  
**Matrix:** Drinking Water **Sample Location:** Room 18 Fountain

Trace Metals by EPA 200.8 ICP-MS							Analyst: CJS	
Analyses	Result	Qual	MRL	Units	DF	Date Analyzed	MCL	NELAP Status
Lead	1.21		0.515	ppb	1	11/6/2023	15.0	A

**Lab ID:** 23101132-05 **Client Sample ID:** 23-120G.CE5  
**Collection Date:** 10/26/2023 5:03:00 AM **Collected By:** Michael Newman  
**Matrix:** Drinking Water **Sample Location:** Cafeteria DF

Trace Metals by EPA 200.8 ICP-MS							Analyst: CJS	
Analyses	Result	Qual	MRL	Units	DF	Date Analyzed	MCL	NELAP Status
Lead	0.992		0.515	ppb	1	11/6/2023	15.0	A

**Lab ID:** 23101132-06 **Client Sample ID:** 23-120G.CE6  
**Collection Date:** 10/26/2023 5:06:00 AM **Collected By:** Michael Newman  
**Matrix:** Drinking Water **Sample Location:** Kitchen L Sink

Trace Metals by EPA 200.8 ICP-MS							Analyst: CJS	
Analyses	Result	Qual	MRL	Units	DF	Date Analyzed	MCL	NELAP Status
Lead	ND		0.515	ppb	1	11/6/2023	15.0	A

QUALIFIERS	*	Value exceeds Maximum Contaminant Level.	C1	Sample container temperature is out of limit as specified at testcode
	E	Value above quantitation range	H	Holding times for preparation or analysis exceeded
	J	Analyte detected below quantitation limits	MI	Recovery outside control limits due to Matrix Interference
	ND	Not Detected at the Reporting Limit	PL	Permit Limit
	PRE	Percent RE exceeds the Limit	R	RPD outside accepted recovery limits

NELAP A Accredited in accordance with NELAP ORELAP 100016, OR-028

Original



Neilson Research Corporation  
245 S Grape St  
Medford, OR 97501  
TEL: (541) 770-5678 FAX: (541) 770-2901  
Website: www.nrclabs.com

## Analytical Report

WO#: 23101132

Date Reported: 11/9/2023

Coleman Creek Consulting  
810 Leonard St  
Ashland, OR 97520

**Lab Order:** 23101132  
**Received Date:** 10/26/2023 3:27:00 PM  
**Reported Date:** 11/9/2023 11:46:10 AM

Sample Information:

**Lab ID:** 23101132-07 **Client Sample ID:** 23-120G.CE7  
**Collection Date:** 10/26/2023 5:06:00 AM **Collected By:** Michael Newman  
**Matrix:** Drinking Water **Sample Location:** Kitchen R Sink

Trace Metals by EPA 200.8 ICP-MS							Analyst: CJS	
Analyses	Result	Qual	MRL	Units	DF	Date Analyzed	MCL	NELAP Status
Lead	ND		0.515	ppb	1	11/6/2023	15.0	A

**Lab ID:** 23101132-08 **Client Sample ID:** 23-120G.CE8  
**Collection Date:** 10/26/2023 5:08:00 AM **Collected By:** Michael Newman  
**Matrix:** Drinking Water **Sample Location:** Room 17 Sink

Trace Metals by EPA 200.8 ICP-MS							Analyst: CJS	
Analyses	Result	Qual	MRL	Units	DF	Date Analyzed	MCL	NELAP Status
Lead	0.914		0.515	ppb	1	11/6/2023	15.0	A

**Lab ID:** 23101132-09 **Client Sample ID:** 23-120G.CE9  
**Collection Date:** 10/26/2023 5:08:00 AM **Collected By:** Michael Newman  
**Matrix:** Drinking Water **Sample Location:** Room 17 Fountain

Trace Metals by EPA 200.8 ICP-MS							Analyst: CJS	
Analyses	Result	Qual	MRL	Units	DF	Date Analyzed	MCL	NELAP Status
Lead	0.853		0.515	ppb	1	11/6/2023	15.0	A

QUALIFIERS	*	Value exceeds Maximum Contaminant Level.	C1	Sample container temperature is out of limit as specified at testcode
	E	Value above quantitation range	H	Holding times for preparation or analysis exceeded
	J	Analyte detected below quantitation limits	MI	Recovery outside control limits due to Matrix Interference
	ND	Not Detected at the Reporting Limit	PL	Permit Limit
	PRE	Percent RE exceeds the Limit	R	RPD outside accepted recovery limits

NELAP A Accredited in accordance with NELAP ORELAP 100016, OR-028

Original



Neilson Research Corporation  
245 S Grape St  
Medford, OR 97501  
TEL: (541) 770-5678 FAX: (541) 770-2901  
Website: www.nrclabs.com

## Analytical Report

WO#: 23101132

Date Reported: 11/9/2023

Coleman Creek Consulting  
810 Leonard St  
Ashland, OR 97520

**Lab Order:** 23101132  
**Received Date:** 10/26/2023 3:27:00 PM  
**Reported Date:** 11/9/2023 11:46:10 AM

Sample Information:

**Lab ID:** 23101132-10 **Client Sample ID:** 23-120G.CE10  
**Collection Date:** 10/26/2023 5:10:00 AM **Collected By:** Michael Newman  
**Matrix:** Drinking Water **Sample Location:** Room 16 Sink

Trace Metals by EPA 200.8 ICP-MS							Analyst: CJS	
Analyses	Result	Qual	MRL	Units	DF	Date Analyzed	MCL	NELAP Status
Lead	3.55		0.515	ppb	1	11/6/2023	15.0	A

**Lab ID:** 23101132-11 **Client Sample ID:** 23-120G.CE11  
**Collection Date:** 10/26/2023 5:10:00 AM **Collected By:** Michael Newman  
**Matrix:** Drinking Water **Sample Location:** Room 16 Fountain

Trace Metals by EPA 200.8 ICP-MS							Analyst: CJS	
Analyses	Result	Qual	MRL	Units	DF	Date Analyzed	MCL	NELAP Status
Lead	ND		0.515	ppb	1	11/6/2023	15.0	A

**Lab ID:** 23101132-12 **Client Sample ID:** 23-120G.CE12  
**Collection Date:** 10/26/2023 5:11:00 AM **Collected By:** Michael Newman  
**Matrix:** Drinking Water **Sample Location:** Hall DF at Room 16

Trace Metals by EPA 200.8 ICP-MS							Analyst: CJS	
Analyses	Result	Qual	MRL	Units	DF	Date Analyzed	MCL	NELAP Status
Lead	ND		0.515	ppb	1	11/6/2023	15.0	A

QUALIFIERS	*	Value exceeds Maximum Contaminant Level.	C1	Sample container temperature is out of limit as specified at testcode
	E	Value above quantitation range	H	Holding times for preparation or analysis exceeded
	J	Analyte detected below quantitation limits	MI	Recovery outside control limits due to Matrix Interference
	ND	Not Detected at the Reporting Limit	PL	Permit Limit
	PRE	Percent RE exceeds the Limit	R	RPD outside accepted recovery limits

NELAP A Accredited in accordance with NELAP ORELAP 100016, OR-028

Original





Neilson Research Corporation  
245 S Grape St  
Medford, OR 97501  
TEL: (541) 770-5678 FAX: (541) 770-2901  
Website: www.nrclabs.com

## Analytical Report

WO#: 23101132

Date Reported: 11/9/2023

Coleman Creek Consulting  
810 Leonard St  
Ashland, OR 97520

**Lab Order:** 23101132  
**Received Date:** 10/26/2023 3:27:00 PM  
**Reported Date:** 11/9/2023 11:46:10 AM

Sample Information:

**Lab ID:** 23101132-13 **Client Sample ID:** 23-120G.CE13  
**Collection Date:** 10/26/2023 5:11:00 AM **Collected By:** Michael Newman  
**Matrix:** Drinking Water **Sample Location:** Hall DF at Rm 16 Bottle Filler

Trace Metals by EPA 200.8 ICP-MS							Analyst: CJS	
Analyses	Result	Qual	MRL	Units	DF	Date Analyzed	MCL	NELAP Status
Lead	ND		0.515	ppb	1	11/6/2023	15.0	A

**Lab ID:** 23101132-14 **Client Sample ID:** 23-120G.CE14  
**Collection Date:** 10/26/2023 5:12:00 AM **Collected By:** Michael Newman  
**Matrix:** Drinking Water **Sample Location:** Staff Break Room Sink

Trace Metals by EPA 200.8 ICP-MS							Analyst: CJS	
Analyses	Result	Qual	MRL	Units	DF	Date Analyzed	MCL	NELAP Status
Lead	ND		0.515	ppb	1	11/6/2023	15.0	A

**Lab ID:** 23101132-15 **Client Sample ID:** 23-120G.CE15  
**Collection Date:** 10/26/2023 5:12:00 AM **Collected By:** Michael Newman  
**Matrix:** Drinking Water **Sample Location:** Staff RR Sink

Trace Metals by EPA 200.8 ICP-MS							Analyst: CJS	
Analyses	Result	Qual	MRL	Units	DF	Date Analyzed	MCL	NELAP Status
Lead	ND		0.515	ppb	1	11/6/2023	15.0	A

QUALIFIERS	*	Value exceeds Maximum Contaminant Level.	C1	Sample container temperature is out of limit as specified at testcode
	E	Value above quantitation range	H	Holding times for preparation or analysis exceeded
	J	Analyte detected below quantitation limits	MI	Recovery outside control limits due to Matrix Interference
	ND	Not Detected at the Reporting Limit	PL	Permit Limit
	PRE	Percent RE exceeds the Limit	R	RPD outside accepted recovery limits

NELAP A Accredited in accordance with NELAP ORELAP 100016, OR-028

Original



Neilson Research Corporation  
245 S Grape St  
Medford, OR 97501  
TEL: (541) 770-5678 FAX: (541) 770-2901  
Website: www.nrclabs.com

## Analytical Report

WO#: 23101132

Date Reported: 11/9/2023

Coleman Creek Consulting  
810 Leonard St  
Ashland, OR 97520

**Lab Order:** 23101132  
**Received Date:** 10/26/2023 3:27:00 PM  
**Reported Date:** 11/9/2023 11:46:10 AM

Sample Information:

**Lab ID:** 23101132-16 **Client Sample ID:** 23-120G.CE16  
**Collection Date:** 10/26/2023 5:13:00 AM **Collected By:** Michael Newman  
**Matrix:** Drinking Water **Sample Location:** Gym Drinking Fountain

Trace Metals by EPA 200.8 ICP-MS								Analyst:	CJS
Analyses	Result	Qual	MRL	Units	DF	Date Analyzed	MCL	NELAP Status	
Lead	ND		0.515	ppb	1	11/6/2023	15.0	A	

**Lab ID:** 23101132-17 **Client Sample ID:** 23-120G.CE17  
**Collection Date:** 10/26/2023 5:15:00 AM **Collected By:** Michael Newman  
**Matrix:** Drinking Water **Sample Location:** Hall Girl's RR at Rm 15 L Sink

Trace Metals by EPA 200.8 ICP-MS								Analyst:	CJS
Analyses	Result	Qual	MRL	Units	DF	Date Analyzed	MCL	NELAP Status	
Lead	ND		0.515	ppb	1	11/6/2023	15.0	A	

**Lab ID:** 23101132-18 **Client Sample ID:** 23-120G.CE18  
**Collection Date:** 10/26/2023 5:15:00 AM **Collected By:** Michael Newman  
**Matrix:** Drinking Water **Sample Location:** Hall Girl's RR at Rm 15 R Sink

Trace Metals by EPA 200.8 ICP-MS								Analyst:	CJS
Analyses	Result	Qual	MRL	Units	DF	Date Analyzed	MCL	NELAP Status	
Lead	ND		0.515	ppb	1	11/6/2023	15.0	A	

QUALIFIERS	*	Value exceeds Maximum Contaminant Level.	C1	Sample container temperature is out of limit as specified at testcode
	E	Value above quantitation range	H	Holding times for preparation or analysis exceeded
	J	Analyte detected below quantitation limits	MI	Recovery outside control limits due to Matrix Interference
	ND	Not Detected at the Reporting Limit	PL	Permit Limit
	PRE	Percent RE exceeds the Limit	R	RPD outside accepted recovery limits

**NELAP** A Accredited in accordance with NELAP ORELAP 100016, OR-028

Original



Neilson Research Corporation  
245 S Grape St  
Medford, OR 97501  
TEL: (541) 770-5678 FAX: (541) 770-2901  
Website: www.nrclabs.com

## Analytical Report

WO#: 23101132

Date Reported: 11/9/2023

Coleman Creek Consulting  
810 Leonard St  
Ashland, OR 97520

**Lab Order:** 23101132  
**Received Date:** 10/26/2023 3:27:00 PM  
**Reported Date:** 11/9/2023 11:46:10 AM

Sample Information:

**Lab ID:** 23101132-19 **Client Sample ID:** 23-120G.CE19  
**Collection Date:** 10/26/2023 5:16:00 AM **Collected By:** Michael Newman  
**Matrix:** Drinking Water **Sample Location:** Hall Boy's RR at Rm 15 L Sink

Trace Metals by EPA 200.8 ICP-MS								Analyst:	CJS
Analyses	Result	Qual	MRL	Units	DF	Date Analyzed	MCL	NELAP Status	
Lead	ND		0.515	ppb	1	11/6/2023	15.0	A	

**Lab ID:** 23101132-20 **Client Sample ID:** 23-120G.CE20  
**Collection Date:** 10/26/2023 5:16:00 AM **Collected By:** Michael Newman  
**Matrix:** Drinking Water **Sample Location:** Hall Boy's RR at Rm 15 L Sink

Trace Metals by EPA 200.8 ICP-MS								Analyst:	CJS
Analyses	Result	Qual	MRL	Units	DF	Date Analyzed	MCL	NELAP Status	
Lead	ND		0.515	ppb	1	11/6/2023	15.0	A	

**Lab ID:** 23101132-21 **Client Sample ID:** 23-120G.CE21  
**Collection Date:** 10/26/2023 5:18:00 AM **Collected By:** Michael Newman  
**Matrix:** Drinking Water **Sample Location:** Room 15 Sink

Trace Metals by EPA 200.8 ICP-MS								Analyst:	CJS
Analyses	Result	Qual	MRL	Units	DF	Date Analyzed	MCL	NELAP Status	
Lead	ND		0.515	ppb	1	11/6/2023	15.0	A	

QUALIFIERS	*	Value exceeds Maximum Contaminant Level.	C1	Sample container temperature is out of limit as specified at testcode
	E	Value above quantitation range	H	Holding times for preparation or analysis exceeded
	J	Analyte detected below quantitation limits	MI	Recovery outside control limits due to Matrix Interference
	ND	Not Detected at the Reporting Limit	PL	Permit Limit
	PRE	Percent RE exceeds the Limit	R	RPD outside accepted recovery limits

**NELAP** A Accredited in accordance with NELAP ORELAP 100016, OR-028

Original



Neilson Research Corporation  
245 S Grape St  
Medford, OR 97501  
TEL: (541) 770-5678 FAX: (541) 770-2901  
Website: www.nrclabs.com

## Analytical Report

WO#: 23101132

Date Reported: 11/9/2023

Coleman Creek Consulting  
810 Leonard St  
Ashland, OR 97520

**Lab Order:** 23101132  
**Received Date:** 10/26/2023 3:27:00 PM  
**Reported Date:** 11/9/2023 11:46:10 AM

Sample Information:

**Lab ID:** 23101132-22 **Client Sample ID:** 23-120G.CE22  
**Collection Date:** 10/26/2023 5:18:00 AM **Collected By:** Michael Newman  
**Matrix:** Drinking Water **Sample Location:** Room 15 Fountain

Trace Metals by EPA 200.8 ICP-MS							Analyst: CJS	
Analyses	Result	Qual	MRL	Units	DF	Date Analyzed	MCL	NELAP Status
Lead	ND		0.515	ppb	1	11/6/2023	15.0	A

**Lab ID:** 23101132-23 **Client Sample ID:** 23-120G.CE23  
**Collection Date:** 10/26/2023 5:19:00 AM **Collected By:** Michael Newman  
**Matrix:** Drinking Water **Sample Location:** Room 14 Sink

Trace Metals by EPA 200.8 ICP-MS							Analyst: CJS	
Analyses	Result	Qual	MRL	Units	DF	Date Analyzed	MCL	NELAP Status
Lead	ND		0.515	ppb	1	11/6/2023	15.0	A

**Lab ID:** 23101132-24 **Client Sample ID:** 23-120G.CE25  
**Collection Date:** 10/26/2023 5:20:00 AM **Collected By:** Michael Newman  
**Matrix:** Drinking Water **Sample Location:** Title 1 Room Sink

Trace Metals by EPA 200.8 ICP-MS							Analyst: CJS	
Analyses	Result	Qual	MRL	Units	DF	Date Analyzed	MCL	NELAP Status
Lead	ND		0.515	ppb	1	11/6/2023	15.0	A

QUALIFIERS	*	Value exceeds Maximum Contaminant Level.	C1	Sample container temperature is out of limit as specified at testcode
	E	Value above quantitation range	H	Holding times for preparation or analysis exceeded
	J	Analyte detected below quantitation limits	MI	Recovery outside control limits due to Matrix Interference
	ND	Not Detected at the Reporting Limit	PL	Permit Limit
	PRE	Percent RE exceeds the Limit	R	RPD outside accepted recovery limits

**NELAP** NELAP A Accredited in accordance with NELAP ORELAP 100016, OR-028

Original



Neilson Research Corporation  
245 S Grape St  
Medford, OR 97501  
TEL: (541) 770-5678 FAX: (541) 770-2901  
Website: www.nrclabs.com

## Analytical Report

WO#: 23101132

Date Reported: 11/9/2023

Coleman Creek Consulting  
810 Leonard St  
Ashland, OR 97520

**Lab Order:** 23101132  
**Received Date:** 10/26/2023 3:27:00 PM  
**Reported Date:** 11/9/2023 11:46:10 AM

Sample Information:

**Lab ID:** 23101132-25 **Client Sample ID:** 23-120G.CE26  
**Collection Date:** 10/26/2023 5:22:00 AM **Collected By:** Michael Newman  
**Matrix:** Drinking Water **Sample Location:** Office RR Sink

Trace Metals by EPA 200.8 ICP-MS							Analyst: CJS	
Analyses	Result	Qual	MRL	Units	DF	Date Analyzed	MCL	NELAP Status
Lead	ND		0.515	ppb	1	11/6/2023	15.0	A

**Lab ID:** 23101132-26 **Client Sample ID:** 23-120G.CE27  
**Collection Date:** 10/26/2023 5:23:00 AM **Collected By:** Michael Newman  
**Matrix:** Drinking Water **Sample Location:** Library Sink

Trace Metals by EPA 200.8 ICP-MS							Analyst: CJS	
Analyses	Result	Qual	MRL	Units	DF	Date Analyzed	MCL	NELAP Status
Lead	1.69		0.515	ppb	1	11/6/2023	15.0	A

**Lab ID:** 23101132-27 **Client Sample ID:** 23-120G.CE28  
**Collection Date:** 10/26/2023 5:25:00 AM **Collected By:** Michael Newman  
**Matrix:** Drinking Water **Sample Location:** Hall Girl's RR at Rm 9 L Sink

Trace Metals by EPA 200.8 ICP-MS							Analyst: CJS	
Analyses	Result	Qual	MRL	Units	DF	Date Analyzed	MCL	NELAP Status
Lead	ND		0.515	ppb	1	11/6/2023	15.0	A

QUALIFIERS	*	Value exceeds Maximum Contaminant Level.	C1	Sample container temperature is out of limit as specified at testcode
	E	Value above quantitation range	H	Holding times for preparation or analysis exceeded
	J	Analyte detected below quantitation limits	MI	Recovery outside control limits due to Matrix Interference
	ND	Not Detected at the Reporting Limit	PL	Permit Limit
	PRE	Percent RE exceeds the Limit	R	RPD outside accepted recovery limits

NELAP A Accredited in accordance with NELAP ORELAP 100016, OR-028

Original



Neilson Research Corporation  
245 S Grape St  
Medford, OR 97501  
TEL: (541) 770-5678 FAX: (541) 770-2901  
Website: www.nrclabs.com

## Analytical Report

WO#: 23101132

Date Reported: 11/9/2023

Coleman Creek Consulting  
810 Leonard St  
Ashland, OR 97520

**Lab Order:** 23101132  
**Received Date:** 10/26/2023 3:27:00 PM  
**Reported Date:** 11/9/2023 11:46:10 AM

Sample Information:

**Lab ID:** 23101132-28 **Client Sample ID:** 23-120G.CE29  
**Collection Date:** 10/26/2023 5:25:00 AM **Collected By:** Michael Newman  
**Matrix:** Drinking Water **Sample Location:** Hall Girl's RR at Rm 9 R Sink

Trace Metals by EPA 200.8 ICP-MS								Analyst:	CJS
Analyses	Result	Qual	MRL	Units	DF	Date Analyzed	MCL	NELAP Status	
Lead	ND		0.515	ppb	1	11/6/2023	15.0	A	

**Lab ID:** 23101132-29 **Client Sample ID:** 23-120G.CE30  
**Collection Date:** 10/26/2023 5:26:00 AM **Collected By:** Michael Newman  
**Matrix:** Drinking Water **Sample Location:** Hall Boy's RR at Rm 10 L Sink

Trace Metals by EPA 200.8 ICP-MS								Analyst:	CJS
Analyses	Result	Qual	MRL	Units	DF	Date Analyzed	MCL	NELAP Status	
Lead	ND		0.515	ppb	1	11/6/2023	15.0	A	

**Lab ID:** 23101132-30 **Client Sample ID:** 23-120G.CE31  
**Collection Date:** 10/26/2023 5:26:00 AM **Collected By:** Michael Newman  
**Matrix:** Drinking Water **Sample Location:** Hall Boy's RR at Rm 10 R Sink

Trace Metals by EPA 200.8 ICP-MS								Analyst:	CJS
Analyses	Result	Qual	MRL	Units	DF	Date Analyzed	MCL	NELAP Status	
Lead	ND		0.515	ppb	1	11/6/2023	15.0	A	

QUALIFIERS	*	Value exceeds Maximum Contaminant Level.	C1	Sample container temperature is out of limit as specified at testcode
	E	Value above quantitation range	H	Holding times for preparation or analysis exceeded
	J	Analyte detected below quantitation limits	MI	Recovery outside control limits due to Matrix Interference
	ND	Not Detected at the Reporting Limit	PL	Permit Limit
	PRE	Percent RE exceeds the Limit	R	RPD outside accepted recovery limits

**NELAP** NELAP A Accredited in accordance with NELAP ORELAP 100016, OR-028

Original



Neilson Research Corporation  
245 S Grape St  
Medford, OR 97501  
TEL: (541) 770-5678 FAX: (541) 770-2901  
Website: www.nrclabs.com

## Analytical Report

WO#: 23101132

Date Reported: 11/9/2023

Coleman Creek Consulting  
810 Leonard St  
Ashland, OR 97520

**Lab Order:** 23101132  
**Received Date:** 10/26/2023 3:27:00 PM  
**Reported Date:** 11/9/2023 11:46:10 AM

Sample Information:

**Lab ID:** 23101132-31 **Client Sample ID:** 23-120G.CE32  
**Collection Date:** 10/26/2023 5:27:00 AM **Collected By:** Michael Newman  
**Matrix:** Drinking Water **Sample Location:** Hall DF at Room 9

Trace Metals by EPA 200.8 ICP-MS							Analyst: CJS	
Analyses	Result	Qual	MRL	Units	DF	Date Analyzed	MCL	NELAP Status
Lead	ND		0.515	ppb	1	11/6/2023	15.0	A

**Lab ID:** 23101132-32 **Client Sample ID:** 23-120G.CE33  
**Collection Date:** 10/26/2023 5:27:00 AM **Collected By:** Michael Newman  
**Matrix:** Drinking Water **Sample Location:** Hall DF at Rm 9 Bottle Filler

Trace Metals by EPA 200.8 ICP-MS							Analyst: CJS	
Analyses	Result	Qual	MRL	Units	DF	Date Analyzed	MCL	NELAP Status
Lead	ND		0.515	ppb	1	11/6/2023	15.0	A

**Lab ID:** 23101132-33 **Client Sample ID:** 23-120G.CE34  
**Collection Date:** 10/26/2023 5:29:00 AM **Collected By:** Michael Newman  
**Matrix:** Drinking Water **Sample Location:** Room 9 Sink

Trace Metals by EPA 200.8 ICP-MS							Analyst: CJS	
Analyses	Result	Qual	MRL	Units	DF	Date Analyzed	MCL	NELAP Status
Lead	ND		0.515	ppb	1	11/6/2023	15.0	A

QUALIFIERS	*	Value exceeds Maximum Contaminant Level.	C1	Sample container temperature is out of limit as specified at testcode
	E	Value above quantitation range	H	Holding times for preparation or analysis exceeded
	J	Analyte detected below quantitation limits	MI	Recovery outside control limits due to Matrix Interference
	ND	Not Detected at the Reporting Limit	PL	Permit Limit
	PRE	Percent RE exceeds the Limit	R	RPD outside accepted recovery limits

NELAP A Accredited in accordance with NELAP ORELAP 100016, OR-028

Original



Neilson Research Corporation  
245 S Grape St  
Medford, OR 97501  
TEL: (541) 770-5678 FAX: (541) 770-2901  
Website: www.nrclabs.com

## Analytical Report

WO#: 23101132

Date Reported: 11/9/2023

Coleman Creek Consulting  
810 Leonard St  
Ashland, OR 97520

**Lab Order:** 23101132  
**Received Date:** 10/26/2023 3:27:00 PM  
**Reported Date:** 11/9/2023 11:46:10 AM

Sample Information:

**Lab ID:** 23101132-34 **Client Sample ID:** 23-120G.CE35  
**Collection Date:** 10/26/2023 5:29:00 AM **Collected By:** Michael Newman  
**Matrix:** Drinking Water **Sample Location:** Room 9 Fountain

Trace Metals by EPA 200.8 ICP-MS							Analyst: CJS	
Analyses	Result	Qual	MRL	Units	DF	Date Analyzed	MCL	NELAP Status
Lead	ND		0.515	ppb	1	11/6/2023	15.0	A

**Lab ID:** 23101132-35 **Client Sample ID:** 23-120G.CE36  
**Collection Date:** 10/26/2023 5:30:00 AM **Collected By:** Michael Newman  
**Matrix:** Drinking Water **Sample Location:** Room 10 Sink

Trace Metals by EPA 200.8 ICP-MS							Analyst: CJS	
Analyses	Result	Qual	MRL	Units	DF	Date Analyzed	MCL	NELAP Status
Lead	ND		0.515	ppb	1	11/6/2023	15.0	A

**Lab ID:** 23101132-36 **Client Sample ID:** 23-120G.CE37  
**Collection Date:** 10/26/2023 5:30:00 AM **Collected By:** Michael Newman  
**Matrix:** Drinking Water **Sample Location:** Room 10 Fountain

Trace Metals by EPA 200.8 ICP-MS							Analyst: CJS	
Analyses	Result	Qual	MRL	Units	DF	Date Analyzed	MCL	NELAP Status
Lead	ND		0.515	ppb	1	11/6/2023	15.0	A

QUALIFIERS	*	Value exceeds Maximum Contaminant Level.	C1	Sample container temperature is out of limit as specified at testcode
	E	Value above quantitation range	H	Holding times for preparation or analysis exceeded
	J	Analyte detected below quantitation limits	MI	Recovery outside control limits due to Matrix Interference
	ND	Not Detected at the Reporting Limit	PL	Permit Limit
	PRE	Percent RE exceeds the Limit	R	RPD outside accepted recovery limits

**NELAP** A Accredited in accordance with NELAP ORELAP 100016, OR-028

Original





Neilson Research Corporation  
245 S Grape St  
Medford, OR 97501  
TEL: (541) 770-5678 FAX: (541) 770-2901  
Website: www.nrclabs.com

## Analytical Report

WO#: 23101132

Date Reported: 11/9/2023

Coleman Creek Consulting  
810 Leonard St  
Ashland, OR 97520

**Lab Order:** 23101132  
**Received Date:** 10/26/2023 3:27:00 PM  
**Reported Date:** 11/9/2023 11:46:10 AM

Sample Information:

**Lab ID:** 23101132-37 **Client Sample ID:** 23-120G.CE38  
**Collection Date:** 10/26/2023 5:32:00 AM **Collected By:** Michael Newman  
**Matrix:** Drinking Water **Sample Location:** Room 5 Sink

Trace Metals by EPA 200.8 ICP-MS							Analyst: CJS	
Analyses	Result	Qual	MRL	Units	DF	Date Analyzed	MCL	NELAP Status
Lead	ND		0.515	ppb	1	11/6/2023	15.0	A

**Lab ID:** 23101132-38 **Client Sample ID:** 23-120G.CE39  
**Collection Date:** 10/26/2023 5:32:00 AM **Collected By:** Michael Newman  
**Matrix:** Drinking Water **Sample Location:** Room 5 Fountain

Trace Metals by EPA 200.8 ICP-MS							Analyst: CJS	
Analyses	Result	Qual	MRL	Units	DF	Date Analyzed	MCL	NELAP Status
Lead	ND		0.515	ppb	1	11/6/2023	15.0	A

**Lab ID:** 23101132-39 **Client Sample ID:** 23-120G.CE40  
**Collection Date:** 10/26/2023 5:33:00 AM **Collected By:** Michael Newman  
**Matrix:** Drinking Water **Sample Location:** Room 6 Sink

Trace Metals by EPA 200.8 ICP-MS							Analyst: CJS	
Analyses	Result	Qual	MRL	Units	DF	Date Analyzed	MCL	NELAP Status
Lead	0.605		0.515	ppb	1	11/6/2023	15.0	A

QUALIFIERS	*	Value exceeds Maximum Contaminant Level.	C1	Sample container temperature is out of limit as specified at testcode
	E	Value above quantitation range	H	Holding times for preparation or analysis exceeded
	J	Analyte detected below quantitation limits	MI	Recovery outside control limits due to Matrix Interference
	ND	Not Detected at the Reporting Limit	PL	Permit Limit
	PRE	Percent RE exceeds the Limit	R	RPD outside accepted recovery limits

NELAP A Accredited in accordance with NELAP ORELAP 100016, OR-028

Original



Neilson Research Corporation  
245 S Grape St  
Medford, OR 97501  
TEL: (541) 770-5678 FAX: (541) 770-2901  
Website: www.nrclabs.com

## Analytical Report

WO#: 23101132

Date Reported: 11/9/2023

Coleman Creek Consulting  
810 Leonard St  
Ashland, OR 97520

**Lab Order:** 23101132  
**Received Date:** 10/26/2023 3:27:00 PM  
**Reported Date:** 11/9/2023 11:46:10 AM

Sample Information:

**Lab ID:** 23101132-40 **Client Sample ID:** 23-120G.CE41  
**Collection Date:** 10/26/2023 5:33:00 AM **Collected By:** Michael Newman  
**Matrix:** Drinking Water **Sample Location:** Room 6 Fountain

Trace Metals by EPA 200.8 ICP-MS							Analyst: CJS	
Analyses	Result	Qual	MRL	Units	DF	Date Analyzed	MCL	NELAP Status
Lead	0.686		0.515	ppb	1	11/6/2023	15.0	A

**Lab ID:** 23101132-41 **Client Sample ID:** 23-120G.CE42  
**Collection Date:** 10/26/2023 5:34:00 AM **Collected By:** Michael Newman  
**Matrix:** Drinking Water **Sample Location:** Room 2 Sink

Trace Metals by EPA 200.8 ICP-MS							Analyst: CJS	
Analyses	Result	Qual	MRL	Units	DF	Date Analyzed	MCL	NELAP Status
Lead	0.924		0.515	ppb	1	11/6/2023	15.0	A

**Lab ID:** 23101132-42 **Client Sample ID:** 23-120G.CE43  
**Collection Date:** 10/26/2023 5:34:00 AM **Collected By:** Michael Newman  
**Matrix:** Drinking Water **Sample Location:** Room 2 Fountain

Trace Metals by EPA 200.8 ICP-MS							Analyst: CJS	
Analyses	Result	Qual	MRL	Units	DF	Date Analyzed	MCL	NELAP Status
Lead	0.560		0.515	ppb	1	11/6/2023	15.0	A

QUALIFIERS	*	Value exceeds Maximum Contaminant Level.	C1	Sample container temperature is out of limit as specified at testcode
	E	Value above quantitation range	H	Holding times for preparation or analysis exceeded
	J	Analyte detected below quantitation limits	MI	Recovery outside control limits due to Matrix Interference
	ND	Not Detected at the Reporting Limit	PL	Permit Limit
	PRE	Percent RE exceeds the Limit	R	RPD outside accepted recovery limits

NELAP A Accredited in accordance with NELAP ORELAP 100016, OR-028

Original



Neilson Research Corporation  
245 S Grape St  
Medford, OR 97501  
TEL: (541) 770-5678 FAX: (541) 770-2901  
Website: www.nrclabs.com

## Analytical Report

WO#: 23101132

Date Reported: 11/9/2023

Coleman Creek Consulting  
810 Leonard St  
Ashland, OR 97520

**Lab Order:** 23101132  
**Received Date:** 10/26/2023 3:27:00 PM  
**Reported Date:** 11/9/2023 11:46:10 AM

Sample Information:

**Lab ID:** 23101132-43 **Client Sample ID:** 23-120G.CE44  
**Collection Date:** 10/26/2023 5:36:00 AM **Collected By:** Michael Newman  
**Matrix:** Drinking Water **Sample Location:** Room 1 Sink

Trace Metals by EPA 200.8 ICP-MS							Analyst: CJS	
Analyses	Result	Qual	MRL	Units	DF	Date Analyzed	MCL	NELAP Status
Lead	ND		0.515	ppb	1	11/6/2023	15.0	A

**Lab ID:** 23101132-44 **Client Sample ID:** 23-120G.CE45  
**Collection Date:** 10/26/2023 5:36:00 AM **Collected By:** Michael Newman  
**Matrix:** Drinking Water **Sample Location:** Room 1 Fountain

Trace Metals by EPA 200.8 ICP-MS							Analyst: CJS	
Analyses	Result	Qual	MRL	Units	DF	Date Analyzed	MCL	NELAP Status
Lead	ND		0.515	ppb	1	11/6/2023	15.0	A

**Lab ID:** 23101132-45 **Client Sample ID:** 23-120G.CE46  
**Collection Date:** 10/26/2023 5:38:00 AM **Collected By:** Michael Newman  
**Matrix:** Drinking Water **Sample Location:** Girl's RR at Rm 1 L Sink

Trace Metals by EPA 200.8 ICP-MS							Analyst: CJS	
Analyses	Result	Qual	MRL	Units	DF	Date Analyzed	MCL	NELAP Status
Lead	ND		0.515	ppb	1	11/6/2023	15.0	A

QUALIFIERS	*	Value exceeds Maximum Contaminant Level.	C1	Sample container temperature is out of limit as specified at testcode
	E	Value above quantitation range	H	Holding times for preparation or analysis exceeded
	J	Analyte detected below quantitation limits	MI	Recovery outside control limits due to Matrix Interference
	ND	Not Detected at the Reporting Limit	PL	Permit Limit
	PRE	Percent RE exceeds the Limit	R	RPD outside accepted recovery limits

**NELAP** A Accredited in accordance with NELAP ORELAP 100016, OR-028

Original



Neilson Research Corporation  
245 S Grape St  
Medford, OR 97501  
TEL: (541) 770-5678 FAX: (541) 770-2901  
Website: www.nrclabs.com

## Analytical Report

WO#: 23101132

Date Reported: 11/9/2023

Coleman Creek Consulting  
810 Leonard St  
Ashland, OR 97520

**Lab Order:** 23101132  
**Received Date:** 10/26/2023 3:27:00 PM  
**Reported Date:** 11/9/2023 11:46:10 AM

Sample Information:

**Lab ID:** 23101132-46 **Client Sample ID:** 23-120G.CE47  
**Collection Date:** 10/26/2023 5:38:00 AM **Collected By:** Michael Newman  
**Matrix:** Drinking Water **Sample Location:** Girl's RR at Rm 1 R Sink

Trace Metals by EPA 200.8 ICP-MS								Analyst:	CJS
Analyses	Result	Qual	MRL	Units	DF	Date Analyzed	MCL	NELAP Status	
Lead	ND		0.515	ppb	1	11/6/2023	15.0	A	

**Lab ID:** 23101132-47 **Client Sample ID:** 23-120G.CE48  
**Collection Date:** 10/26/2023 5:43:00 AM **Collected By:** Michael Newman  
**Matrix:** Drinking Water **Sample Location:** Boy's RR at Rm 2 L Sink

Trace Metals by EPA 200.8 ICP-MS								Analyst:	CJS
Analyses	Result	Qual	MRL	Units	DF	Date Analyzed	MCL	NELAP Status	
Lead	ND		0.515	ppb	1	11/6/2023	15.0	A	

**Lab ID:** 23101132-48 **Client Sample ID:** 23-120G.CE49  
**Collection Date:** 10/26/2023 5:43:00 AM **Collected By:** Michael Newman  
**Matrix:** Drinking Water **Sample Location:** Boy's RR at Rm 2 R Sink

Trace Metals by EPA 200.8 ICP-MS								Analyst:	CJS
Analyses	Result	Qual	MRL	Units	DF	Date Analyzed	MCL	NELAP Status	
Lead	ND		0.515	ppb	1	11/6/2023	15.0	A	

QUALIFIERS	*	Value exceeds Maximum Contaminant Level.	C1	Sample container temperature is out of limit as specified at testcode
	E	Value above quantitation range	H	Holding times for preparation or analysis exceeded
	J	Analyte detected below quantitation limits	MI	Recovery outside control limits due to Matrix Interference
	ND	Not Detected at the Reporting Limit	PL	Permit Limit
	PRE	Percent RE exceeds the Limit	R	RPD outside accepted recovery limits

**NELAP** A Accredited in accordance with NELAP ORELAP 100016, OR-028

Original



Neilson Research Corporation  
245 S Grape St  
Medford, OR 97501  
TEL: (541) 770-5678 FAX: (541) 770-2901  
Website: www.nrclabs.com

## Analytical Report

WO#: 23101132

Date Reported: 11/9/2023

Coleman Creek Consulting  
810 Leonard St  
Ashland, OR 97520

**Lab Order:** 23101132  
**Received Date:** 10/26/2023 3:27:00 PM  
**Reported Date:** 11/9/2023 11:46:10 AM

Sample Information:

**Lab ID:** 23101132-49 **Client Sample ID:** 23-120G.CE50  
**Collection Date:** 10/26/2023 5:44:00 AM **Collected By:** Michael Newman  
**Matrix:** Drinking Water **Sample Location:** Room 3 Sink

Trace Metals by EPA 200.8 ICP-MS							Analyst: CJS	
Analyses	Result	Qual	MRL	Units	DF	Date Analyzed	MCL	NELAP Status
Lead	ND		0.515	ppb	1	11/6/2023	15.0	A

**Lab ID:** 23101132-50 **Client Sample ID:** 23-120G.CE51  
**Collection Date:** 10/26/2023 5:44:00 AM **Collected By:** Michael Newman  
**Matrix:** Drinking Water **Sample Location:** Room 3 Fountain

Trace Metals by EPA 200.8 ICP-MS							Analyst: CJS	
Analyses	Result	Qual	MRL	Units	DF	Date Analyzed	MCL	NELAP Status
Lead	ND		0.515	ppb	1	11/6/2023	15.0	A

**Lab ID:** 23101132-51 **Client Sample ID:** 23-120G.CE52  
**Collection Date:** 10/26/2023 5:45:00 AM **Collected By:** Michael Newman  
**Matrix:** Drinking Water **Sample Location:** Room 4 Sink

Trace Metals by EPA 200.8 ICP-MS							Analyst: CJS	
Analyses	Result	Qual	MRL	Units	DF	Date Analyzed	MCL	NELAP Status
Lead	ND		0.515	ppb	1	11/6/2023	15.0	A

QUALIFIERS	*	Value exceeds Maximum Contaminant Level.	C1	Sample container temperature is out of limit as specified at testcode
	E	Value above quantitation range	H	Holding times for preparation or analysis exceeded
	J	Analyte detected below quantitation limits	MI	Recovery outside control limits due to Matrix Interference
	ND	Not Detected at the Reporting Limit	PL	Permit Limit
	PRE	Percent RE exceeds the Limit	R	RPD outside accepted recovery limits

NELAP A Accredited in accordance with NELAP ORELAP 100016, OR-028

Original



Neilson Research Corporation  
245 S Grape St  
Medford, OR 97501  
TEL: (541) 770-5678 FAX: (541) 770-2901  
Website: www.nrclabs.com

## Analytical Report

WO#: 23101132

Date Reported: 11/9/2023

Coleman Creek Consulting  
810 Leonard St  
Ashland, OR 97520

**Lab Order:** 23101132  
**Received Date:** 10/26/2023 3:27:00 PM  
**Reported Date:** 11/9/2023 11:46:10 AM

Sample Information:

**Lab ID:** 23101132-52      **Client Sample ID:** 23-120G.CE53  
**Collection Date:** 10/26/2023 5:45:00 AM      **Collected By:** Michael Newman  
**Matrix:** Drinking Water      **Sample Location:** Room 4 Fountain

Trace Metals by EPA 200.8 ICP-MS						Analyst: CJS		
Analyses	Result	Qual	MRL	Units	DF	Date Analyzed	MCL	NELAP Status
Lead	ND		0.515	ppb	1	11/6/2023	15.0	A

QUALIFIERS	*	Value exceeds Maximum Contaminant Level.	C1	Sample container temperature is out of limit as specified at testcode
	E	Value above quantitation range	H	Holding times for preparation or analysis exceeded
	J	Analyte detected below quantitation limits	MI	Recovery outside control limits due to Matrix Interference
	ND	Not Detected at the Reporting Limit	PL	Permit Limit
	PRE	Percent RE exceeds the Limit	R	RPD outside accepted recovery limits

NELAP A Accredited in accordance with NELAP ORELAP 100016, OR-028

Original



Neilson Research Corporation  
245 S Grape St  
Medford, OR 97501  
TEL: (541) 770-5678 FAX: (541) 770-2901  
Website: www.nrclabs.com

## QC SUMMARY REPORT

WO#: 23101132  
09-Nov-23

Client: Coleman Creek Consulting  
Project: 23-120G Chiloquin ES School Lead

TestCode: LEAD\_DW

Sample ID: <b>MB-23245</b>	SampType: <b>MBLK</b>	TestCode: <b>LEAD_DW</b>	Units: <b>ppb</b>	Prep Date: <b>11/3/2023</b>	RunNo: <b>43919</b>
Client ID: <b>PBW</b>	Batch ID: <b>23245</b>	TestNo: <b>E200.8</b>	<b>E200.8</b>	Analysis Date: <b>11/6/2023</b>	SeqNo: <b>732558</b>
Analyte	Result	PQL	SPK value	SPK Ref Val	%REC LowLimit HighLimit RPD Ref Val %RPD RPDLimit Qual
Lead	ND	0.515			

Sample ID: <b>LCS-23245</b>	SampType: <b>LCS</b>	TestCode: <b>LEAD_DW</b>	Units: <b>ppb</b>	Prep Date: <b>11/3/2023</b>	RunNo: <b>43919</b>
Client ID: <b>LCSW</b>	Batch ID: <b>23245</b>	TestNo: <b>E200.8</b>	<b>E200.8</b>	Analysis Date: <b>11/6/2023</b>	SeqNo: <b>732559</b>
Analyte	Result	PQL	SPK value	SPK Ref Val	%REC LowLimit HighLimit RPD Ref Val %RPD RPDLimit Qual
Lead	99.4	0.520	100	0	99.4 85 115

Sample ID: <b>23101132-01AMS</b>	SampType: <b>MS</b>	TestCode: <b>LEAD_DW</b>	Units: <b>ppb</b>	Prep Date: <b>11/3/2023</b>	RunNo: <b>43919</b>
Client ID: <b>23-120G.CE1</b>	Batch ID: <b>23245</b>	TestNo: <b>E200.8</b>	<b>E200.8</b>	Analysis Date: <b>11/6/2023</b>	SeqNo: <b>732561</b>
Analyte	Result	PQL	SPK value	SPK Ref Val	%REC LowLimit HighLimit RPD Ref Val %RPD RPDLimit Qual
Lead	97.9	0.520	100	0.409	97.5 70 130

Sample ID: <b>23101132-01AMSD</b>	SampType: <b>MSD</b>	TestCode: <b>LEAD_DW</b>	Units: <b>ppb</b>	Prep Date: <b>11/3/2023</b>	RunNo: <b>43919</b>
Client ID: <b>23-120G.CE1</b>	Batch ID: <b>23245</b>	TestNo: <b>E200.8</b>	<b>E200.8</b>	Analysis Date: <b>11/6/2023</b>	SeqNo: <b>732562</b>
Analyte	Result	PQL	SPK value	SPK Ref Val	%REC LowLimit HighLimit RPD Ref Val %RPD RPDLimit Qual
Lead	99.7	0.520	100	0.409	99.3 70 130 97.9 1.83 20

Qualifiers: C1 Sample container temperature is out of limit as specified at testcode  
ND Not Detected at the Reporting Limit

H Holding times for preparation or analysis exceeded  
PL Permit Limit

MI Recovery outside control limits due to Matrix Int  
RL Reporting Detection Limit

Original



Neilson Research Corporation  
245 S Grape St  
Medford, OR 97501  
TEL: (541) 770-5678 FAX: (541) 770-2901  
Website: www.nrclabs.com

## QC SUMMARY REPORT

WO#: 23101132  
09-Nov-23

Client: Coleman Creek Consulting  
Project: 23-120G Chiloquin ES School Lead

TestCode: LEAD\_DW

Sample ID: <b>MB-23246</b>	SampType: <b>MBLK</b>	TestCode: <b>LEAD_DW</b>	Units: <b>ppb</b>	Prep Date: <b>11/3/2023</b>	RunNo: <b>43919</b>
Client ID: <b>PBW</b>	Batch ID: <b>23246</b>	TestNo: <b>E200.8</b>	<b>E200.8</b>	Analysis Date: <b>11/6/2023</b>	SeqNo: <b>732586</b>
Analyte	Result	PQL	SPK value	SPK Ref Val	%REC LowLimit HighLimit RPD Ref Val %RPD RPDLimit Qual

Lead	ND	0.515			
------	----	-------	--	--	--

Sample ID: <b>LCS-23246</b>	SampType: <b>LCS</b>	TestCode: <b>LEAD_DW</b>	Units: <b>ppb</b>	Prep Date: <b>11/3/2023</b>	RunNo: <b>43919</b>
Client ID: <b>LCSW</b>	Batch ID: <b>23246</b>	TestNo: <b>E200.8</b>	<b>E200.8</b>	Analysis Date: <b>11/6/2023</b>	SeqNo: <b>732587</b>
Analyte	Result	PQL	SPK value	SPK Ref Val	%REC LowLimit HighLimit RPD Ref Val %RPD RPDLimit Qual

Lead	99.2	0.520	100	0	99.2 85 115
------	------	-------	-----	---	-------------

Sample ID: <b>23101132-21AMS</b>	SampType: <b>MS</b>	TestCode: <b>LEAD_DW</b>	Units: <b>ppb</b>	Prep Date: <b>11/3/2023</b>	RunNo: <b>43919</b>
Client ID: <b>23-120G.CE21</b>	Batch ID: <b>23246</b>	TestNo: <b>E200.8</b>	<b>E200.8</b>	Analysis Date: <b>11/6/2023</b>	SeqNo: <b>732589</b>
Analyte	Result	PQL	SPK value	SPK Ref Val	%REC LowLimit HighLimit RPD Ref Val %RPD RPDLimit Qual

Lead	99.4	0.520	100	0.353	99.0 70 130
------	------	-------	-----	-------	-------------

Sample ID: <b>23101132-21AMSD</b>	SampType: <b>MSD</b>	TestCode: <b>LEAD_DW</b>	Units: <b>ppb</b>	Prep Date: <b>11/3/2023</b>	RunNo: <b>43919</b>
Client ID: <b>23-120G.CE21</b>	Batch ID: <b>23246</b>	TestNo: <b>E200.8</b>	<b>E200.8</b>	Analysis Date: <b>11/6/2023</b>	SeqNo: <b>732590</b>
Analyte	Result	PQL	SPK value	SPK Ref Val	%REC LowLimit HighLimit RPD Ref Val %RPD RPDLimit Qual

Lead	97.6	0.520	100	0.353	97.3 70 130 99.4 1.76 20
------	------	-------	-----	-------	--------------------------

Qualifiers: C1 Sample container temperature is out of limit as specified at testcode H Holding times for preparation or analysis exceeded MI Recovery outside control limits due to Matrix Int  
ND Not Detected at the Reporting Limit PL Permit Limit RL Reporting Detection Limit

Original





Neilson Research Corporation  
245 S Grape St  
Medford, OR 97501  
TEL: (541) 770-5678 FAX: (541) 770-2901  
Website: www.nrclabs.com

## QC SUMMARY REPORT

WO#: 23101132  
09-Nov-23

**Client:** Coleman Creek Consulting  
**Project:** 23-120G Chiloquin ES School Lead

**TestCode:** LEAD\_DW

Sample ID: <b>MB-23247</b>	SampType: <b>MBLK</b>	TestCode: <b>LEAD_DW</b>	Units: <b>ppb</b>	Prep Date: <b>11/3/2023</b>	RunNo: <b>43919</b>
Client ID: <b>PBW</b>	Batch ID: <b>23247</b>	TestNo: <b>E200.8</b>	<b>E200.8</b>	Analysis Date: <b>11/6/2023</b>	SeqNo: <b>732614</b>
Analyte	Result	PQL	SPK value	SPK Ref Val	%REC LowLimit HighLimit RPD Ref Val %RPD RPDLimit Qual

Lead ND 0.515

Sample ID: <b>LCS-23247</b>	SampType: <b>LCS</b>	TestCode: <b>LEAD_DW</b>	Units: <b>ppb</b>	Prep Date: <b>11/3/2023</b>	RunNo: <b>43919</b>
Client ID: <b>LCSW</b>	Batch ID: <b>23247</b>	TestNo: <b>E200.8</b>	<b>E200.8</b>	Analysis Date: <b>11/6/2023</b>	SeqNo: <b>732615</b>
Analyte	Result	PQL	SPK value	SPK Ref Val	%REC LowLimit HighLimit RPD Ref Val %RPD RPDLimit Qual

Lead 104 0.520 100 0 104 85 115

Sample ID: <b>23101132-41AMS</b>	SampType: <b>MS</b>	TestCode: <b>LEAD_DW</b>	Units: <b>ppb</b>	Prep Date: <b>11/3/2023</b>	RunNo: <b>43919</b>
Client ID: <b>23-120G.CE42</b>	Batch ID: <b>23247</b>	TestNo: <b>E200.8</b>	<b>E200.8</b>	Analysis Date: <b>11/6/2023</b>	SeqNo: <b>732617</b>
Analyte	Result	PQL	SPK value	SPK Ref Val	%REC LowLimit HighLimit RPD Ref Val %RPD RPDLimit Qual

Lead 103 0.520 100 0.924 102 70 130

Sample ID: <b>23101132-41AMSD</b>	SampType: <b>MSD</b>	TestCode: <b>LEAD_DW</b>	Units: <b>ppb</b>	Prep Date: <b>11/3/2023</b>	RunNo: <b>43919</b>
Client ID: <b>23-120G.CE42</b>	Batch ID: <b>23247</b>	TestNo: <b>E200.8</b>	<b>E200.8</b>	Analysis Date: <b>11/6/2023</b>	SeqNo: <b>732618</b>
Analyte	Result	PQL	SPK value	SPK Ref Val	%REC LowLimit HighLimit RPD Ref Val %RPD RPDLimit Qual

Lead 104 0.520 100 0.924 103 70 130 103 0.784 20

**Qualifiers:** CI Sample container temperature is out of limit as specified at testcode H Holding times for preparation or analysis exceeded MI Recovery outside control limits due to Matrix Int  
ND Not Detected at the Reporting Limit PL Permit Limit RL Reporting Detection Limit

Original

## Sample Log-In Check List

Client Name: **ColemanCreek**

Work Order Number: **23101132**

RcptNo: **1**

Logged by: **Tamra Schmedemann** **10/26/2023 3:27:00 PM**

*Tamra Schmedemann*

Completed By: **Erin Hernandez** **10/27/2023 5:07:00 PM**

*Erin Hernandez*

Reviewed By: **Jordan Diemer** **11/8/2023 1:29:12 PM**

*Jordan Diemer*

### Chain of Custody

1. Is Chain of Custody complete? Yes ☒ No ☐ Not Present ☐  
2. How was the sample delivered? Client

### Log In

3. Coolers are present? Yes ☐ No ☐ NA ☒  
4. Shipping container/cooler in good condition? Yes ☒ No ☐  
Custody seals intact on shipping container/cooler? Yes ☐ No ☐ Not Present ☒  
No. Seal Date: Signed By:  
5. Was an attempt made to cool the samples? Yes ☐ No ☐ NA ☒  
6. Were all samples received at a temperature of >0° C to 6.0°C Yes ☐ No ☐ NA ☒  
7. Sample(s) in proper container(s)? Yes ☒ No ☐  
8. Sufficient sample volume for indicated test(s)? Yes ☒ No ☐  
9. Are samples (except VOA and ONG) properly preserved? Yes ☒ No ☐  
10. Was preservative added to bottles? Yes ☒ No ☐ NA ☐  
HNO3 pH<2  
11. Is the headspace in the VOA vials less than 1/4 inch or 6 mm? Yes ☐ No ☐ No VOA Vials ☒  
12. Were any sample containers received broken? Yes ☐ No ☒  
13. Does paperwork match bottle labels? Yes ☒ No ☐  
(Note discrepancies on chain of custody)  
14. Are matrices correctly identified on Chain of Custody? Yes ☒ No ☐  
15. Is it clear what analyses were requested? Yes ☒ No ☐  
16. Were all holding times able to be met? Yes ☒ No ☐  
(If no, notify customer for authorization.)

### Special Handling (if applicable)

17. Was client notified of all discrepancies with this order? Yes ☐ No ☐ NA ☒

Person Notified:  Date:   
By Whom:  Via: ☐ eMail ☐ Phone ☐ Fax ☐ In Person  
Regarding:   
Client Instructions:

18. Additional remarks:

### Cooler Information

Cooler No	Temp °C	Condition	Seal Intact	Seal No	Seal Date	Signed By
-----------	---------	-----------	-------------	---------	-----------	-----------

# Chain of Custody Record

This Chain of Custody is a LEGAL DOCUMENT and must be filled out accurately.

Page 1 of 1

## Section A

### Required Client Information

Company:	Coleman Creek Consulting
Address:	810 Leonard St Ashland, OR 97520
Email:	<a href="mailto:fawbro@ccountry.net">fawbro@ccountry.net</a>
Phone:	Fax:
Collected By (Print):	Michael Newman
Collected By (Sign):	<i>[Signature]</i>
Email Report <input type="checkbox"/>	Mail Report <input type="checkbox"/> Fax Report <input type="checkbox"/>

## Section B

### Required Project Information

Project Name:	Chilloguin ES
Project Number:	23-1206
Report To:	Dave Fawcett
Copy To:	

## Section C

### Invoice Information

Attention:	
Company Name:	
Address:	
P.O. #	

## Section D

### Rush Status (Subject to Scheduling)

<input checked="" type="checkbox"/> Standard: 10 Business Days
<input type="checkbox"/> Priority: 5 Business Days (List x 1.50)
<input type="checkbox"/> Express: 3 Business Days (List x 1.75)
<input type="checkbox"/> Rush: 2 Business Days (List x 2.00)
<input type="checkbox"/> Rush: 1 Business Day (List x 2.50)
<input type="checkbox"/> Rush: Same Day (List x 3.00)
Authorized <input type="checkbox"/> Yes <input type="checkbox"/> No

## Section E

### Sample Information

Sample ID	Comp/Grab	Matrix*	Date Collected	Time Collected	No. of Containers	Analysis Requested										NRC Workorder # (Lab Use Only)	Remarks / Field Data	NRC Sample # (Lab Use Only)	(Lab)
23-1206-CE1-23	Grab	DW	10-26-23		23														
23-1206-CE25-53	Grab	DW	"		29														

\*Matrix: DW - Drinking Water WW - Wastewater W - Water S - Soil/Solid SL - Sludge O - Oil WP - Wipe OT - Other

## Section F

### Relinquish/Receive

Relinquished By:	Sign	Print	Date	Time
Relinquished By:	<i>[Signature]</i>	David W. Fawcett	10-26-23	15:27
Received By:				
Relinquished By:				
Received By:				
Relinquished By:				
Received By Laboratory:	Jamie Schmiedem	Jamie Schmiedem	10-26-23	15:27

## Section G

### Lab Use Only

Temp: <i>AmB</i>	IR Therm ID:
≤6°C: <input checked="" type="checkbox"/> Yes <input type="checkbox"/> No	
Received on Ice: <input checked="" type="checkbox"/> Yes <input type="checkbox"/> No	
Number of Bottles Received: <i>52</i>	
pH Checked: <i>n/a</i>	
COC Seals Intact: <input type="checkbox"/> Yes <input checked="" type="checkbox"/> No <input checked="" type="checkbox"/> NA	
Field Blank Included: <input checked="" type="checkbox"/> Yes <input type="checkbox"/> No	

Received Via ☐ UPS ☐ FedEx ☐ Other ☒ Hand

Payment: ☒ Invoice ☐ Cash ☐ VISA, M/C ☐ Check # ☐ Amount ☐